

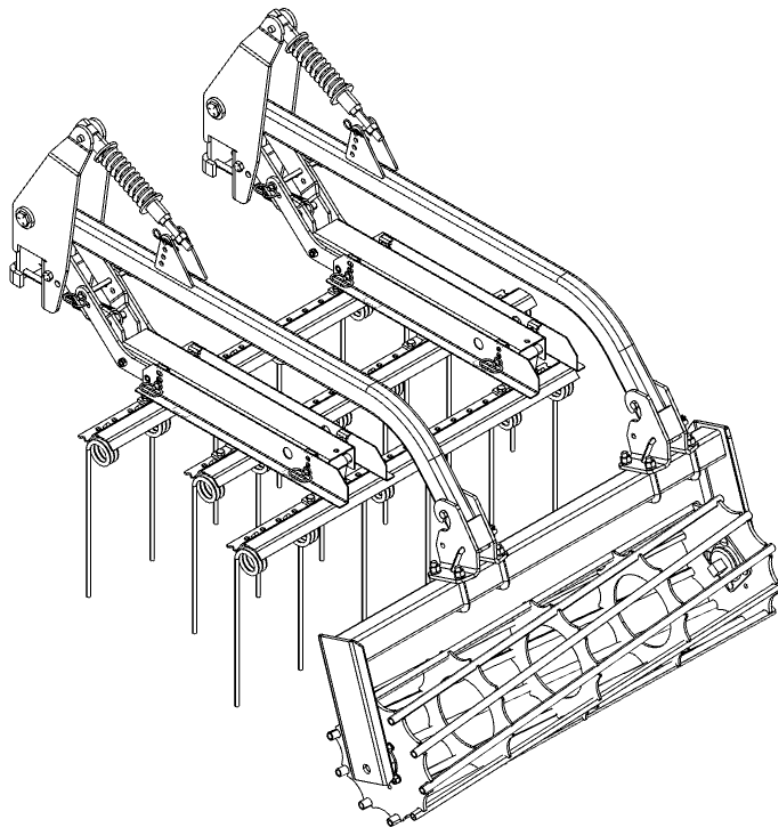

# WIL-RICH®

## ASSEMBLY MANUAL



### **3-BAR COIL TINE HARROW WITH BASKET (INCLUDES HYDRAULIC OPTION)**



# COIL TINE HARROW WITH HYDRAULIC BASKET

## 1. Introduction

Introduction .....	5
--------------------	---

## 2. Harrow Basket Assembly

Harrow Basket Assembly .....	8
------------------------------	---

## 3. Harrow Layouts

11 XL2 Harrow Bracket Bolt Hole Locations.....	10
11 XL2 19-20' Coil Tine Harrow with Basket Layout.....	11
11 XL2 25' Coil Tine Harrow with Basket Layout.....	12
11 XL2 25-27' Coil Tine Harrow with Basket Layout.....	13
11 XL2 30-32' Coil Tine Harrow with Basket Layout.....	14
11 XL2 30-39' Coil Tine Harrow with Basket Layout.....	15
13 XL2/QX2 32' Coil Tine Harrow with Basket Layout.....	16
13 XL2/QX2 32-42' Coil Tine Harrow with Basket Layout .....	17
13 XL2/QX2 32-45' Coil Tine Harrow with Basket Layout .....	18
13 XL2/QX2 37' Coil Tine Harrow with Basket Layout.....	19
13 XL2/QX2 37-50' Coil Tine Harrow with Basket Layout .....	20
13 XL2/QX2 46-50' Coil Tine Harrow with Basket Layout .....	21
13 XL2/QX2 55' Coil Tine Harrow with Basket Layout.....	22
13 XL2/QX2 55-60' Coil Tine Harrow with Basket Layout .....	23

## 4. Hydraulic Lift Kit Assembly

Hydraulic Lift Kit Assembly .....	24
-----------------------------------	----

## 5. Hydraulic Layout

13 XL2/QX2 32' Basket Hydraulics .....	26
13 XL2/QX2 32-42' Basket Hydraulics .....	28
13 XL2/QX2 32-45' Basket Hydraulics .....	30
13 XL2/QX2 37' Basket Hydraulic .....	32
13 XL2/QX2 37-50' Basket Hydraulics .....	34
13 XL2/QX2 45-50' Basket Hydraulics .....	36
13 XL2/QX2 55' Basket Hydraulics .....	38
13 XL2/QX2 55-60' Basket Hydraulics .....	40





## Introduction - 3-Bar Coil Tine Harrow with Basket Assembly Instructions

These instructions apply to the following models.

Model	Serial number
3-Bar Coil Tine Harrow with Basket	All

Your model number may not be listed if these instructions were published before your machine was manufactured.

### Shipping damage and missing parts

Inspect the machine and parts carefully for possible damage that occurred during shipping. Contact the shipping company immediately if damage is found..

### Illustrations

The illustrations used will not always be identical to your specific model or configuration. However, the procedure shown is the same unless otherwise noted.

### Direction references

Right and left, as used in these installation instructions, are determined by facing the direction the machine will travel when in use.

### Bolt torques

Always replace hardware with the same grade or class. Tighten all hardware according to torque values listed in the machine service manual unless otherwise specified in these instructions.

BOLT SIZE	WRENCH SIZE	GRADE 5		GRADE 8	
		lb-ft	N•m	lb-ft	N•m
1/4 in.	7/16 in. or 3/8 in.	7	9.5	12	17
5/16 in.	1/2 in.	15	20	25	34
3/8 in.	9/16 in.	30	41	45	61
7/16 in.	5/8 in. or 11/16 in.	45	61	70	95
1/2 in.	3/4 in.	70	95	105	142
9/16 in. wheel bolts	7/8 in.	170	231	-	-
5/8 in.	15/16 in.	170	231	210	285
5/8 in. wheel nuts	1-1/16 in.	240	325	-	-
3/4 in.	1-1/16 in.* or 1-1/8 in.*	250	339	375	509
7/8 in.	1-5/16 in.	350	475	600	814
1 in.	1-1/2 in.	450	610	880	1193
1-1/4 in.	1-7/8 in.	500	678	-	-
1-1/2 in.	2-3/4 in.	570	773	-	-
2 in.	3-1/8 in.	1200	1627	-	-

## Important safety information



This is the safety alert symbol. It means ATTENTION! BECOME ALERT! YOUR SAFETY IS INVOLVED! It will direct your attention to information that concerns your safety.

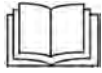

Read and understand all safety information in the machine operator's manual before continuing with these instructions.

Most personal injuries are the result of failure to observe basic safety rules and precautions. In most cases, an injury can be avoided by recognizing hazardous situations before an injury occurs and taking appropriate action to remove or avoid the hazard.

The person installing this kit must have the necessary training, skills, and tools.



### **WARNING:**

**To avoid personal injury and/or machine damage, do the following before starting to install this kit:**

- Use personal safety equipment appropriate to the task such as:
  - Protective eye wear
  - Gloves
  - Steel-toed shoes
  - Hearing protection
- Park the machine on a solid level surface.
- Disengage the power take-off (PTO), if equipped.
- Put the transmission in the parking position and apply the park brake.
- Turn off the control console.
- Stop the engine and take the key with you.
- Look and Listen! Make sure all moving parts have stopped.
- Put blocks in front of and behind the machine wheels before working on or under the machine.
- Remove or relieve all sources of stored energy such as:
  - Disconnect the battery
  - Relieve hydraulic or fuel pressure
  - Relieve air pressure
  - Relieve or block mechanical spring pressure
  - Properly block or lock pivoting joints
- Clean oil, dirt, and crop material from the area on the machine where the work is to be done.

## Prepare for assembly

**WARNING:**

**Components can be heavy. Severe injury can result from improper lifting technique. Use appropriate lifting equipment for heavy components.**

Read this section carefully before assembly. Refer to the Parts Catalog for additional component illustrations while assembling the machine.

Part numbers are shown on labels on the parts.

Hardware numbers are shown on labels on the hardware or on the container the hardware is in.

Carefully remove all the parts and hardware included. Make sure nothing was damaged or missing.

Tighten all hardware according to standard torque values unless specified in these instructions. See the torque charts in this publication for more information.

Always replace hardware with the same grade or class.

Use all the nuts and bolts in the correct locations. This will prevent damage to the machine.

**IMPORTANT:** *When two or more bolts are being used on a part, always insert the bolts and loosely tighten the nuts. Once the correct location has been reached, tighten the nuts evenly to prevent misalignment or distortion of the parts. Tighten all U-bolt nuts evenly and to the same torque to prevent misalignment or distortion.*

Select a large, flat, and hard surface for assembly of machine.

**IMPORTANT:** *Keep all parts in the assigned containers until the parts are to be used.*

**NOTE:** *Some items will be assembled at the factory.*

Right-hand and left-hand, as used in this manual, are determined by facing the direction the machine will travel when in use.

---

## Service parts

The illustrations and part numbers in this publication are supplied for component identification only when assembling the machine. When ordering replacement parts, always use the part numbers from the parts catalog.

For a complete list of available service parts, go to [www.wil-rich.com](http://www.wil-rich.com) or contact your dealer.

### 1. Installing the Harrow Basket Assembly:

Determine the correct position of the harrow arm on the rear tube of the frame. See pages 10 through 17 for layout information.

Install the mount (1) of the harrow arm over the rear tube of the frame (2).

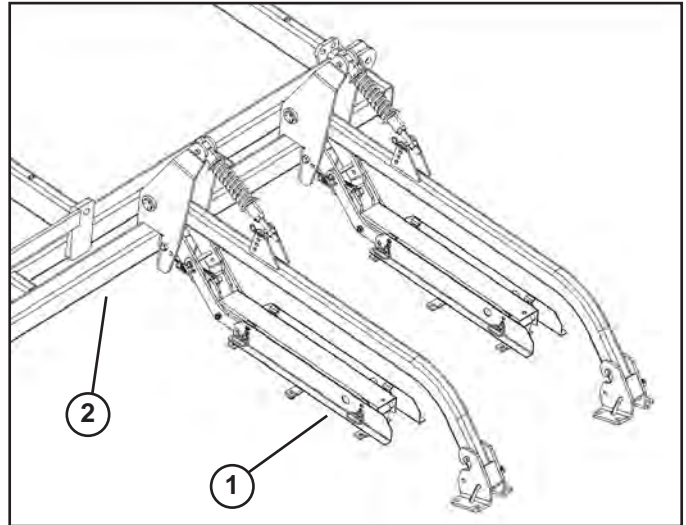

2. Attach the mount arm assemblies to the frame of the implement using the harrow lock plate (1) and supplied 5/8" x 5-1/2" bolts (2), lock washers, and nuts to install the harrow mount to the frame.

**NOTE:** The bolt holes in the harrow lock plate are offset. Orientate the harrow lock plate so the bolt holes are offset towards the top of the harrow arm.

**NOTE:** Exact arm location could vary either direction, dependent on implement accessories and options. Do not tighten arms completely until all sections are in place.

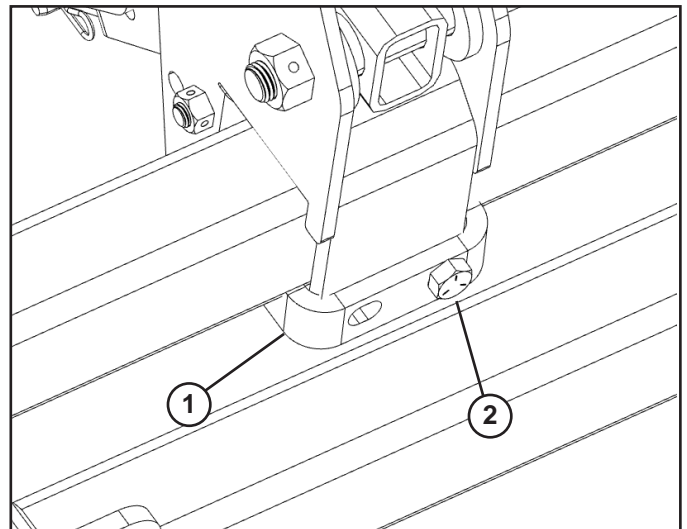

3. Install the harrow section bars.

Select a harrow bar section of the correct width for the harrow section you are working on. Refer to pages 10 through 17 for correct harrow section widths.

**NOTE:** The harrow arms must be in the correct position and loosely installed before the harrow section bars can be installed.

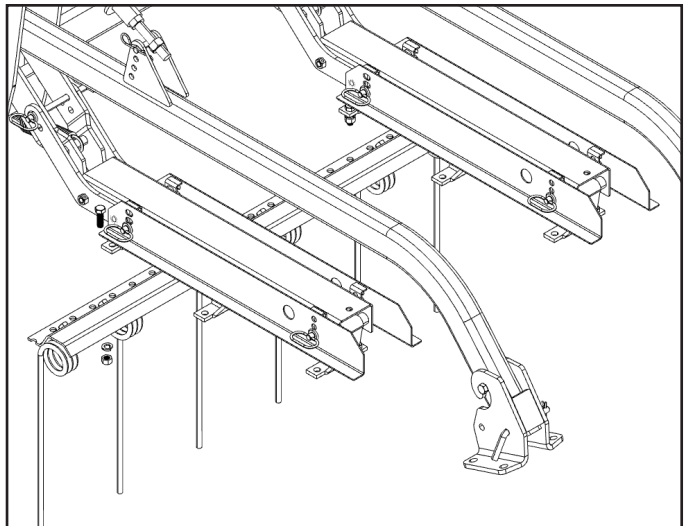

4. Use the supplied 1/2-13 x 1-1/2" bolts (1), lock washers (2), and nuts (3) too install the first harrow section bar to the first pair of pivot brackets.

See pages 10 (for 11' Mainframe XL2) and 16 through 23 to determine what hole on the harrow section bar you need to be using when installing the harrow section bar to the pivot bracket.

Repeat this step for the second and third harrow section bar for each section.

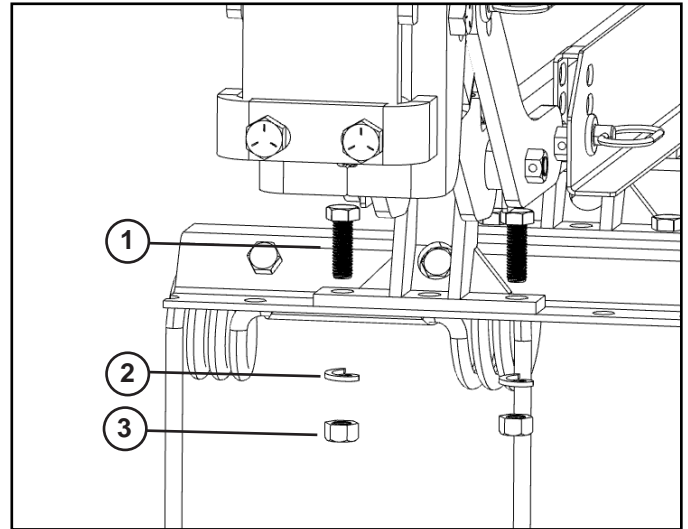

5. Find the reel basket assembly (1) for the correct width of each section.

Loosely install the reel basket assembly to the reel mounts (2) use four of the supplied 5/8-11 x 3" x 4" U-bolts, lock washers, and nuts to install the reel basket assembly to the basket mounts.

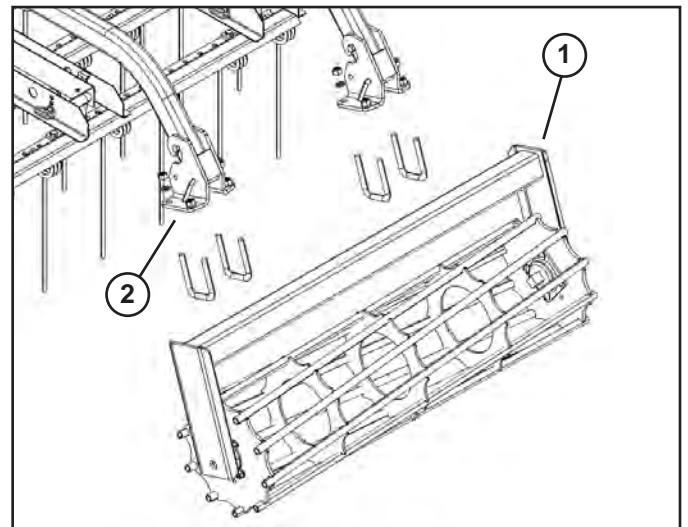

6. After installing the reel basket assemblies, adjust the position of the reel basket assembly in the U-bolts so that there is 3/4" between the ends of each of the basket mounts.
7. Tighten all hardware on the harrow sections, reel basket assembly, and the hardware attaching the harrow arms to the frame using the correct torque.
8. Make sure there is no interference between components when folding the machine. Adjust the position of any components in the event of interference or prevention of wings from folding.

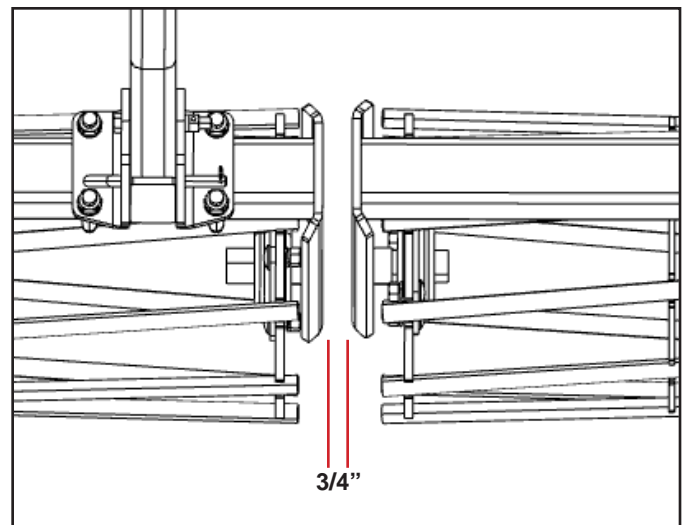

# 11 XL2 Harrow Bracket Bolt Hole Locations

## HARROW

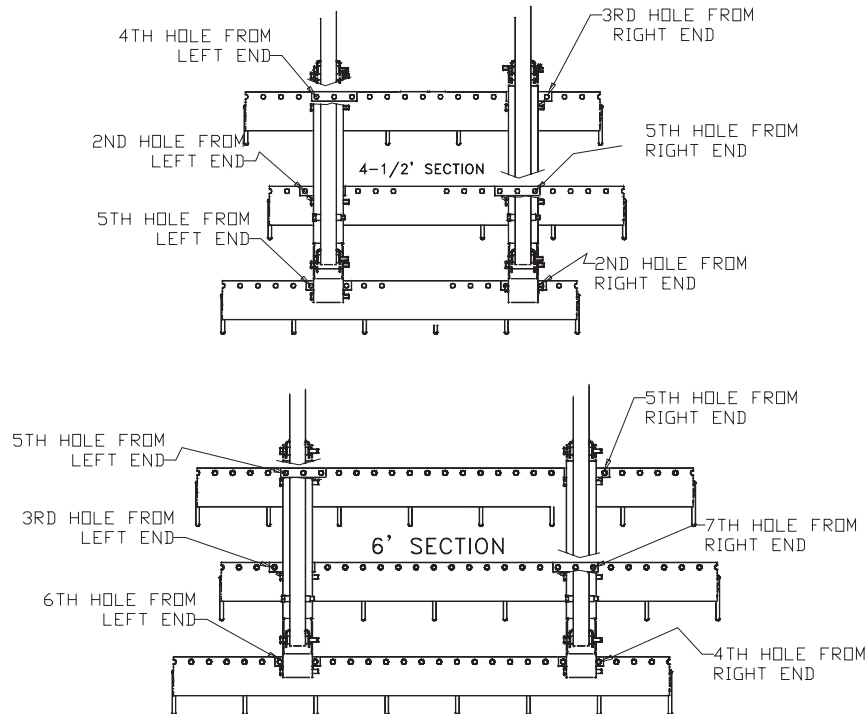

POSITION THE BRACKETS FOR THE TOOTH ADJUST CENTERED BETWEEN THE ARM MOUNTS AS SHOWN. LOCATE THE FRONT AND REAR BRACKETS THE SAME NUMBER OF HOLES FROM THE RIGHT (A).

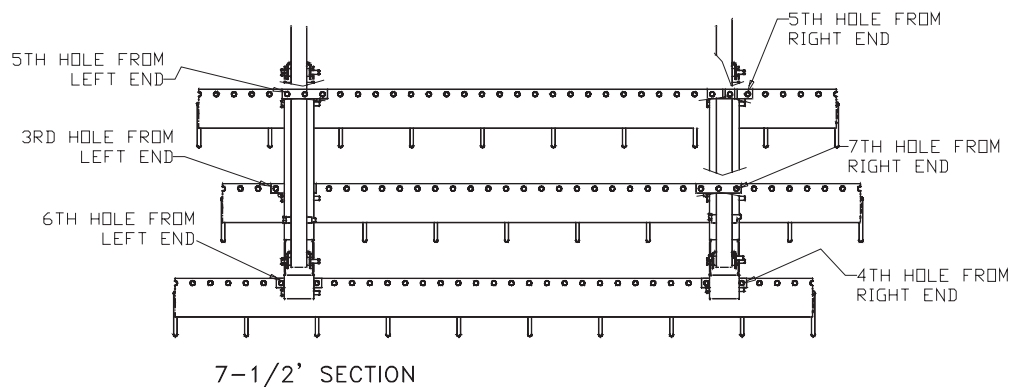

## HARROW BAR MOUNTING

For 11' main frame XL2 models, assemble the section bars to the mount arm assemblies as shown above. The harrow mounting arm locations on the mounting arm location chart are based on the assembly of the harrow bars as shown above.

**NOTE:** Because of changing mounting conditions it may be necessary to move the complete basket arm laterally. In this situation you will need to shift the harrow bars accordingly, move each bar the same number of holes to ensure the correct spacing of the tines.

# 11 XL2 19-20' COIL TINE HARROW WITH BASKET

113"	89"	60"	35"	4"	55"	89"	113"
4-1/2' Section	4-1/2' Section	4-1/2' Section	7-1/2' Section	4-1/2' Section	4-1/2' Section	4-1/2' Section	4-1/2' Section

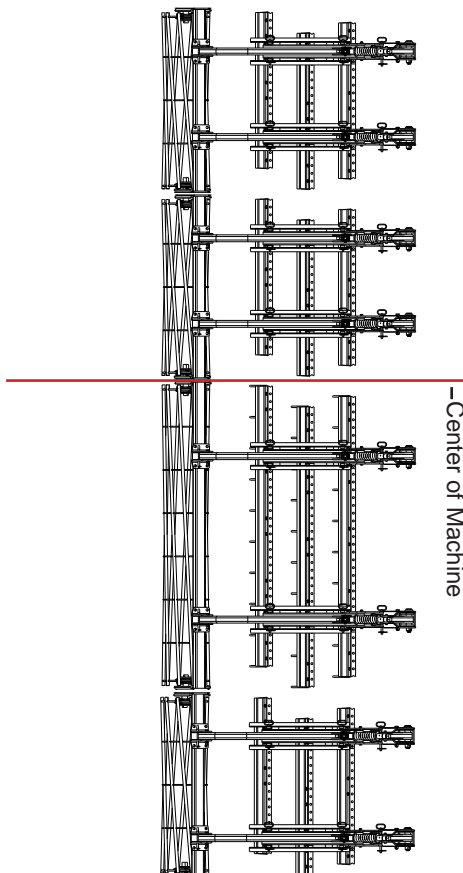

## Arm Location:

Arm location is shown above. These measurements are from the center of the machine to the center of the harrow arm.

Exact arm location could vary either direction, dependent on implement accessories and options. Do not tighten arms completely until all sections are in place

## Harrow Section Bar Mounting:

Harrow section bar mounting hole locations are shown on page 10. Assemble the section bars to the mount arm assemblies as page 10 shows.

The harrow mounting arm locations on the mounting arm location are based on the assembly of the harrow bars as shown above.

## Harrow and Basket Spacing:

The spacing between the harrow bar sections should be approximately 9 inches. This may vary slightly due to interferences.

Starting basket location for the left side mainframe 7-1/2' basket is 16-3/4" from the edge of the basket to the edge of the arm. Space each following basket section 3/4" apart.



# 11 XL2 25' COIL TINE HARROW WITH BASKET

144"	90"	52"	21"	22"	52"	94"	146"
7-1/2' Section		6' Section		6' Section		7-1/2' Section	

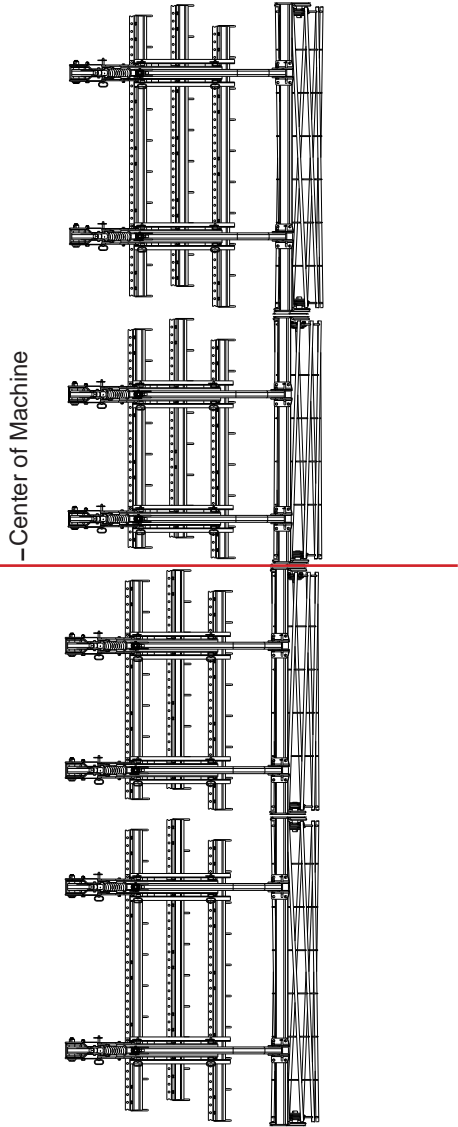

**Arm Location:**

Arm location is shown above. These measurements are from the center of the machine to the center of the harrow arm.

Exact arm location could vary either direction, dependent on implement accessories and options. Do not tighten arms completely until all sections are in place

**Harrow Section Bar Mounting:**

Harrow section bar mounting hole locations are shown on page 10. Assemble the section bars to the mount arm assemblies as page 10 shows.

The harrow mounting arm locations on the mounting arm location are based on the assembly of the harrow bars as shown above.

**Harrow and Basket Spacing:**

The spacing between the harrow bar sections should be approximately 9 inches. This may vary slightly due to interferences.

Starting basket location for the left side mainframe 7-1/2' basket is 16-3/4" from the edge of the basket to the edge of the arm. Space each following basket section 3/4" apart.



# 11 XL2 25-27' COIL TINE HARROW WITH BASKET

148"	98"	62"	10"	32"	62"	98"	148"
7-1/2' Section		7-1/2' Section		6' Section		7-1/2' Section	

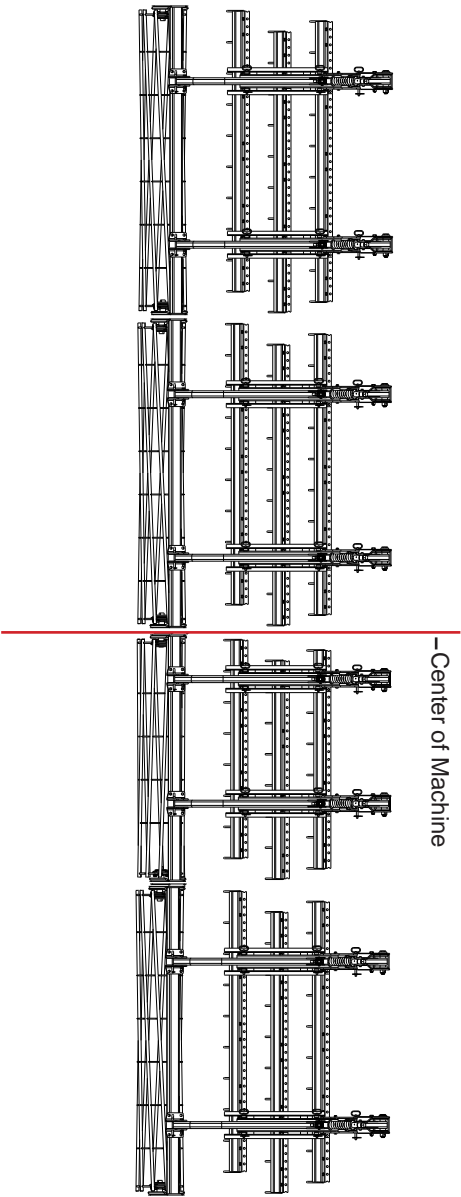

**Arm Location:**

Arm location is shown above. These measurements are from the center of the machine to the center of the harrow arm. Exact arm location could vary either direction, dependent on implement accessories and options. Do not tighten arms completely until all sections are in place

**Harrow Section Bar Mounting:**

Harrow section bar mounting hole locations are shown on page 10. Assemble the section bars to the mount arm assemblies as page 10 shows.

The harrow mounting arm locations on the mounting arm location are based on the assembly of the harrow bars as shown above

**Harrow and Basket Spacing:**

The spacing between the harrow bar sections should be approximately 9 inches. This may vary slightly due to interferences.

Starting basket location for the left side mainframe 7-1/2' basket is 16-3/4" from the edge of the basket to the edge of the arm. Space each following basket section 3/4" apart.

# 11 XL2 30-32' COIL TINE HARROW WITH BASKET

184"	152"	122"	98"	62"	24"	94"	152"	184"
4-1/2' Section	6' Section	7-1/2' Section	6' Section	6' Section	6' Section	6' Section	4-1/2' Section	

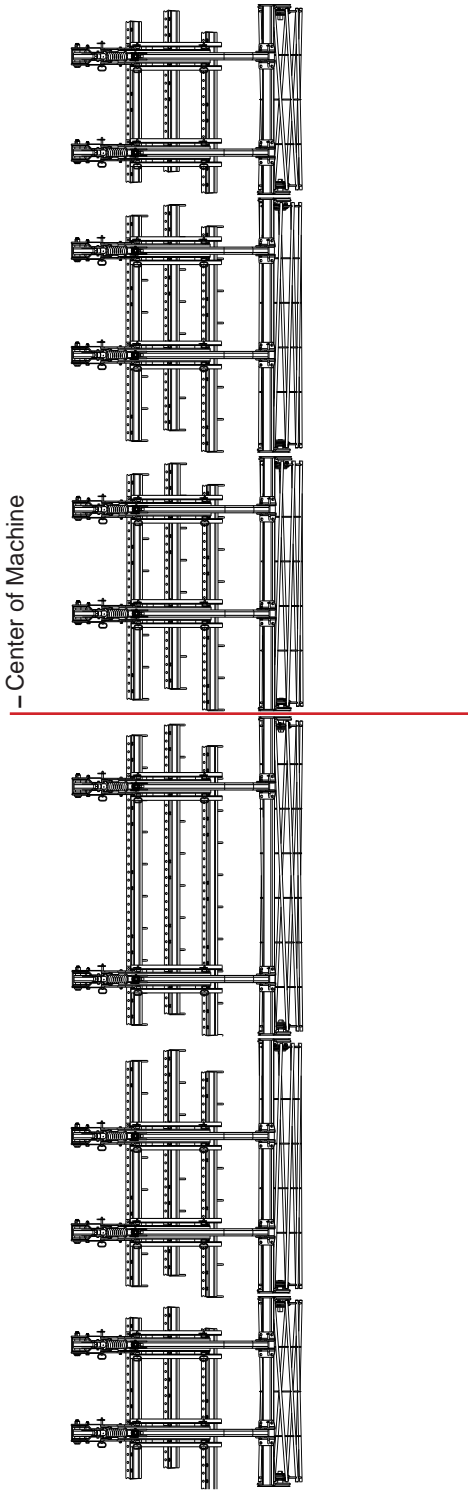

**Arm Location:**

Arm location is shown above. These measurements are from the center of the machine to the center of the harrow arm.

Exact arm location could vary either direction, dependent on implement accessories and options. Do not tighten arms completely until all sections are in place

**Harrow Section Bar Mounting:**

Harrow section bar mounting hole locations are shown on page 10. Assemble the section bars to the mount arm assemblies as page 10 shows.

The harrow mounting arm locations on the mounting arm location are based on the assembly of the harrow bars as shown above

**Harrow and Basket Spacing:**

The spacing between the harrow bar sections should be approximately 9 inches. This may vary slightly due to interferences.

Starting basket location for the left side mainframe 7-1/2' basket is 16" from the edge of the basket to the edge of the arm. Space each following basket section 3/4" apart.

# 11' XL2 30-39' COIL TINE HARROW WITH BASKET

228"	188"	150"	98"	62"	12"	24"	64"	102"	154"	188"	228"
6' Section		7-1/2' Section		7-1/2' Section		6' Section		7-1/2' Section		6' Section	

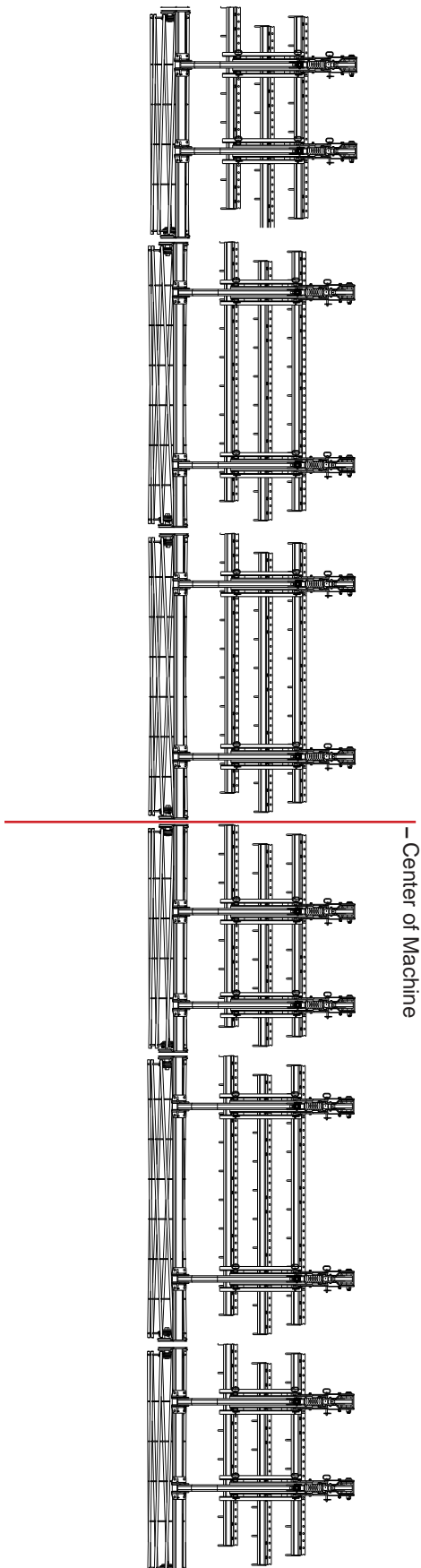

## Arm Location:

Arm location is shown above. These measurements are from the center of the machine to the center of the harrow arm.

Exact arm location could vary either direction, dependent on implement accessories and options. Do not tighten arms completely until all sections are in place

## Harrow Section Bar Mounting:

Harrow section bar mounting hole locations are shown on page 10. Assemble the section bars to the mount arm assemblies as page 10 shows.

The harrow mounting arm locations on the mounting arm location are based on the assembly of the harrow bars as shown above.

## Harrow and Basket Spacing:

The spacing between the harrow bar sections should be approximately 9 inches. This may vary slightly due to interferences.

Starting basket location for the left side mainframe 7-1/2' basket is 16" from the edge of the basket to the edge of the arm. Space each following basket section 3/4" apart.

# 13 XL2/QX2 32' COIL TINE HARROW WITH BASKET

198-3/4" 174" 4-1/2' Section	149-1/4" 124-1/2" 6' Section	77-1/4" 18-3/4" 7-1/2' Section	15" 60" 6' Section	98-3/4" 127-1/2" 6' Section	156-3/4" 174-3/4" 4-1/2' Section
------------------------------	------------------------------	--------------------------------	--------------------	-----------------------------	----------------------------------

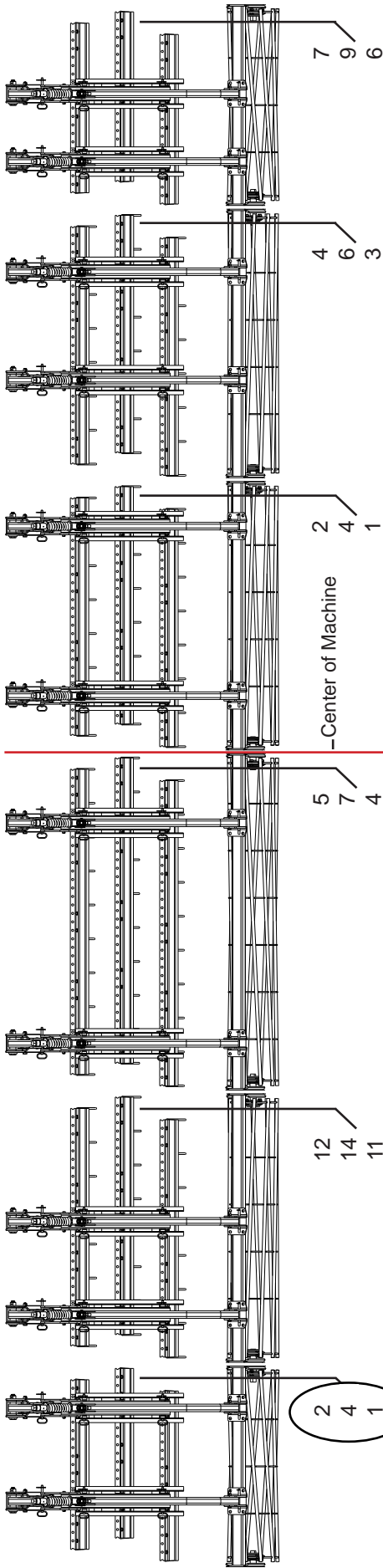

**Arm Location:**

Arm location is shown above. These measurements are from the center of the machine to the center of the harrow arm.

Exact arm location could vary either direction, dependent on implement accessories and options. Do not tighten arms completely until all sections are in place

**Harrow Section Bar Mounting:**

Harrow section bar mounting hole locations are shown above. Assemble the section bars to the mount arm assemblies as the numbers above show.

The harrow mounting arm locations on the mounting arm location are based on the assembly of the harrow bars as shown above.

**Harrow and Basket Spacing:**

The spacing between the harrow bar sections should be approximately 9 inches. This may vary slightly due to interferences.

Starting basket location for the left side mainframe 7-1/2' basket is 15-1/4" from the edge of the basket to the edge of the arm. Space each following basket section 3/4" apart.

# 13 XL2/QX2 32-42' COIL TINE HARROW WITH BASKET

243-1/4"	214"	186-1/2"	159-1/2"	130-1/4"	110"	74"	20"	20-1/2"	70"	110-1/2"	130-3/4"	160	184-3/4"	216-1/4"	243-1/4"
6' Section		4-1/2' Section		4-1/2' Section		7-1/2' Section		7-1/2' Section		4-1/2' Section		4-1/2' Section		6' Section	

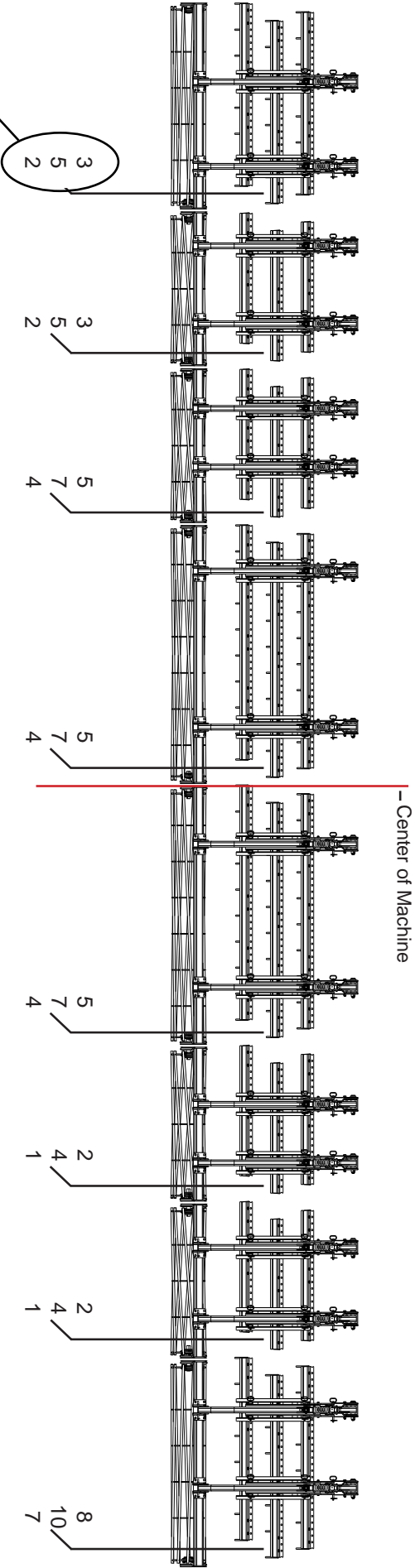

**Arm Location:**

Arm location is shown above. These measurements are from the center of the machine to the center of the harrow arm.

Exact arm location could vary either direction, dependent on implement accessories and options. Do not tighten arms completely until all sections are in place

**Harrow Section Bar Mounting:**

Harrow section bar mounting hole locations are shown above. Assemble the section bars to the mount arm assemblies as the numbers above show.

The harrow mounting arm locations on the mounting arm location are based on the assembly of the harrow bars as shown above.

**Harrow and Basket Spacing:**

The spacing between the harrow bar sections should be approximately 9 inches. This may vary slightly due to interferences.

Starting basket location for the left side mainframe 7-1/2' basket is 16" from the edge of the basket to the edge of the arm. Space each following basket section 3/4" apart.

# 13 XL2/QX2 32-45' COIL TINE HARROW WITH BASKET

260-1/2"	211"	175"	150-1/4"	121"	96-1/4"	58"	10-3/4"	23"	59"	97-1/4"	119-3/4"	148-3/4"	178-1/4"	221"	226"
7-1/2' Section	4-1/2' Section	4-1/2' Section	4-1/2' Section	7-1/2' Section	6' Section	4-1/2' Section	4-1/2' Section	4-1/2' Section	4-1/2' Section	4-1/2' Section	4-1/2' Section	4-1/2' Section	4-1/2' Section	7-1/2' Section	7-1/2' Section

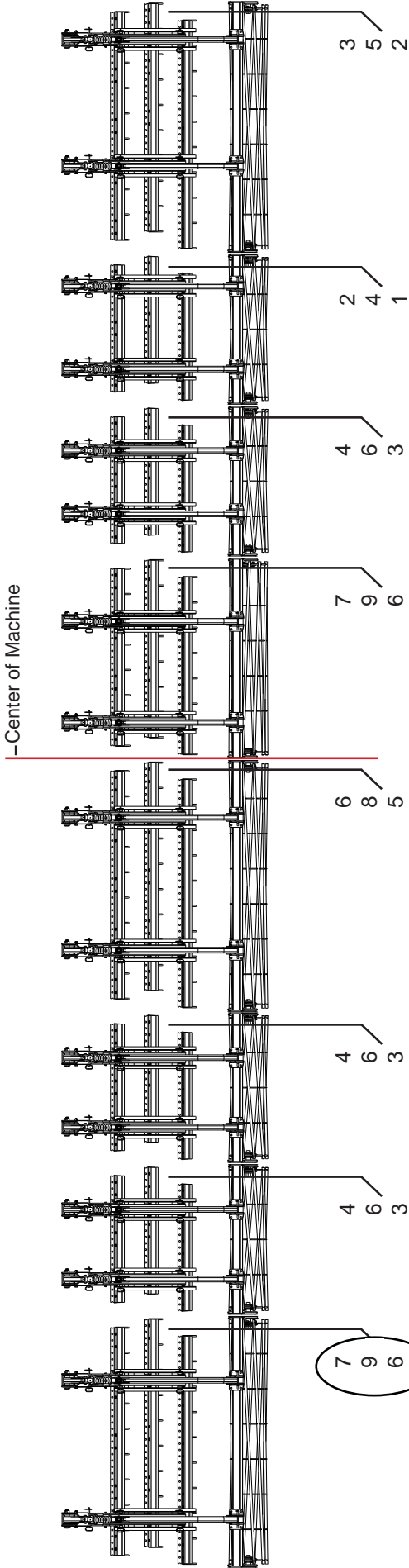

## Arm Location:

Arm location is shown above. These measurements are from the center of the machine to the center of the harrow arm.

Exact arm location could vary either direction, dependent on implement accessories and options. Do not tighten arms completely until all sections are in place

## Harrow Section Bar Mounting:

Harrow section bar mounting hole locations are shown above. Assemble the section bars to the mount arm assemblies as the numbers above show.

The harrow mounting arm locations on the mounting arm location are based on the assembly of the harrow bars as shown above.

## Harrow and Basket Spacing:

The spacing between the harrow bar sections should be approximately 9 inches. This may vary slightly due to interferences.

Starting basket location for the left side mainframe 7-1/2' basket is 16-3/4" from the edge of the basket to the edge of the arm. Space each following basket section 3/4" apart.



# 13 XL2/QX2 37' COIL TINE HARROW WITH BASKET

216-3/4"	176-1/4"	149-1/4"	113-1/4"	75"	21"	21-3/4"	69"	114"	147-3/4"	177"	215-1/4"
6' Section	6' Section	6' Section	6' Section	7-1/2' Section	7-1/2' Section	7-1/2' Section	7-1/2' Section	6' Section	6' Section	6' Section	6' Section

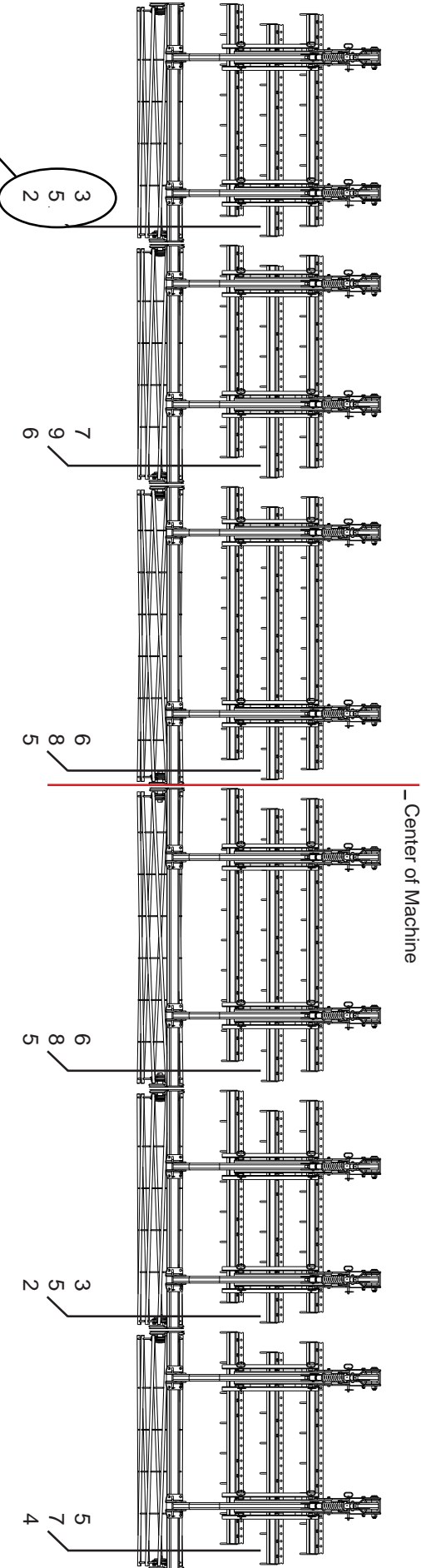

## Arm Location:

Bolt hole location.  
Refer to step 4.  
of harrow arm  
assembly.

Arm location is shown above.  
These measurements are from the center of the machine to the center of the harrow arm.

Exact arm location could vary either direction, dependent on implement accessories and options.  
Do not tighten arms completely until all sections are in place

## Harrow Section Bar Mounting:

Harrow section bar mounting hole locations are shown above. Assemble the section bars to the mount arm assemblies as the numbers above show.

The harrow mounting arm locations on the mounting arm location are based on the assembly of the harrow bars as shown above.

## Harrow and Basket Spacing:

The spacing between the harrow bar sections should be approximately 9 inches. This may vary slightly due to interferences.

Starting basket location for the left side mainframe 7-1/2' basket is 17-3/4" from the edge of the basket to the edge of the arm. Space each following basket section 3/4" apart.

# 13 XL2/QX2 37-50' COIL TINE HARROW WITH BASKET

291"	257-1/4"	207-3/4"	138"	63-3/4"	21-3/4"	109-1/2"	179-1/4"	253-1/2"	291-3/4"
6' Section	6' Section	6' Section	6' Section	7-1/2' Section	7-1/2' Section	6' Section	6' Section	6' Section	6' Section

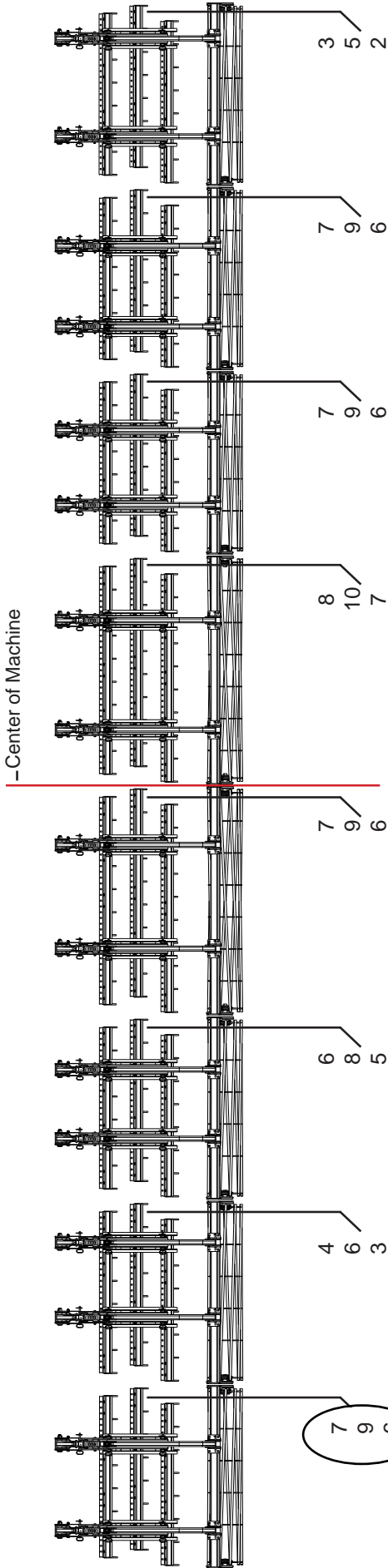

## Arm Location:

Arm location is shown above. These measurements are from the center of the machine to the center of the harrow arm.

Exact arm location could vary either direction, dependent on implement accessories and options. Do not tighten arms completely until all sections are in place

## Harrow Section Bar Mounting:

Harrow section bar mounting hole locations are shown above. Assemble the section bars to the mount arm assemblies as the numbers above show.

The harrow mounting arm locations on the mounting arm location are based on the assembly of the harrow bars as shown above.

## Harrow and Basket Spacing:

The spacing between the harrow bar sections should be approximately 9 inches. This may vary slightly due to interferences.

Starting basket location for the left side mainframe 7-1/2' basket is 19-1/4" from the edge of the basket to the edge of the arm. Space each following basket section 3/4" apart.



# 13 XL2/QX2 46-50' COIL TINE HARROW WITH BASKET

284"	232-1/4"	187-1/4"	158"	130-1/4"	110-1/2"	69-1/2"	24-1/2"	26"	68-3/4"	110"	132-1/2"	156-3/4"	188-1/4"	232-1/4"	284"
7-1/2' Section	6' Section	4-1/2' Section	7-1/2' Section	7-1/2' Section	4-1/2' Section	6' Section	7-1/2' Section	4-1/2' Section	6' Section	7-1/2' Section	6' Section	7-1/2' Section	7-1/2' Section	7-1/2' Section	7-1/2' Section

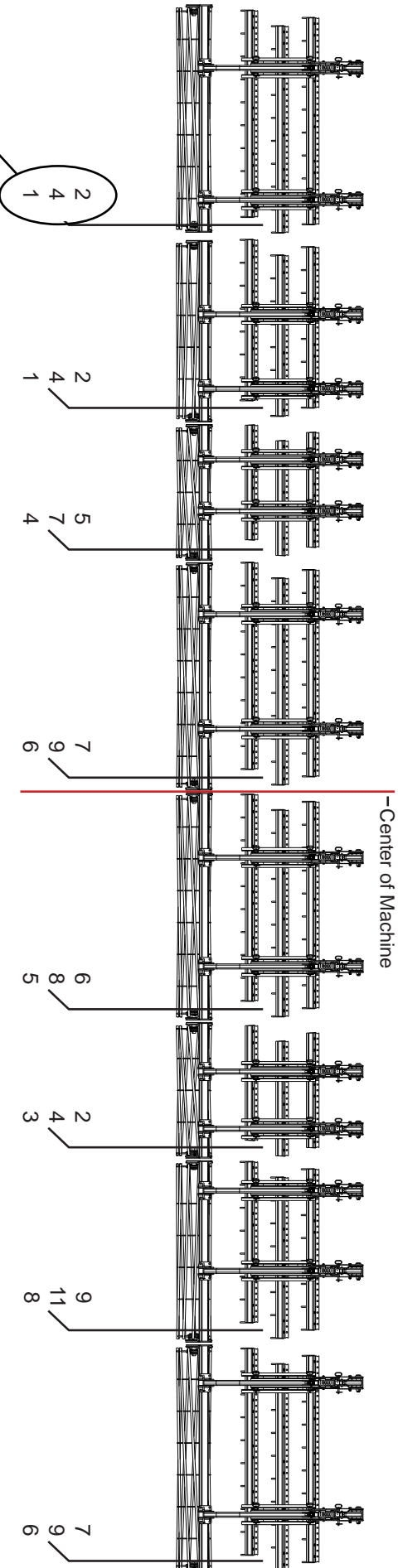

## Arm Location:

Arm location is shown above. These measurements are from the center of the machine to the center of the harrow arm.

Exact arm location could vary either direction, dependent on implement accessories and options. Do not tighten arms completely until all sections are in place

## Harrow Section Bar Mounting:

Harrow section bar mounting hole locations are shown above. Assemble the section bars to the mount arm assemblies as the numbers above show.

The harrow mounting arm locations on the mounting arm location are based on the assembly of the harrow bars as shown above.

## Harrow and Basket Spacing:

The spacing between the harrow bar sections should be approximately 9 inches. This may vary slightly due to interferences.

Starting basket location for the left side mainframe 7'-1/2' basket is 20'-1/2" from the edge of the basket to the edge of the arm. Space each following basket section 3/4" apart.

*Coil Tine Harrow with Basket*  
74389

- Center of Machine

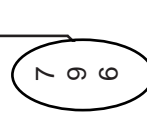

**Bolt hole location.  
Refer to step 4.  
of harrow arm  
assembly.**

## Harrow and Basket Spacing:

The spacing between the harrow bar sections should be approximately 9 inches. This may vary slightly due to interferences.

Starting basket location for the left side mainframe 7-1/2" basket is 16" from the edge of the basket to the edge of the arm. Space each following basket section 3/4" apart.

# 13 XL2/QX2 60' COIL TINE HARROW WITH BASKET

339-3/4"	316-1/2"	279"	245-1/2"	210-1/2"	174-3/4"	141-1/4"	101"	62"	3-3/4"	28-3/4"	67-1/4"	109"	133-1/4"	165-1/4"	202"	239-3/4"	278"	316"	340-1/2"
6' Section	6' Section	6' Section	6' Section	6' Section	6' Section	6' Section	6' Section	7-1/2' Section	6' Section	6' Section	6' Section	6' Section	6' Section	6' Section	6' Section	6' Section	6' Section	6' Section	6' Section

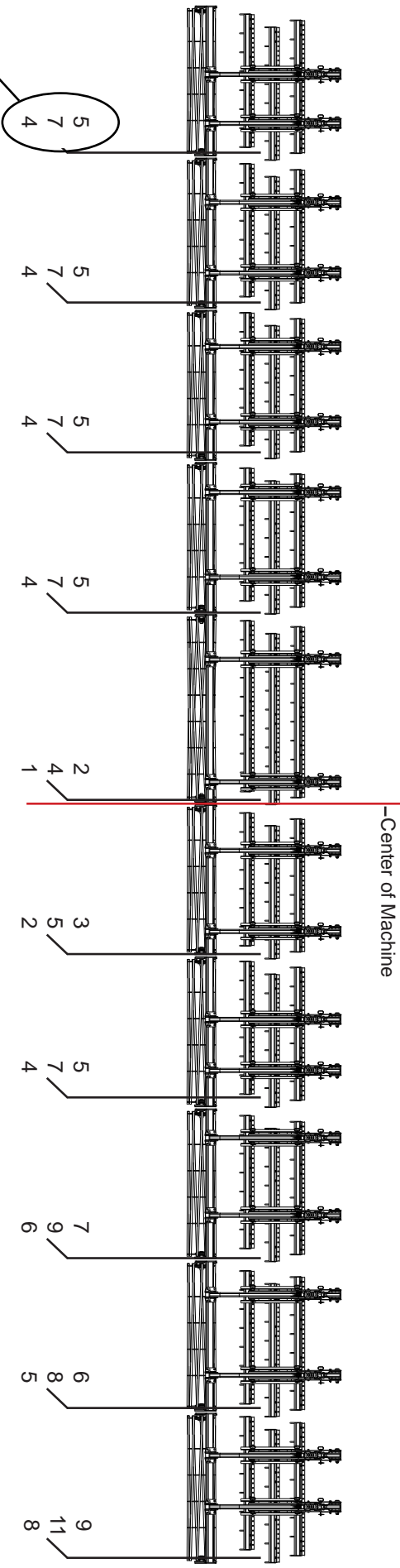

## Arm Location:

Arm location is shown above. These measurements are from the center of the machine to the center of the harrow arm.

Exact arm location could vary either direction, dependent on implement accessories and options. Do not tighten arms completely until all sections are in place

## Harrow Section Bar Mounting:

Harrow section bar mounting hole locations are shown above. Assemble the section bars to the mount arm assemblies as the numbers above show.

The harrow mounting arm locations on the mounting arm location are based on the assembly of the harrow bars as shown above.

## Harrow and Basket Spacing:

The spacing between the harrow bar sections should be approximately 9 inches. This may vary slightly due to interferences.

Starting basket location for the left side mainframe 7'-1/2' basket is 6" from the edge of the basket to the edge of the arm. Space each following basket section 3/4" apart.

### 1. Installing the Hydraulic Lift Kit:

Begin by installing the hydraulic basket cylinder mounting plate (1) to the harrow basket arm assembly. Using the 1/2-13 x 3-1/2" bolts, lock washers, and nuts (2).

NOTE: Place one of the bolts in the fourth hole from the left on the top of the plate (3). Place the plate so that this bolt touches the spring ear (4) as shown in the photo.

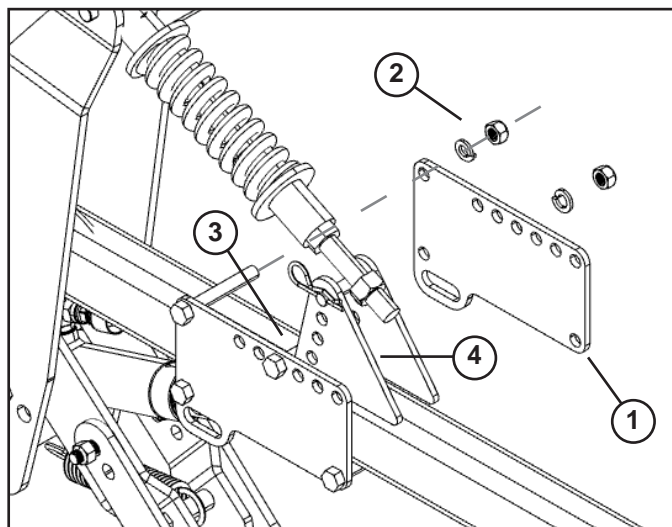

2. Install the elbow (1) and 3/8 x 24" hydraulic hose (2) onto the base end of each basket lift cylinder.

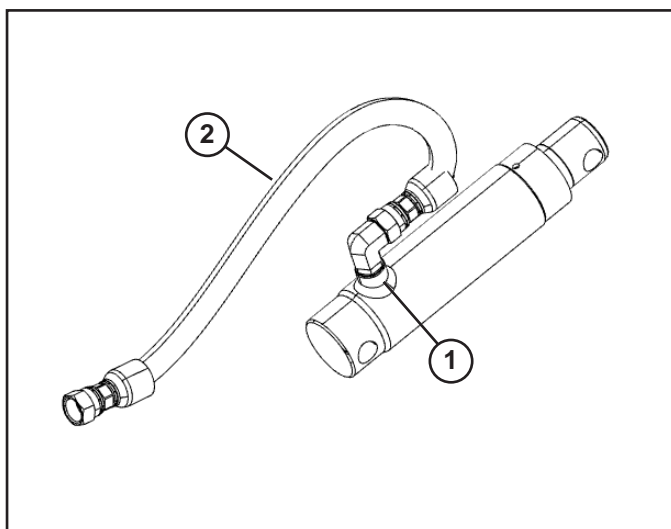

3. Install the rod end of the cylinder (1) into the cylinder mounting plate slot using the 5/8-11 x 4" bolt (2), flat washer, and lock nut.

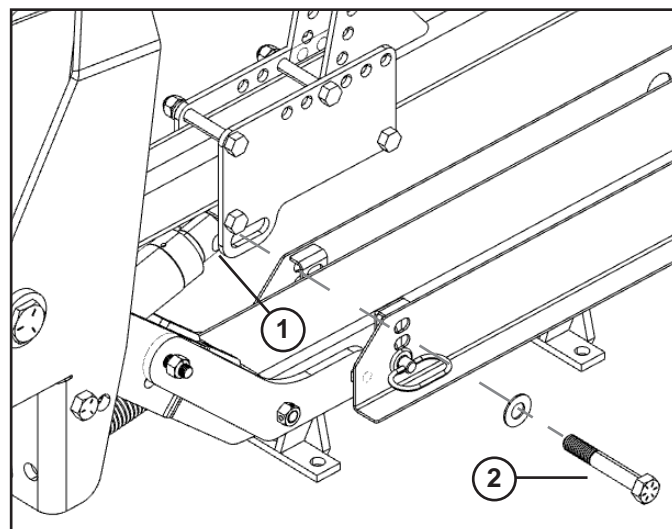

4. Install the base end of the cylinder into the harrow basket mount using the 5/8-11 x 4" bolt (2), bushings, and lock nut.

**NOTE:** The image shows the hydraulic hose routed through the back of the harrow basket mount. **Route the 3/8 x 24" hydraulic hose around the outside of the harrow basket mount.**

**NOTE:** The image shows the spacers on the outside of the harrow basket mount, this is for visual representation only. These are to be used on the inside of the harrow basket mount next to the base end of the cylinder.

Repeat steps 3 and 4 for each harrow arm mount.

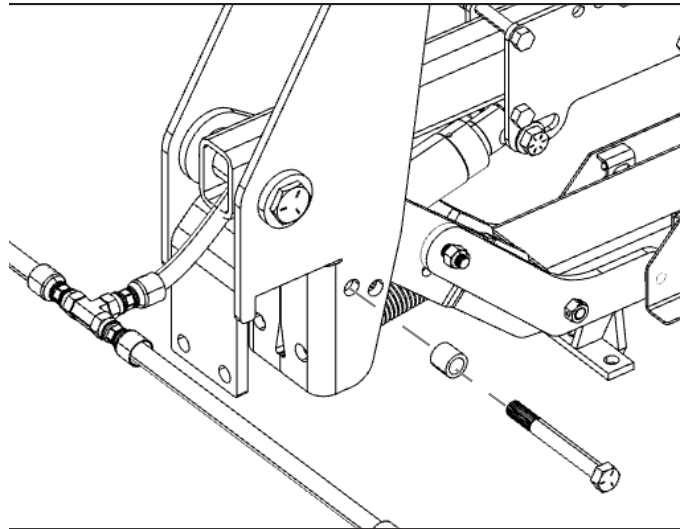

5. Route the hydraulics. Refer to pages 26 through 41 for hydraulic hose routings.

**NOTE:** To get hydraulic hoses to fit on the machine the harrow arm layout will need to match the listed on pages 16 through 23.

**NOTE:** The image shows the hydraulic hose routed through the back of the harrow basket mount. **Route the 3/8 x 24" hydraulic hose around the outside of the harrow basket mount.**

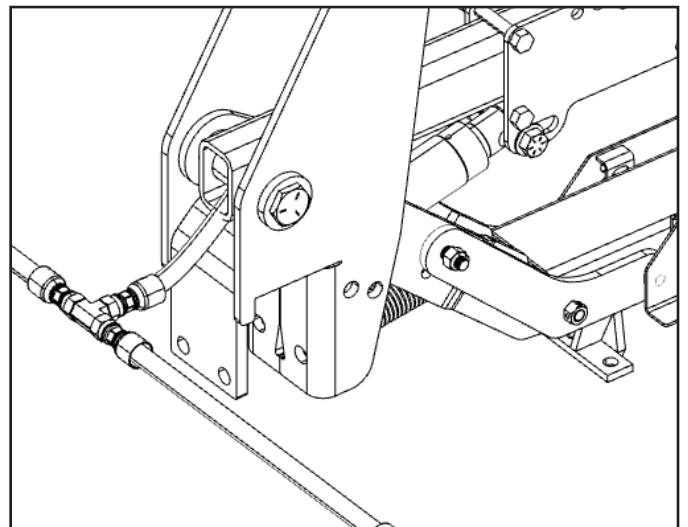

6. Install the hose coupler (1) and grip (2) on the end of the 3/8 x 400" hydraulic hose (3) using a union (4) and adapter (5).

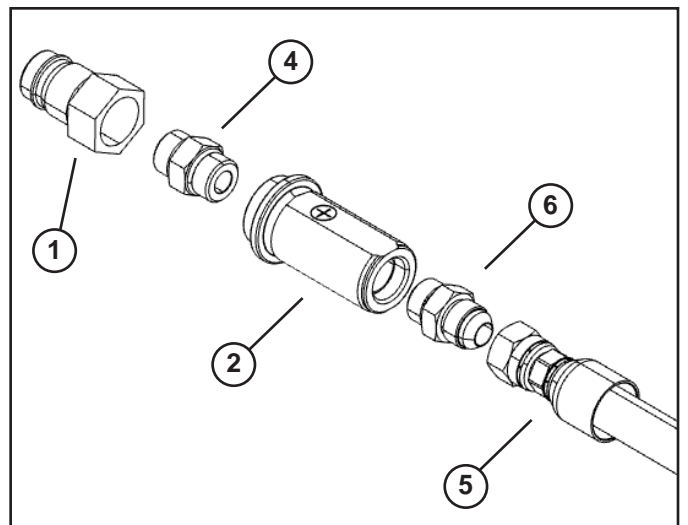

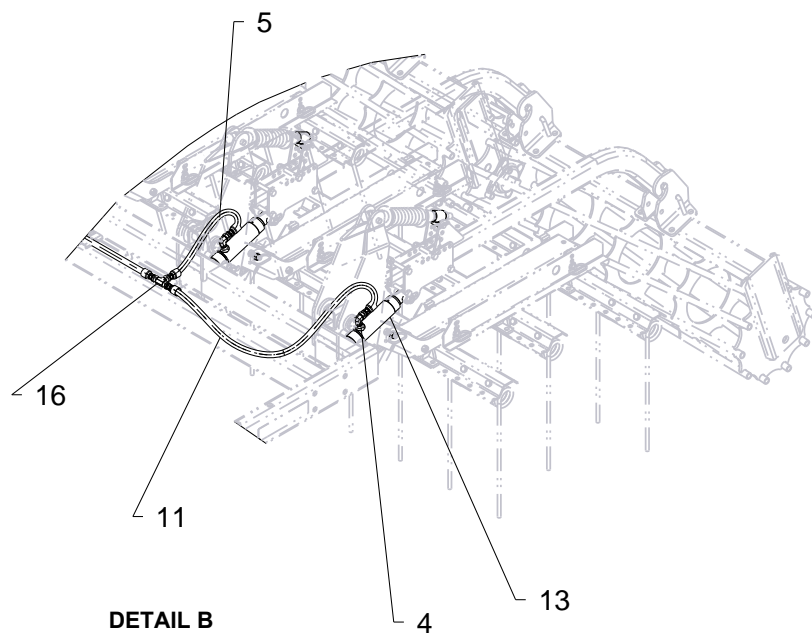
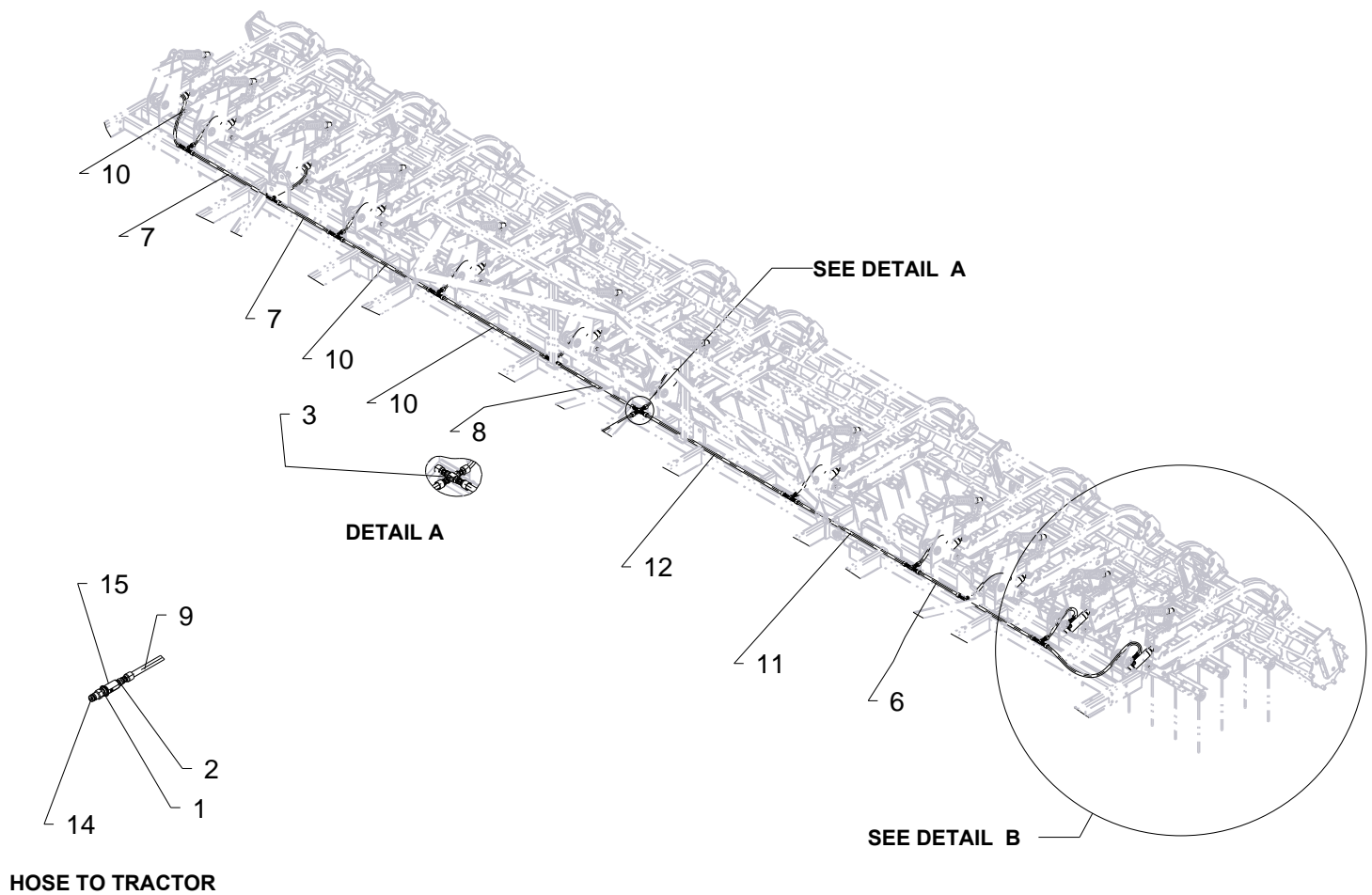

701512-A



## 13 QX2/XL2 32' BASKET HYDRAULICS

ITEM	PART NO.	DESCRIPTION
1	P334210	-8MORB X -8MORB UNION
2	P24024	ADP 8MORB X 8MJ
3	P15910	CROSS 8MJ X 8MJ X 8MJ X 8MJ ELB
4	P62437	8MJ X 6MORB
5	P13423	HSE 3KPSI 3/8X24 8FJX-8FJX
6	P13261	HSE 3KPSI 3/8X30 8FJX-8FJX
7	P25596	HSE 3KPSI 3/8X32 8FJX-8FJX
8	P14644	HSE 3KPSI 3/8X36 8FJX-8FJX HSE
9	P247432	3KPSI 3/8X400 8FJX-8FJX
10	P56539	HSE 3KPSI 3/8X50 8FJX-8FJX
11	P13265	HSE 3KPSI 3/8X56 8FJX-8FJX
12	P15515	HSE 3KPSI 3/8X62 8FJX-8FJX
13	P333361	HYD CYL 1-3/4X4 WELDED
14	P247425	QUICK COUPLER 8 ORB
15	P334206	RED QD GRIP -8FORB PACK OF 2
16	P13238	TEE 8MJ X 8MJ X 8MJ

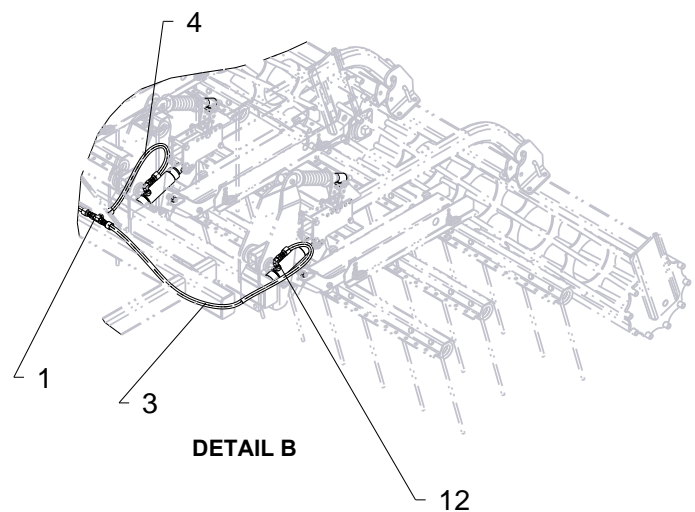
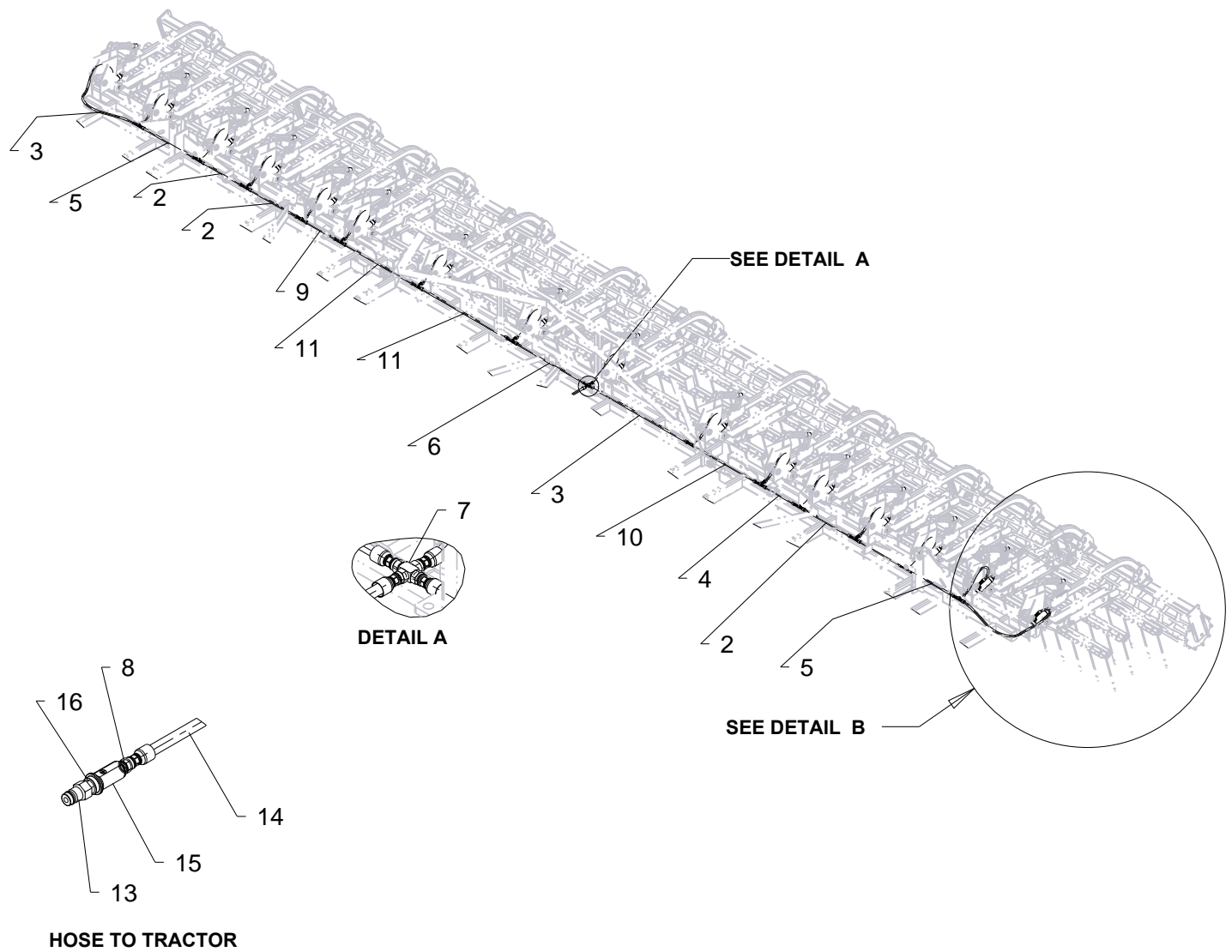

701514-A



## 13 QX2/XL2 32-42' BASKET HYDRAULICS

ITEM	PART NO.	DESCRIPTION
1	P13238	TEE 8MJ X 8MJ X 8MJ
2	P13261	HSE 3KPSI 3/8X30 8FJX-8FJX
3	P13265	HSE 3KPSI 3/8X56 8FJX-8FJX
4	P13423	HSE 3KPSI 3/8X24 8FJX-8FJX
5	P14644	HSE 3KPSI 3/8X36 8FJX-8FJX
6	P14851	HSE 3KPSI 3/8X42 8FJX-8FJX
7	P15910	CROSS 8MJ X 8MJ X 8MJ X 8MJ
8	P24024	ADP 8MORB X 8MJ
9	P25594	HSE 3KPSI 3/8X21 8FJX-8FJX
10	P25597	HSE 3KPSI 3/8X40 8FJX-8FJX
11	P56539	HSE 3KPSI 3/8X50 8FJX-8FJX
12	P62437	ELB 8MJ X 6MORB
13	P247425	QUICK COUPLER 8 ORB
14	P247432	HSE 3KPSI 3/8X400 8FJX-8FJX
15	P334206	RED QD GRIP -8FORB PACK OF 2
16	P334210	-8MORB X -8MORB UNION

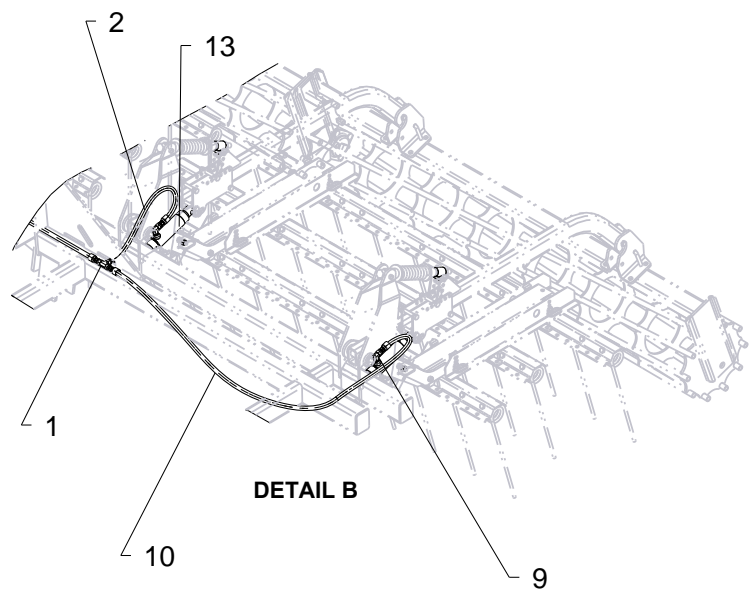
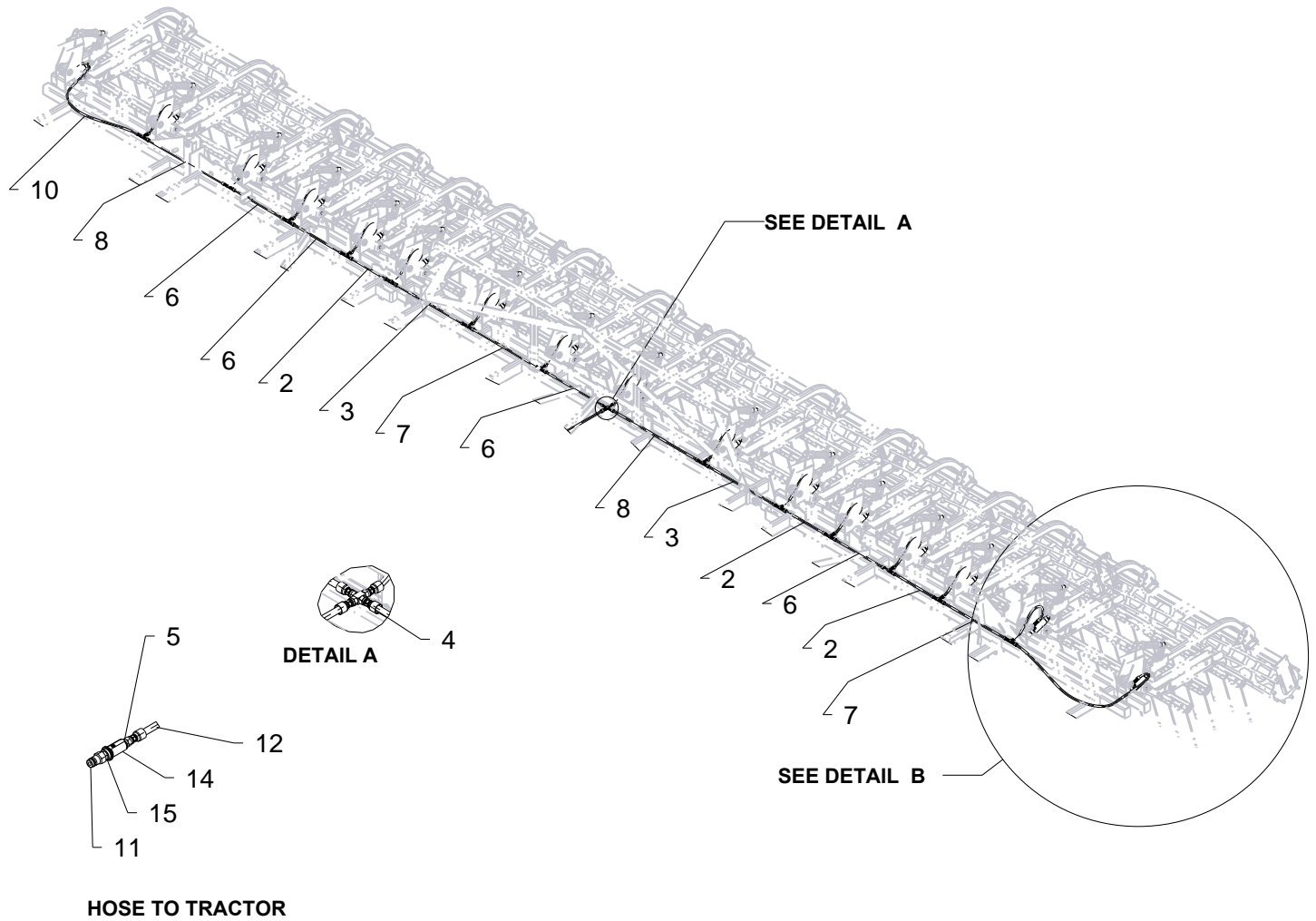

701515-A

## 13 QX2/XL2 32-45' BASKET HYDRAULICS

ITEM	PART NO.	DESCRIPTION
1	P13238	TEE 8MJ X 8MJ X 8MJ
2	P13423	HSE 3KPSI 3/8X24 8FJX-8FJX
3	P14851	HSE 3KPSI 3/8X42 8FJX-8FJX
4	P15910	CROSS 8MJ X 8MJ X 8MJ X 8MJ
5	P24024	ADP 8MORB X 8MJ
6	P25596	HSE 3KPSI 3/8X32 8FJX-8FJX
7	P25597	HSE 3KPSI 3/8X40 8FJX-8FJX
8	P56539	HSE 3KPSI 3/8X50 8FJX-8FJX
9	P62437	ELB 8MJ X 6MORB
10	P67636	HSE 3KPSI 3/8X72 8FJX-8FJX
11	P247425	QUICK COUPLER 8 ORB
12	P247432	HSE 3KPSI 3/8X400 8FJX-8FJX
13	P333361	HYD CYL 1-3/4X4 WELDED
14	P334206	RED QD GRIP -8FORB PACK OF 2
15	P334210	-8MORB X -8MORB UNION

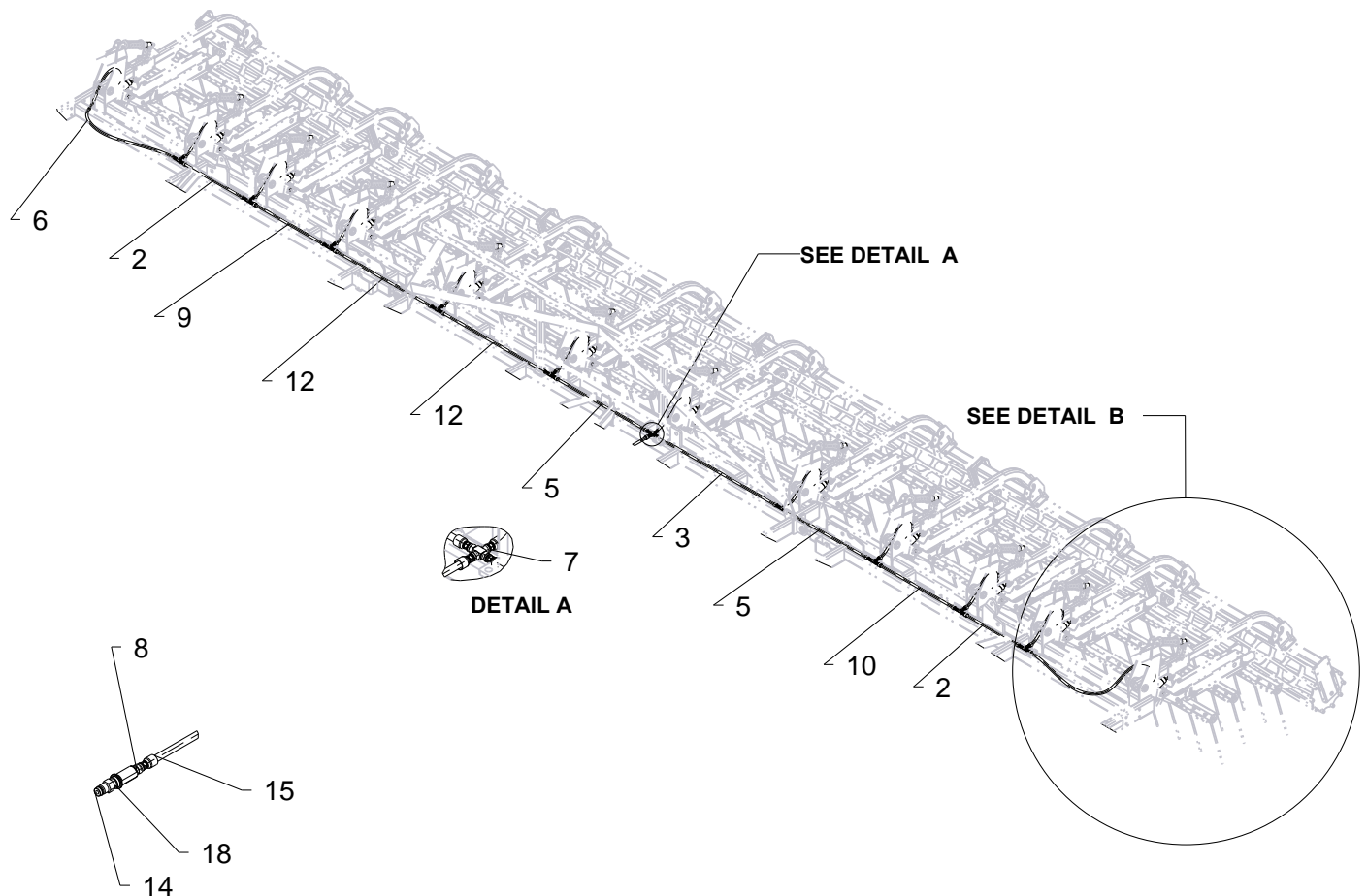

**HOSE TO TRACTOR**

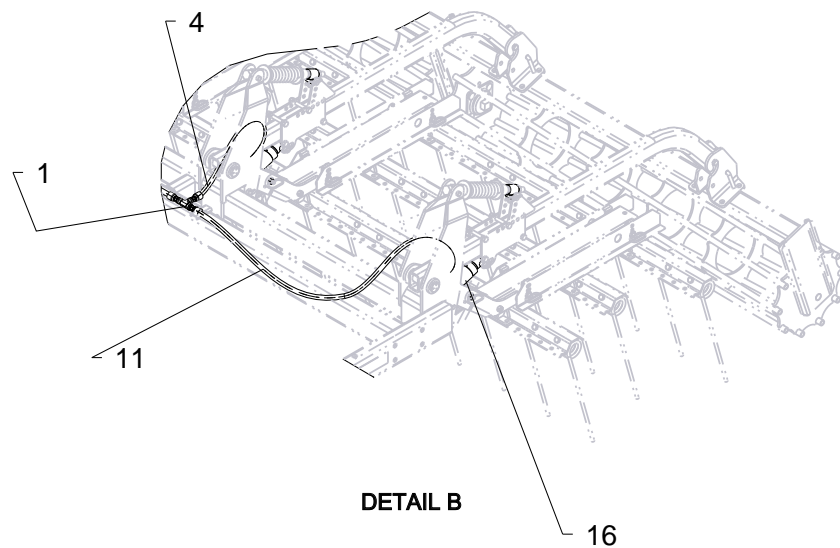

701516-A

## 13 QX2/XL2 37' BASKET HYDRAULICS

ITEM	PART NO.	DESCRIPTION
1	P13238	TEE 8MJ X 8MJ X 8MJ
2	P13261	HSE 3KPSI 3/8X30 8FJX-8FJX
3	P13265	HSE 3KPSI 3/8X56 8FJX-8FJX
4	P13423	HSE 3KPSI 3/8X24 8FJX-8FJX
5	P14851	HSE 3KPSI 3/8X42 8FJX-8FJX
6	P15515	HSE 3KPSI 3/8X62 8FJX-8FJX
7	P15910	CROSS 8MJ X 8MJ X 8MJ X 8MJ
8	P24024	ADP 8MORB X 8MJ
9	P25596	HSE 3KPSI 3/8X32 8FJX-8FJX
10	P25597	HSE 3KPSI 3/8X40 8FJX-8FJX
11	P25602	HSE 3KPSI 3/8X65 8FJX-8FJX
12	P56539	HSE 3KPSI 3/8X50 8FJX-8FJX
13	P62437	ELB 8MJ X 6MORB
14	P247425	QUICK COUPLER 8 ORB
15	P247432	HSE 3KPSI 3/8X400 8FJX-8FJX
16	P333361	HYD CYL 1-3/4X4 WELDED
17	P334206	RED QD GRIP -8FORB PACK OF 2
18	P334210	-8MORB X -8MORB UNION

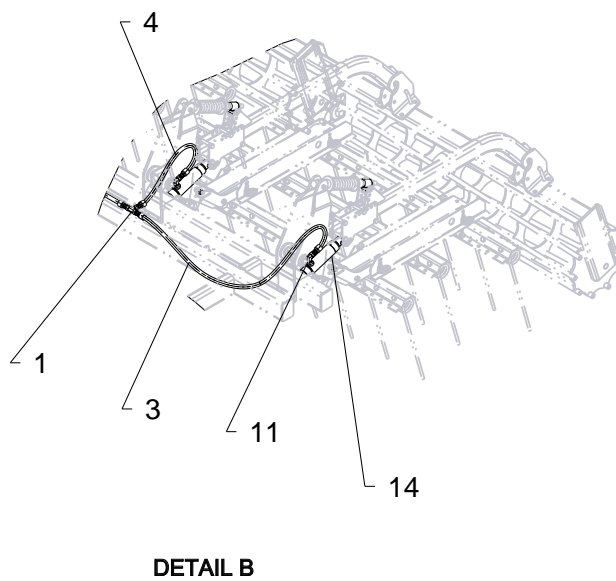
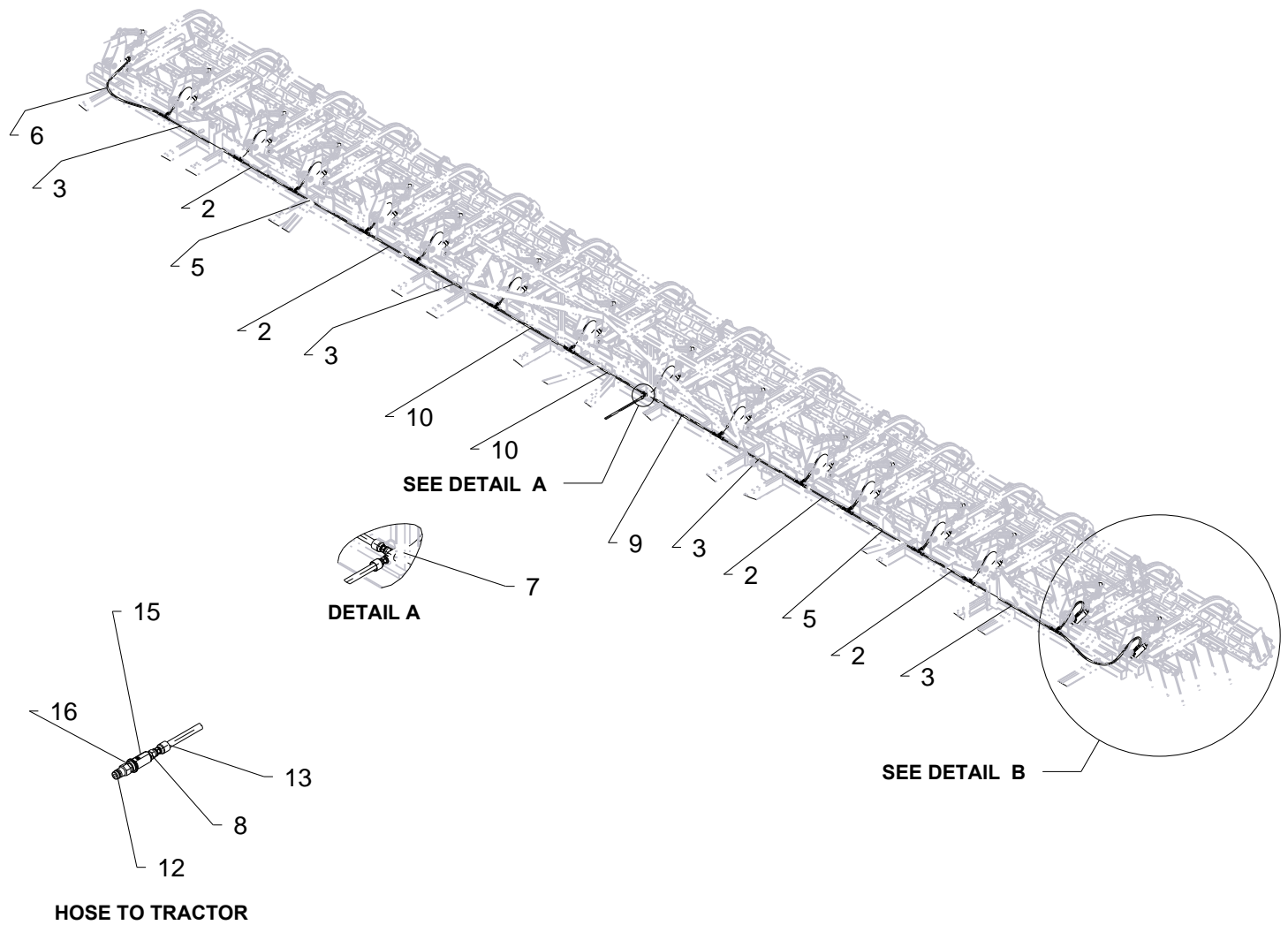

701517-A

## 13 QX2/XL2 37-50' BASKET HYDRAULICS

ITEM	PART NO.	DESCRIPTION
1	P13238	TEE 8MJ X 8MJ X 8MJ
2	P13261	HSE 3KPSI 3/8X30 8FJX-8FJX
3	P13265	HSE 3KPSI 3/8X56 8FJX-8FJX
4	P13423	HSE 3KPSI 3/8X24 8FJX-8FJX
5	P14851	HSE 3KPSI 3/8X42 8FJX-8FJX
6	P15515	HSE 3KPSI 3/8X62 8FJX-8FJX
7	P15910	CROSS 8MJ X 8MJ X 8MJ X 8MJ
8	P24024	ADP 8MORB X 8MJ
9	P25597	HSE 3KPSI 3/8X40 8FJX-8FJX
10	P56539	HSE 3KPSI 3/8X50 8FJX-8FJX
11	P62437	ELB 8MJ X 6MORB
12	P247425	QUICK COUPLER 8 ORB
13	P247432	HSE 3KPSI 3/8X400 8FJX-8FJX
14	P333361	HYD CYL 1-3/4X4 WELDED
15	P334206	RED QD GRIP -8FORB PACK OF 2
16	P334210	-8MORB X -8MORB UNION

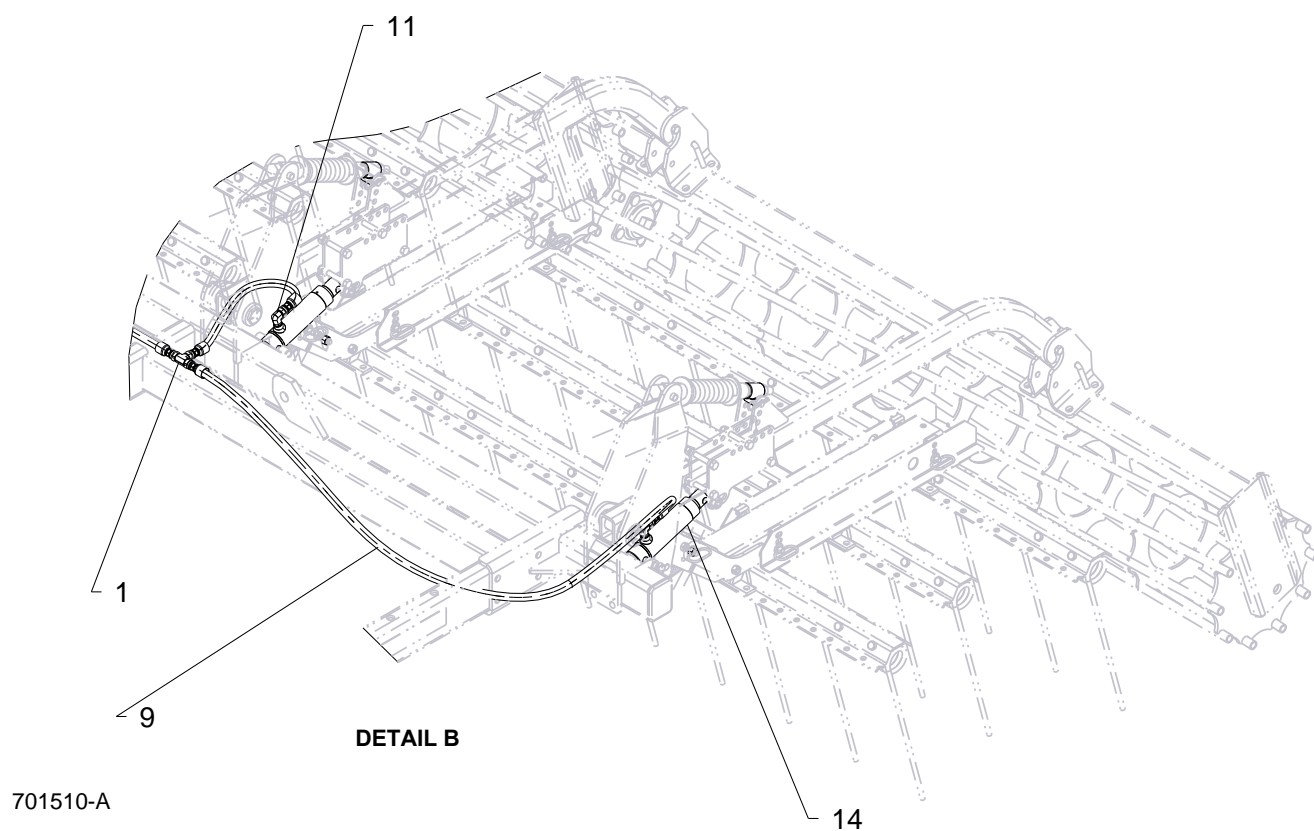
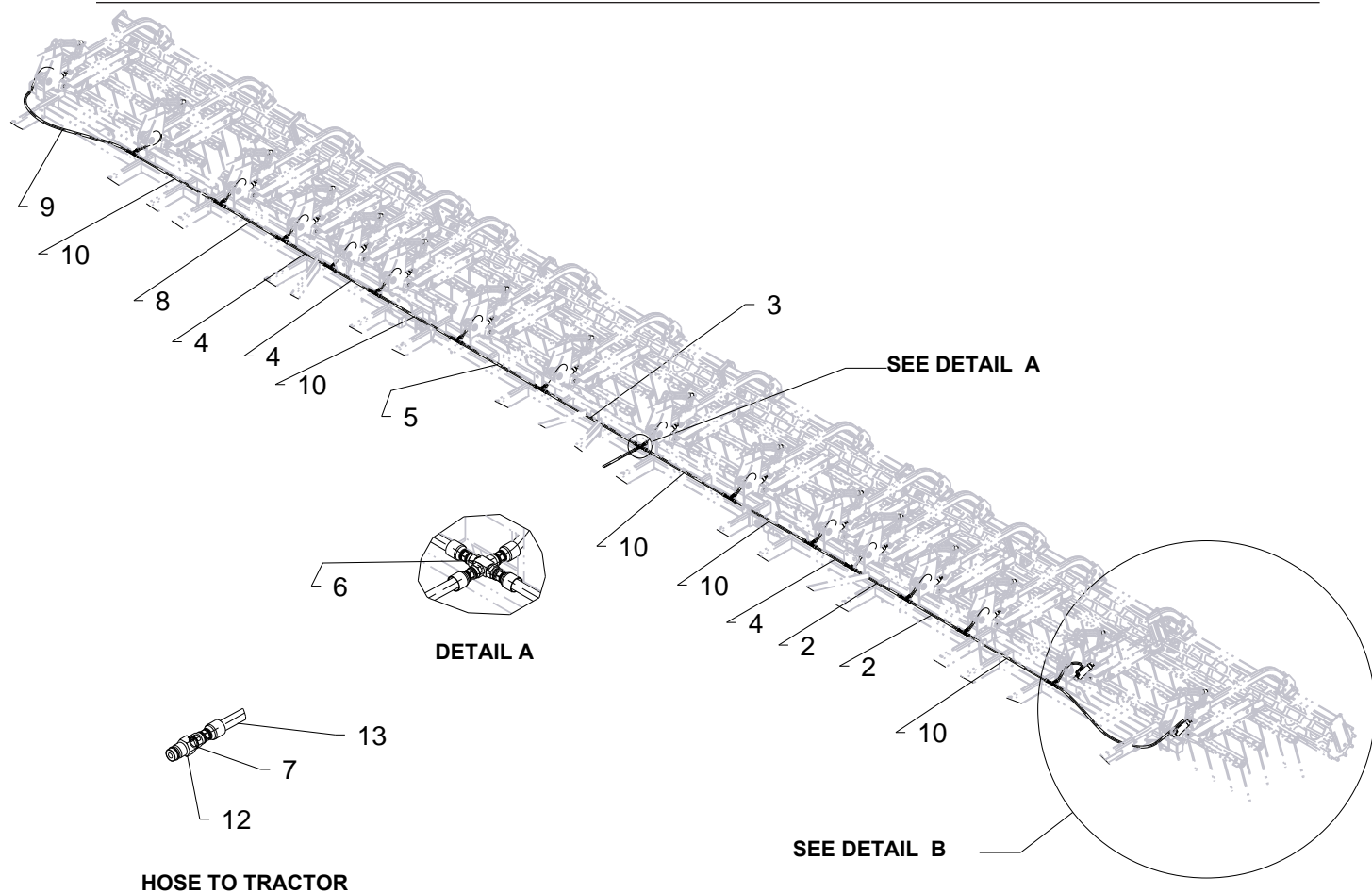



## 13 QX2/XL2 46-50' BASKET HYDRAULICS

ITEM	PART NO.	DESCRIPTION
1	P13238	TEE 8MJ X 8MJ X 8MJ
2	P13261	HSE 3KPSI 3/8X30 8FJX-8FJX
3	P13265	HSE 3KPSI 3/8X56 8FJX-8FJX
4	P13423	HSE 3KPSI 3/8X24 8FJX-8FJX
5	P14851	HSE 3KPSI 3/8X42 8FJX-8FJX
6	P15910	CROSS 8MJ X 8MJ X 8MJ X 8MJ
7	P24024	ADP 8MORB X 8MJ
8	P25596	HSE 3KPSI 3/8X32 8FJX-8FJX
9	P25603	HSE 3KPSI 3/8X75 8FJX-8FJX
10	P56539	HSE 3KPSI 3/8X50 8FJX-8FJX
11	P62437	ELB 8MJ X 6MORB
12	P247425	QUICK COUPLER 8 ORB
13	P247432	HSE 3KPSI 3/8X400 8FJX-8FJX
14	P333361	HYD CYL 1-3/4X4 WELDED

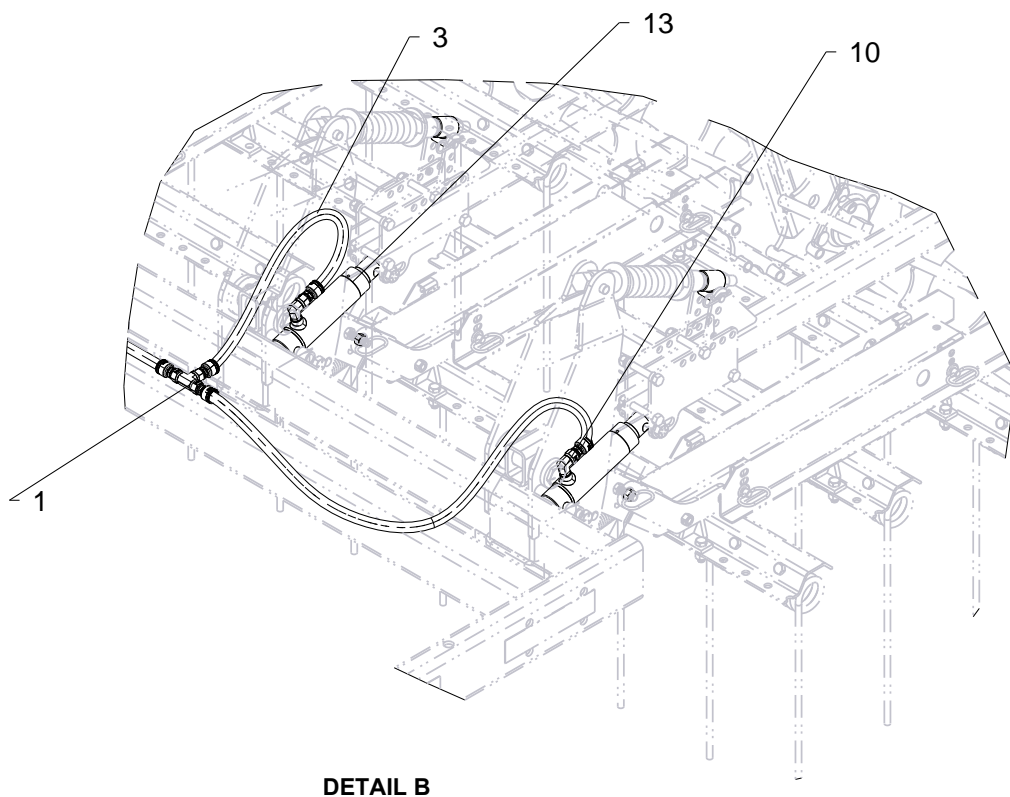
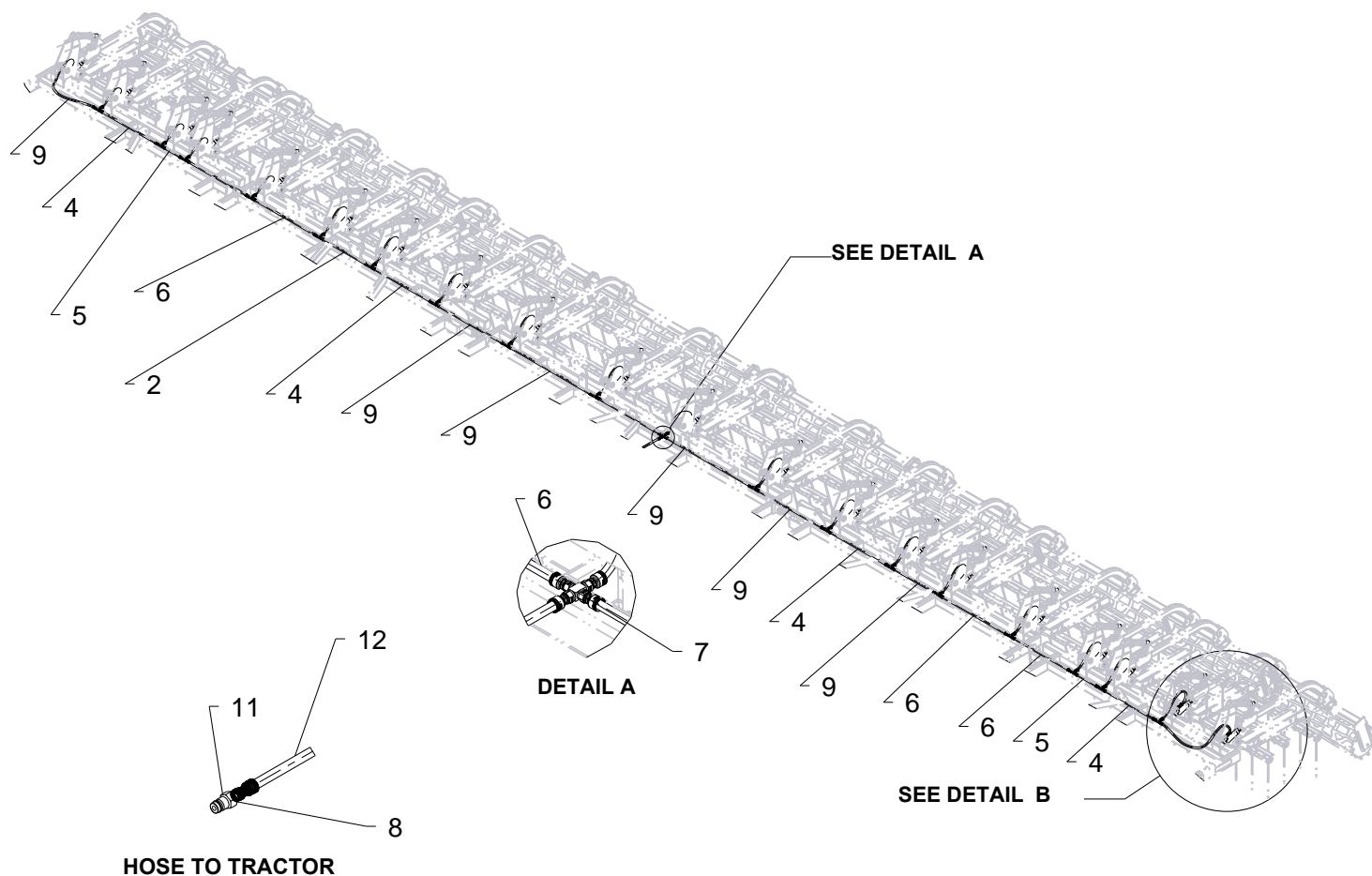

701509-A

## 13 QX2/XL2 55' BASKET HYDRAULICS

ITEM	PART NO.	DESCRIPTION
1	P13238	TEE 8MJ X 8MJ X 8MJ
2	P13261	HSE 3KPSI 3/8X30 8FJX-8FJX
3	P13423	HSE 3KPSI 3/8X24 8FJX-8FJX
4	P14644	HSE 3KPSI 3/8X36 8FJX-8FJX
5	P14850	HSE 3KPSI 3/8X18 8FJX-8FJX
6	P14851	HSE 3KPSI 3/8X42 8FJX-8FJX
7	P15910	CROSS 8MJ X 8MJ X 8MJ X 8MJ
8	P24024	ADP 8MORB X 8MJ
9	P56539	HSE 3KPSI 3/8X50 8FJX-8FJX
10	P62437	ELB 8MJ X 6MORB
11	P247425	QUICK COUPLER 8 ORB
12	P247432	HSE 3KPSI 3/8X400 8FJX-8FJX
13	P333361	HYD CYL 1-3/4X4 WELDED

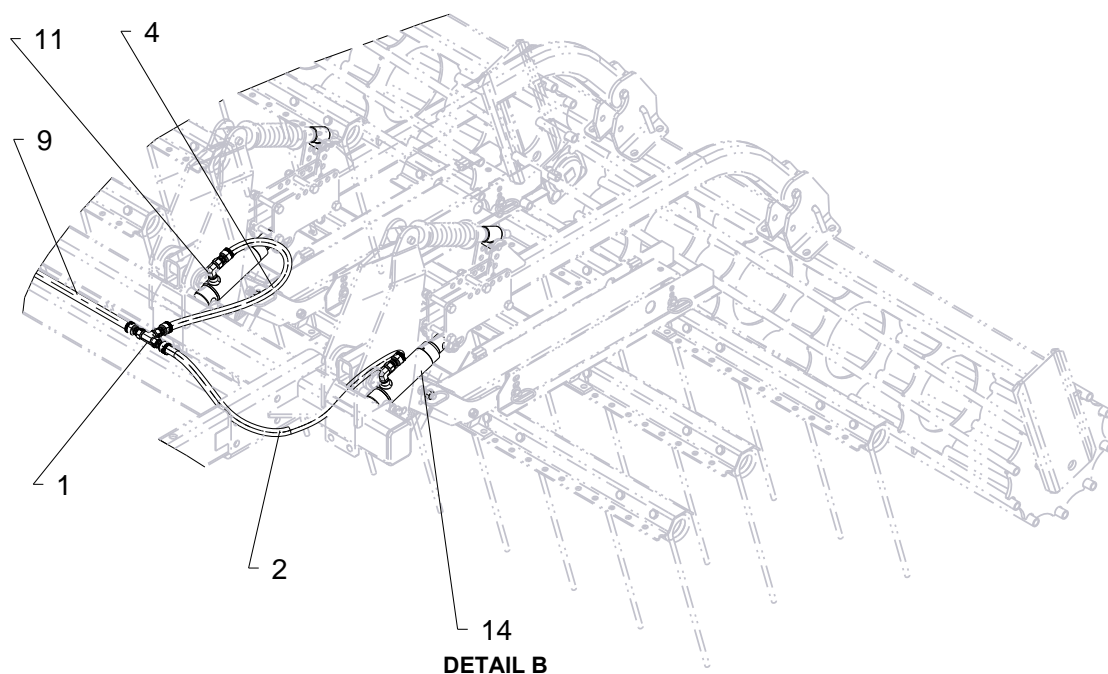
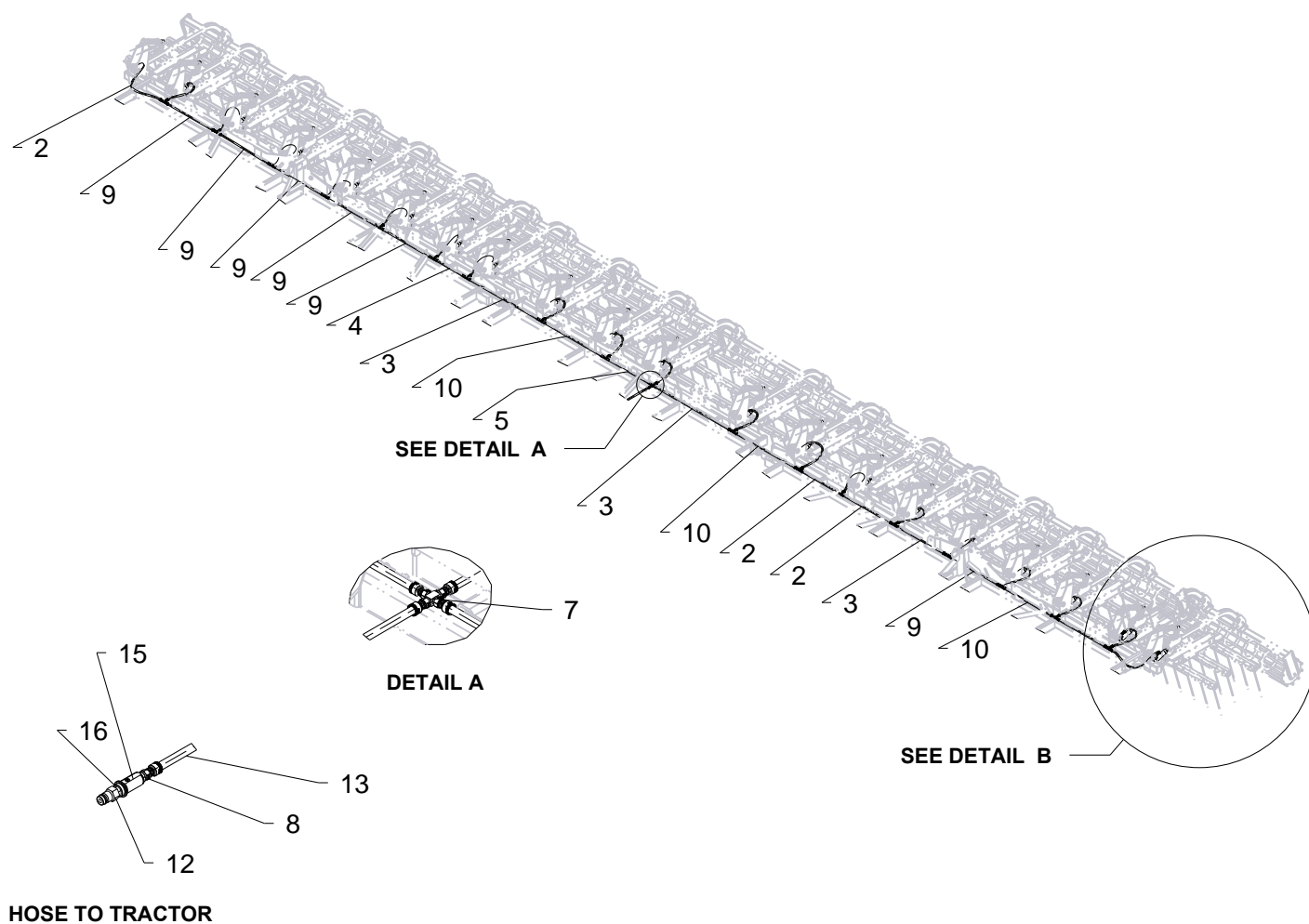

## 13 QX2/XL2 55-60' BASKET HYDRAULICS

ITEM	PART NO.	DESCRIPTION
1	P13238	TEE 8MJ X 8MJ X 8MJ
2	P13261	HSE 3KPSI 3/8X30 8FJX-8FJX
3	P13265	HSE 3KPSI 3/8X56 8FJX-8FJX
4	P13423	HSE 3KPSI 3/8X24 8FJX-8FJX
5	P14644	HSE 3KPSI 3/8X36 8FJX-8FJX
6	P14850	HSE 3KPSI 3/8X18 8FJX-8FJX
7	P15910	CROSS 8MJ X 8MJ X 8MJ X 8MJ
8	P24024	ADP 8MORB X 8MJ
9	P25597	HSE 3KPSI 3/8X40 8FJX-8FJX
10	P56539	HSE 3KPSI 3/8X50 8FJX-8FJX
11	P62437	ELB 8MJ X 6MORB
12	P247425	QUICK COUPLER 8 ORB
13	P247432	HSE 3KPSI 3/8X400 8FJX-8FJX
14	P333361	HYD CYL 1-3/4X4 WELDED
15	P334206	RED QD GRIP -8FORB PACK OF 2
16	P334210	-8MORB X -8MORB UNION







