

5800 SERIES CHISEL PLOW - 13FT MAIN FRAME ASSEMBLY - REAR HITCH W/HYDRAULIC WINCH

NOTE - SOME FRAME COMPONENTS OR REAR ATTACHMENTS MAY NEED TO BE REPOSITIONED TO ALLOW MOUNTING OF THIS HITCH.

ITEM	QTY	NAME	DESCRIPTION
1	2	235755	REAR HITCH TUBE
2	2	237424	WINCH STRAP
3	1	223710	WINCH TIE STRAP
4	6	88600	BLT HEX 3/4-10NCX6-1/2 8YZ
5	2	88131	WSHR FLAT 3/4(13/16X2ACT) Z
6	8	88293	BLT HEX 3/4-10NCX6 5Z
7	1	223709	WINCH MOUNT BRACKET - RIGHT
8	2	233375	HITCH TUBE MOUNT
9	1	240414	HORSCH ANDERSON WINCH
10	2	235800	HITCH MOUNT - SHORT
11	1	223705	WINCH MOUNT BRACKET - LEFT
12	2	88197	HYDH RDCNG BSHG3/4TO1/2NPT
13	4	13236	ELB 8MJ X 8MPT
14	2	88409	BLT HEX 5/8-11NCX2-1/2 5Z
15	24	88126	NUT HEX 5/8-11NC 5Z
16	24	88129	WSHR HLK 5/8ID(11/16ACT) Z
17	1	223712	VALVE MOUNT STRAP
18	2	25580	ELB 8MORB X 8MJ
19	1	240415	ANDERSON HYD WINCH VALVE
20	1	88503	BLT-U 5/8-11NCX3X5-1/4 Z
21	2	88411	BLT HEX 3/8-16NCX4 5Z
22	2	88162	NUT 2POS LK 3/8-16NC 5P
23	14	88110	NUT HEX 3/4-10NC 5Z
24	14	88130	WSHR HLK 3/4ID(13/16ACT) Z
25	4	88294	BLT HEX 5/8-11NCX2 5Z
26	2	233372	TUBE STRAP
27	8	88145	BLT-U 5/8-11NCX4X5-1/4 Z
28	1	233528	13FT MAIN FRAME-5800 CP

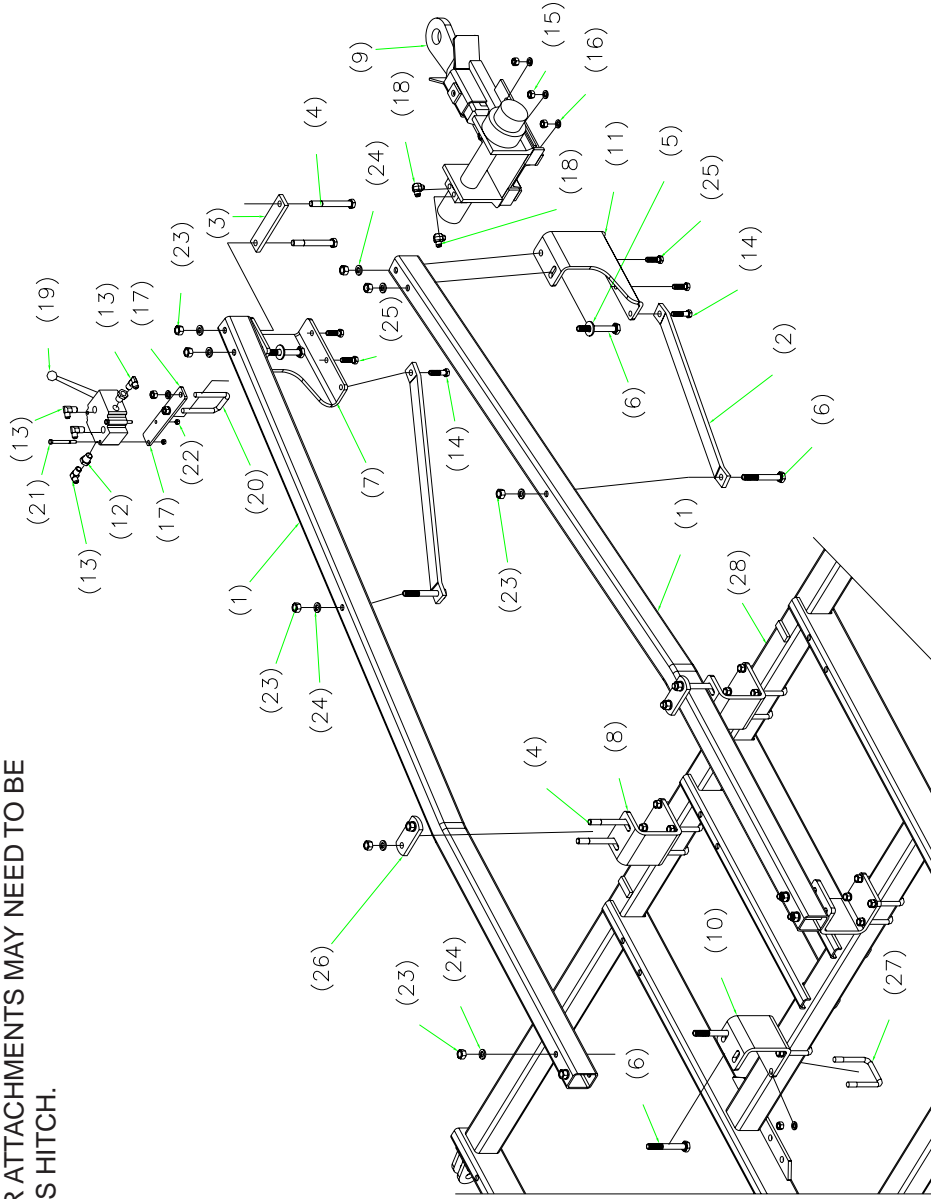

Loosely mount the hitch mount brackets (8)&(10) to the frame tubes as shown. Position the rear hitch tubes (1) on top of the mount brackets and loosely attach with the hardware noted. Bolt the left and right winch mount brackets (7)&(11) under the hitch tubes, using the tie strap (3) to tie tubes together. Bolt the winch straps (2) under the hitch tubes and loosely secure the winch brackets. Measure a common point on the hitch tubes to common point on the frame corners and center the hitch on the frame. Slide the winch into position and once all major components have been positioned tighten all hardware.

Mount the hydraulic control valve strap (17) to the top of the right hitch tube, assemble the noted hydraulic fittings to the valve and mount the valve (19) on the strap. Run the hydraulic supply hoses from the tractor to the top ports of the valve along the frame members and rear hitch tube and secure with nylon ties. Connect the short supply hoses from the valve body to the winch ports.

HOSE 3/8X18 - VALVE TO WINCH

HOSE 3/8X276 - TO TRACTOR

