

5830 REAR HITCH W/HINGED TONGUE ASSEMBLY INSTRUCTIONS

LOCATE THE HITCH MOUNTS AND PLACE ON REAR AND 2ND FRAME TUBE AS SHOWN. ATTACH THE REAR HITCH TUBES TO THE TUBE MOUNTS AND POSITION APPROXIMATELY AS SHOWN. MOUNT THE HITCH MOUNT (2) UNDER THE REAR HITCH TUBES AND SECURE WITH HARDWARE NOTED. LOCATE THE REAR HITCH IN THE CENTER OF THE FRAME BY MEASURING FROM A COMMON POINT ON THE REAR HITCH TUBES TO THE CORNERS OF THE MAIN FRAME. ONCE CENTERED ON THE UNIT, INSERT THE HINGE TONGUE ASSEMBLY AND SECURE ALL HARDWARE.

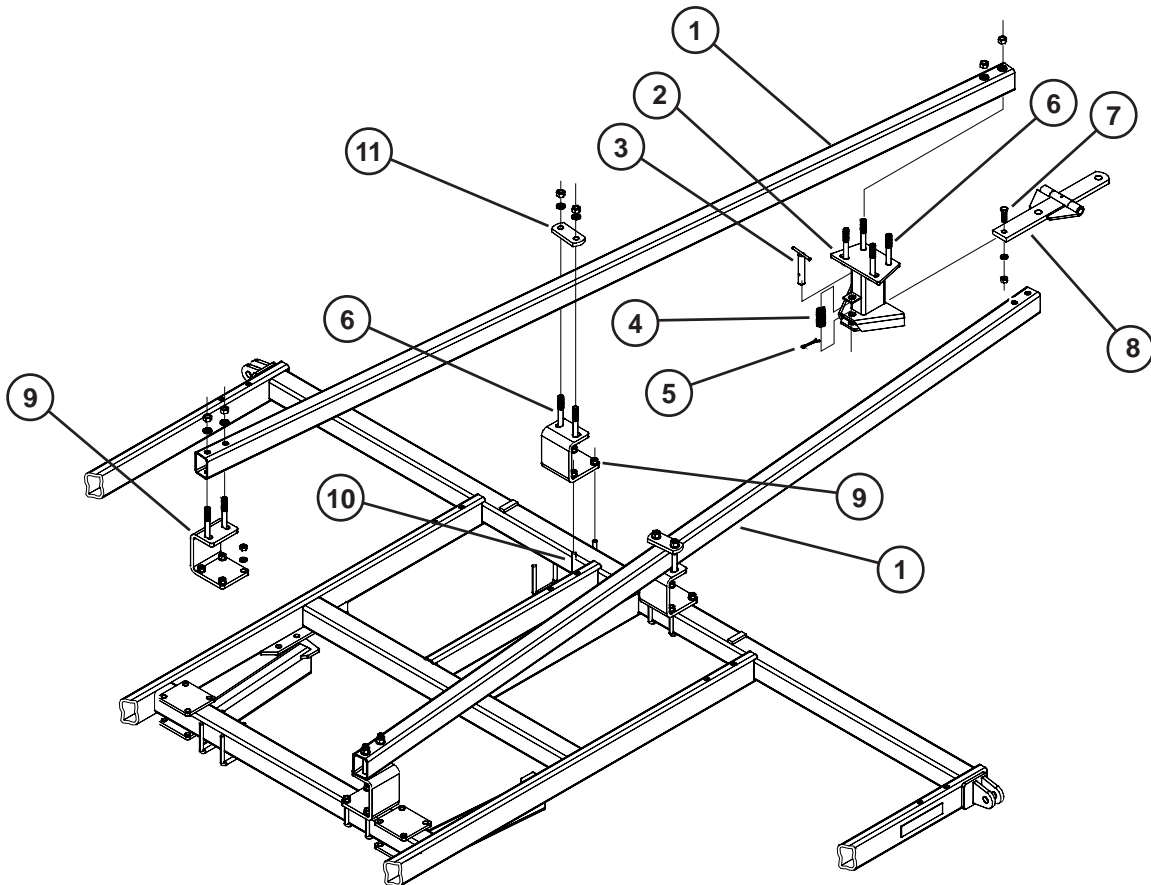

ITEM	PART NO.	DESCRIPTION
1	233371	REAR HITCH TUBE
2	58281	HITCH MOUNT
3	58284	HITCH PIN(1x2-27/32)
4	15940	SPRING
5	88101	COTTER PIN (1/4x2-1/2)
6	88293	3/4NCx6 GR5 BOLT
7	88294	5/8NCx2 GR5 BOLT
8	18443	HINGE TONGUE ASSEMBLY
9	233375	HITCH TUBE MOUNT
10	88145	5/8NCx4x5-1/4 U-BOLT
11	233372	TUBE STRAP

THIS HITCH FITS ONLY 5830 13FT MAIN FRAMES AND MAY PREVENT USE OF OTHER OPTIONS. FRAME PARTS SUCH AS WING RESTS OR ANY REAR ATTACHMENTS MAY HAVE TO BE REPOSITIONED TO MOUNT THIS HITCH.