



# ASSEMBLY INSTRUCTIONS

## 1400 SEEDBED FINISHER



**WIL-RICH**

PO Box 1030

Wahpeton, ND 58074

PH (701) 642-2621

Fax (701) 642-3372

[www.wil-rich.com](http://www.wil-rich.com)

**PERSONAL SAFETY IS IMPORTANT!**

ALL PERSONNEL INVOLVED WITH THE ASSEMBLY AND/OR OPERATION OF THIS EQUIPMENT MUST BE INFORMED OF PROPER SAFETY PROCEDURES. OPERATOR'S AND ASSEMBLY MANUALS PROVIDE THE NECESSARY INFORMATION. IF THE MANUAL IS LOST FOR A PARTICULAR IMPLEMENT, ORDER A REPLACEMENT AT ONCE. OPERATOR'S AND ASSEMBLY MANUALS ARE AVAILABLE AT NO CHARGE UPON REQUEST.

ADDRESS INQUIRIES TO:

WIL-RICH

PO BOX 1030

WAHPETON, ND 58074

PH (701)642-2621 FAX (701)642-3372

# ASSEMBLY INFORMATION

Remove all wires and arrange the parts conveniently.

**NOTE:** Always wear safety glasses or goggles and be careful when cutting wires and steel bands as they are under tension and will spring back when cut.

Whenever the terms "left" and "right" are used, it should be understood to mean from a position behind and facing the machine.

Lubricate all bearings and moving parts as you proceed and make sure they work freely.

Loosely install all bolts connecting mating parts before final tightening.

When tightening bolts, they should be torqued to the proper number of foot-pounds as indicated in the table unless specified. It is important that all bolts be kept tight.

On new machines, all nuts and bolts should be rechecked after a few hours of operation.

When replacing a bolt, use only a bolt of the same grade or higher.

Bolts with no markings are grade 2.

Grade 5 bolts furnished with the machine are identified by three radial lines on the head.

Grade 8 bolts furnished with the machine are identified by six radial lines on the head.

All U-bolts are grade 5.

## TORQUE IN FOOT POUNDS

| BOLT DIA     | 3/8  | 1/2 | 5/8   | 3/4   | 7/8    | 1     |
|--------------|------|-----|-------|-------|--------|-------|
| HEX HEAD     | 9/16 | 3/4 | 15/16 | 1-1/8 | 1-5/16 | 1-1/2 |
| UNC<br>GRADE | 2    | 18  | 45    | 89    | 160    | 320   |
|              | 5    | 30  | 68    | 140   | 240    | 544   |
|              | 8    | 40  | 100   | 196   | 340    | 792   |
| UNF<br>GRADE | 2    | 21  | 51    | 102   | 178    | 368   |
|              | 5    | 32  | 70    | 168   | 264    | 572   |
|              | 8    | 48  | 112   | 216   | 368    | 840   |

GRADE 8

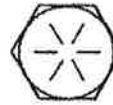

GRADE 5



GRADE 2

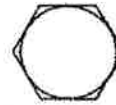

CI-75623



THIS SYMBOL IS USED TO CALL YOUR ATTENTION TO INSTRUCTIONS CONCERNING YOUR PERSONAL SAFETY. BE SURE TO OBSERVE AND FOLLOW THESE INSTRUCTIONS.

CI-77637

**CAUTION**

FAILURE TO FOLLOW THESE INSTRUCTIONS MAY RESULT IN PERSONAL INJURY AND/OR EQUIPMENT DAMAGE.

- JUST BEFORE AND DURING OPERATION BE SURE NO ONE IS ON OR AROUND THE IMPLEMENT.
- BEFORE LOWERING THE WINGS FOR THE FIRST TIME, MAKE SURE THE ENTIRE SYSTEM HAS BEEN CHARGED WITH OIL.
- BEFORE ACTIVATING THE HYDRAULIC SYSTEM, CHECK HOSES FOR PROPER CONNECTIONS.
- WITH WINGS DOWN ALWAYS INSTALL HYDRAULIC CYLINDER CHANNEL LOCK(S) FOR TRANSPORTING.

49165

# MAIN FRAME ASSEMBLY

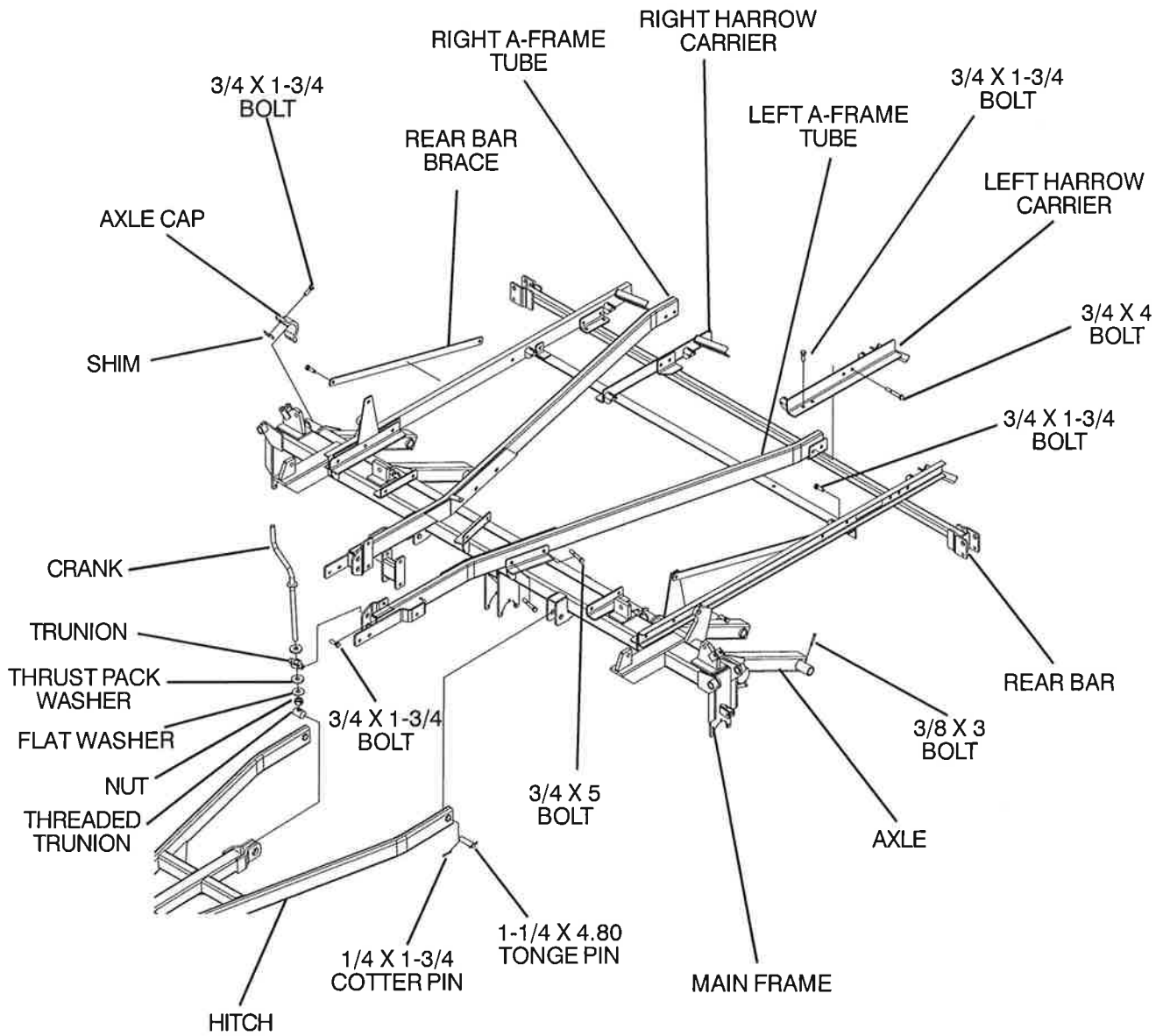

# HITCH ATTACHMENTS

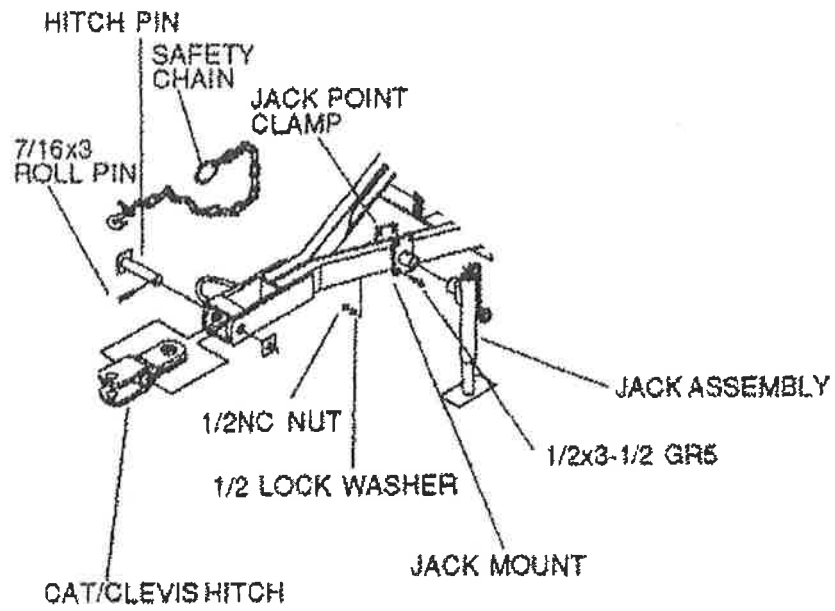

# 19'3" & 25'10" WING

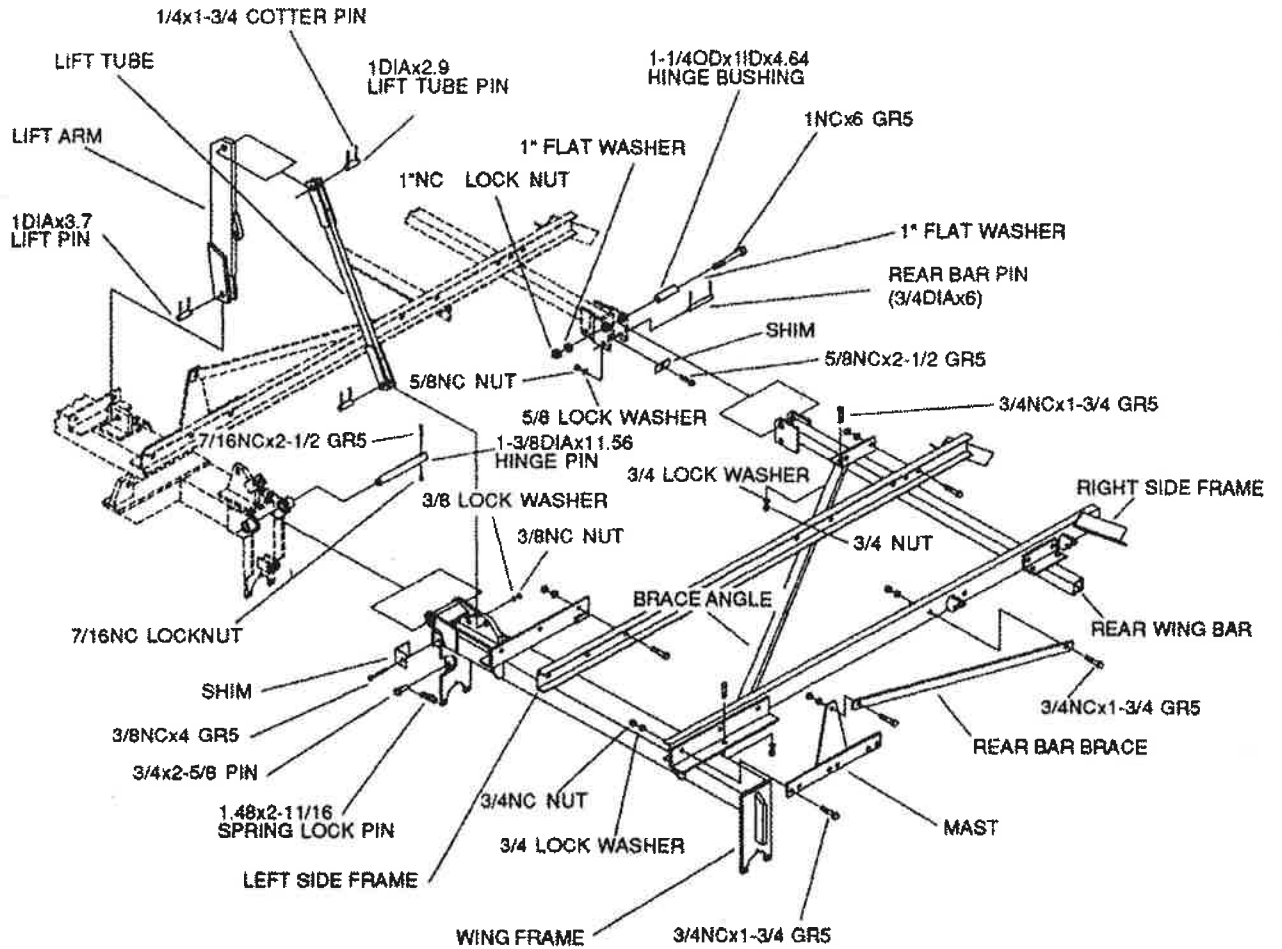

CI - 77880

**! WARNING**

TO AVOID INJURY FROM MACHINE FALLING

Before servicing or transporting, lock wheel frame in raised position with channel lock and pin.

# MAIN LIFT PLUMBING

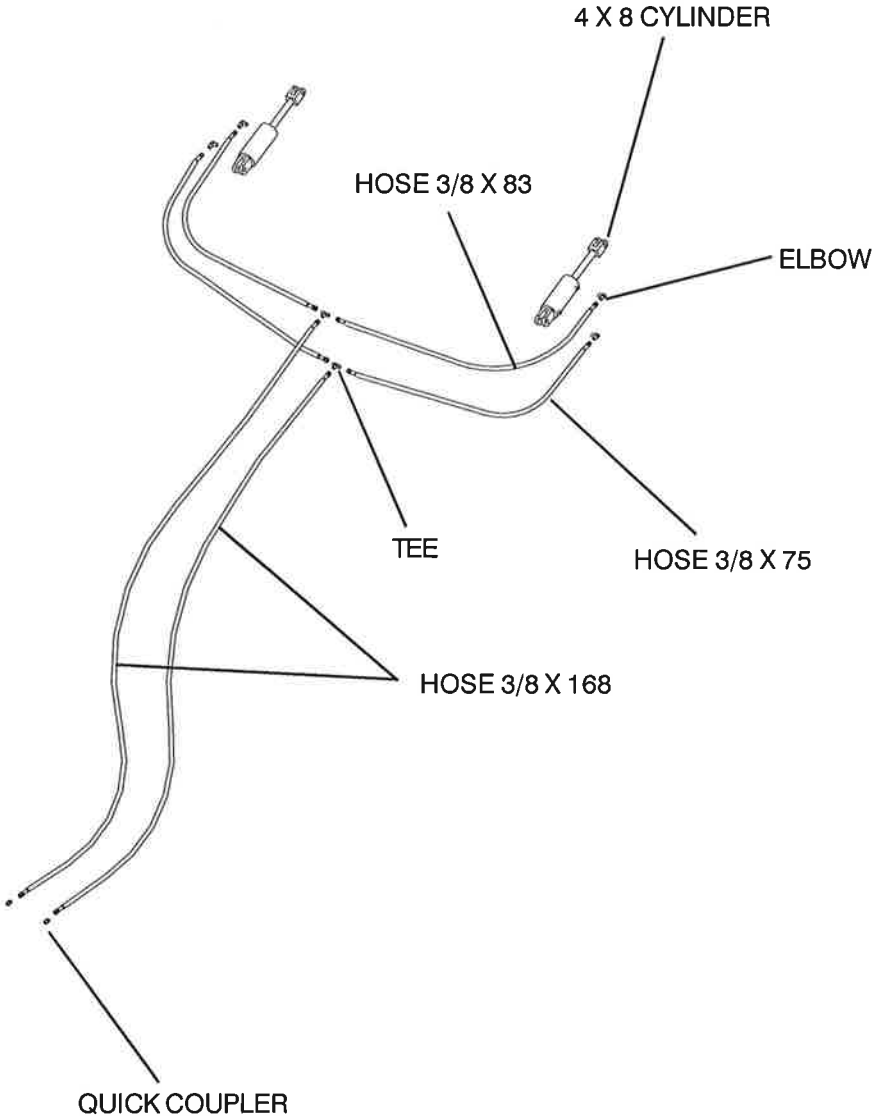

# FOLD PLUMBING

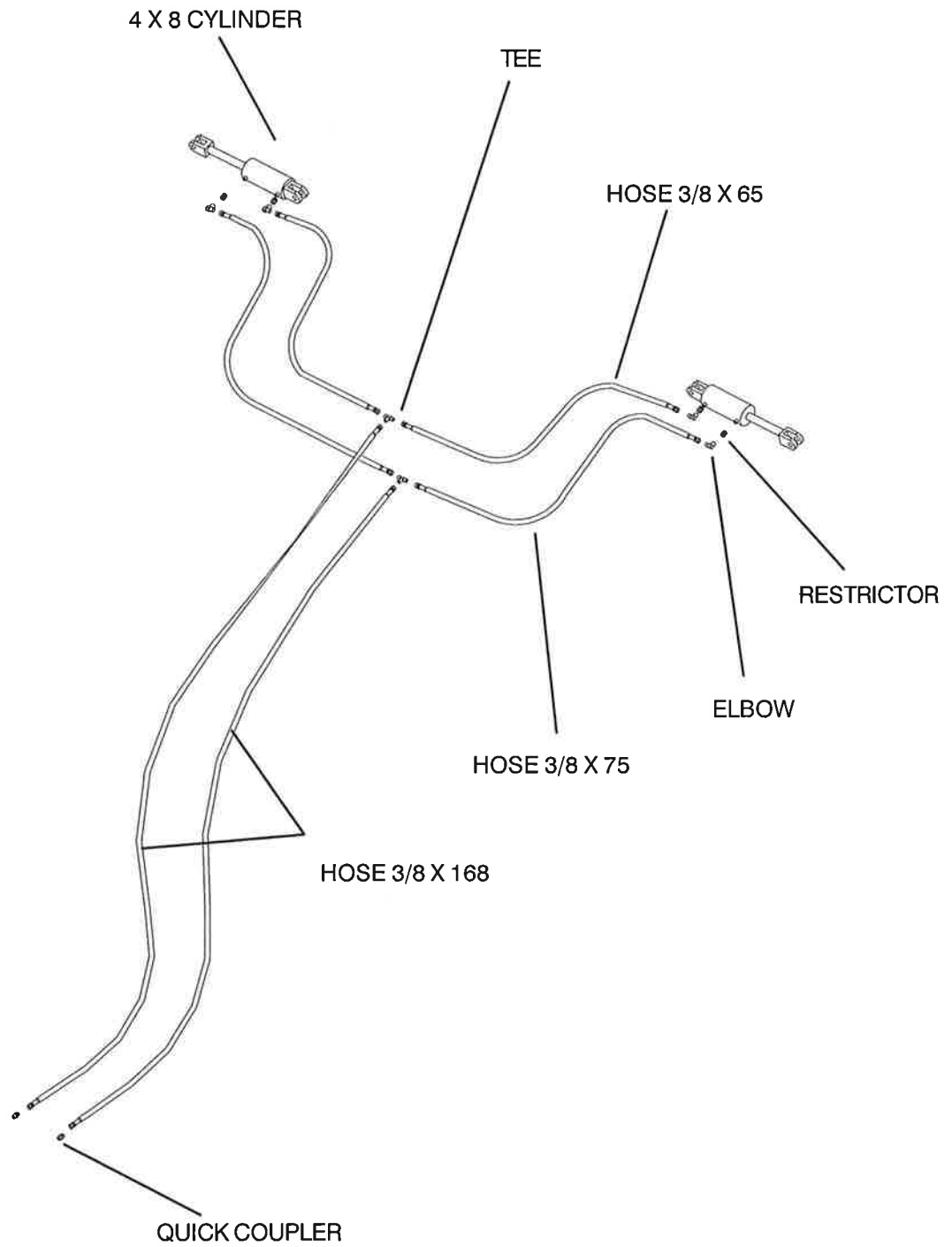



# SPIKE TOOTH HARROW

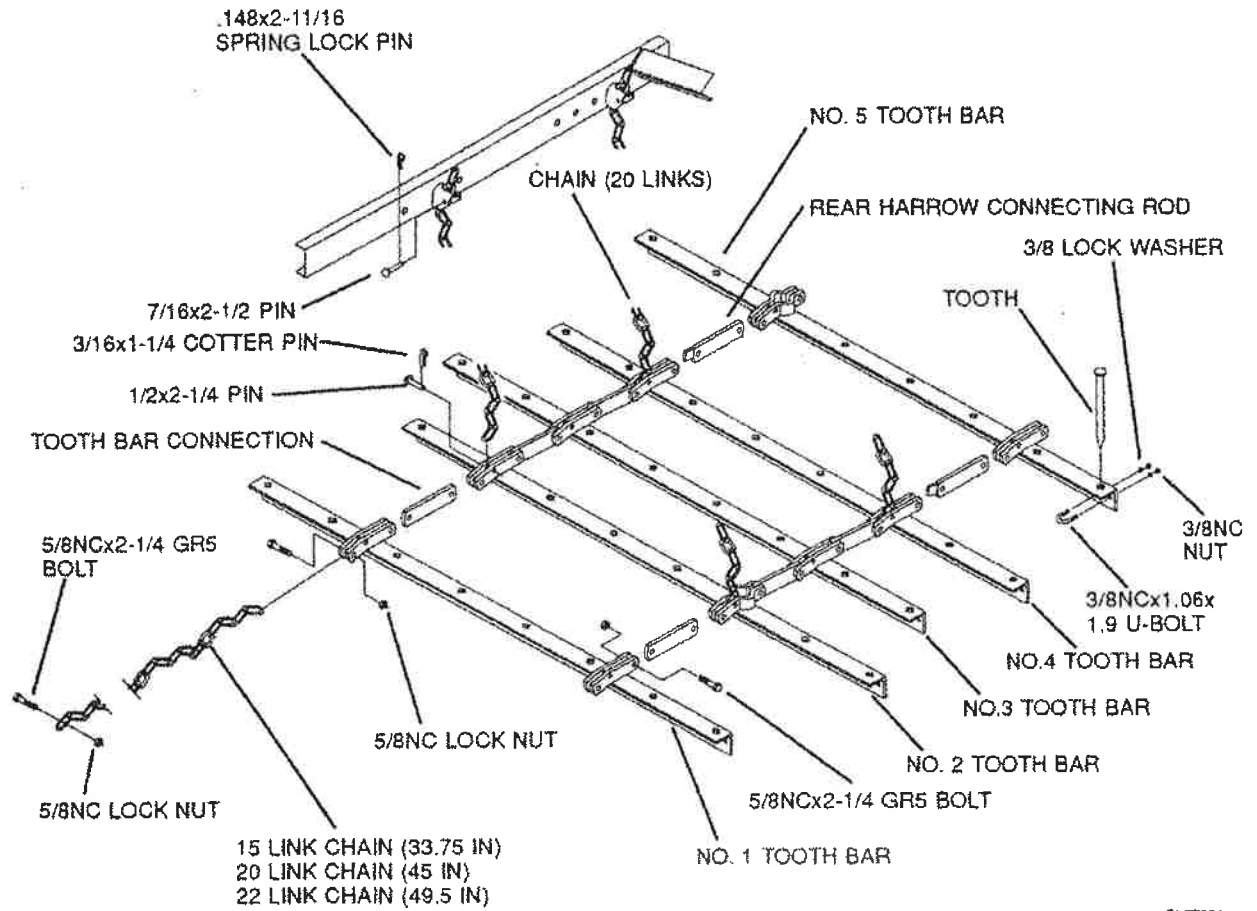

CI-77881

# REEL

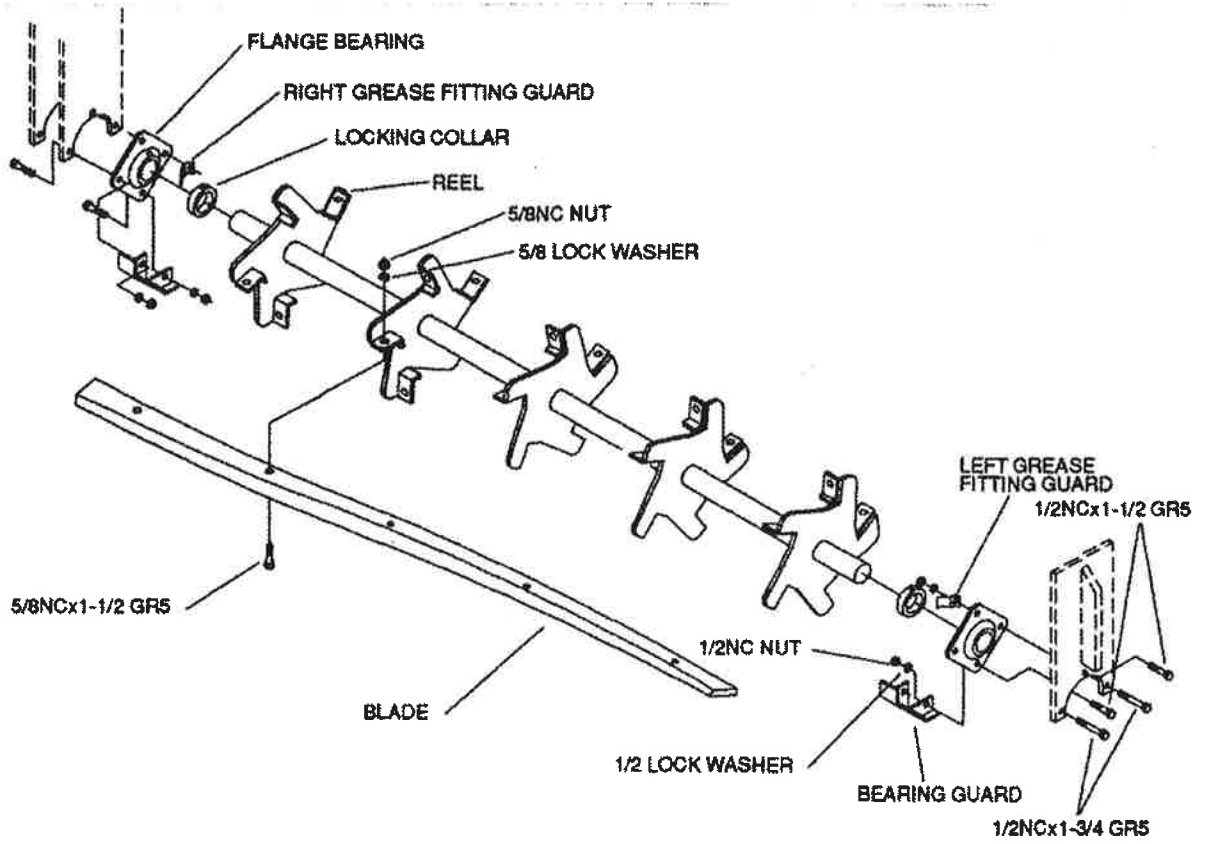

CI-77874

## 4 BOLT HUB & SPINDLE

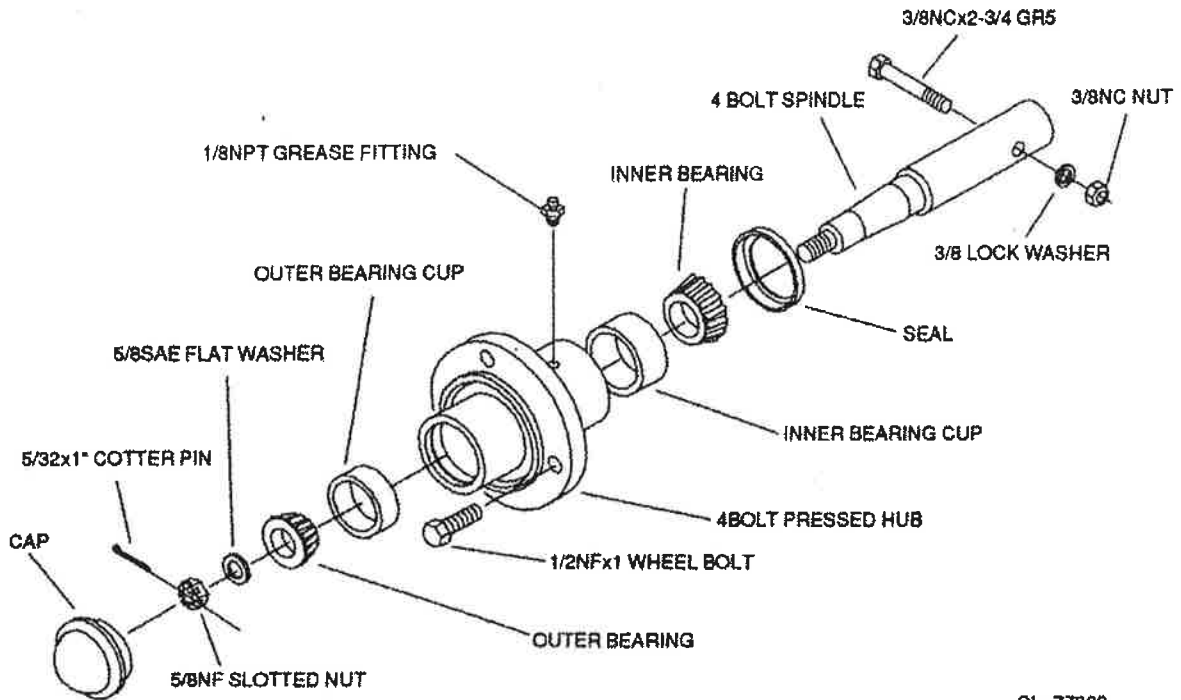

CI - 77883

## 6 BOLT HUB & SPINDLE

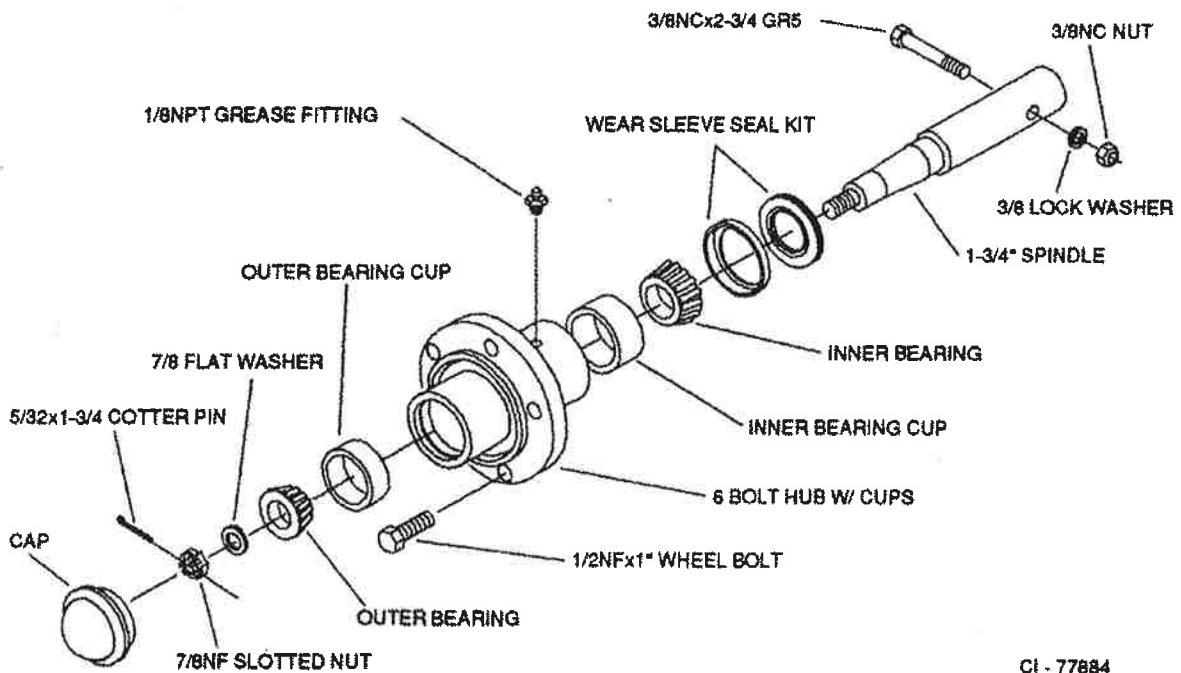

CI - 77884

# RIGID GAUGE WHEEL

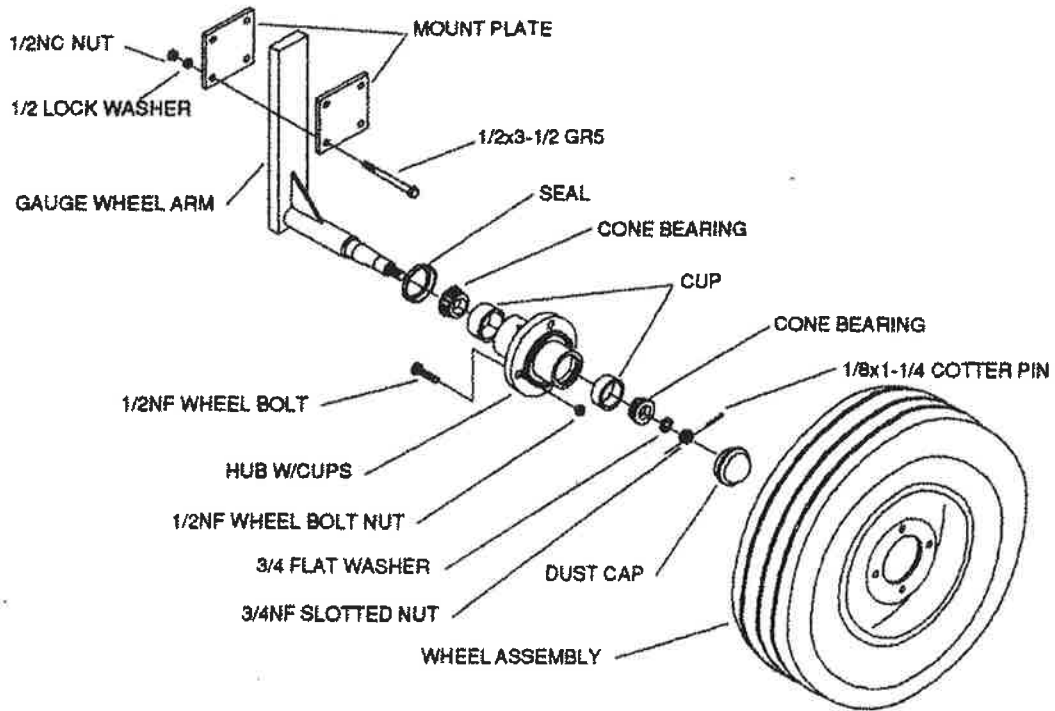

CI-77890

# LEVELING BOARD

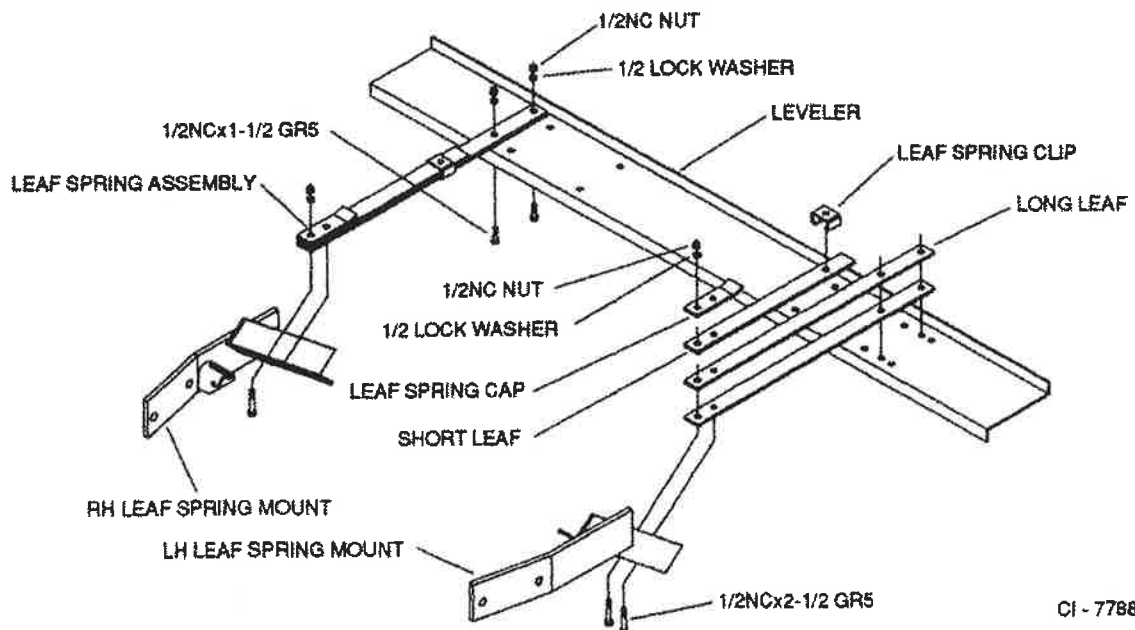

CI - 77882

# MAIN FRAME SHANK ATTACHMENT

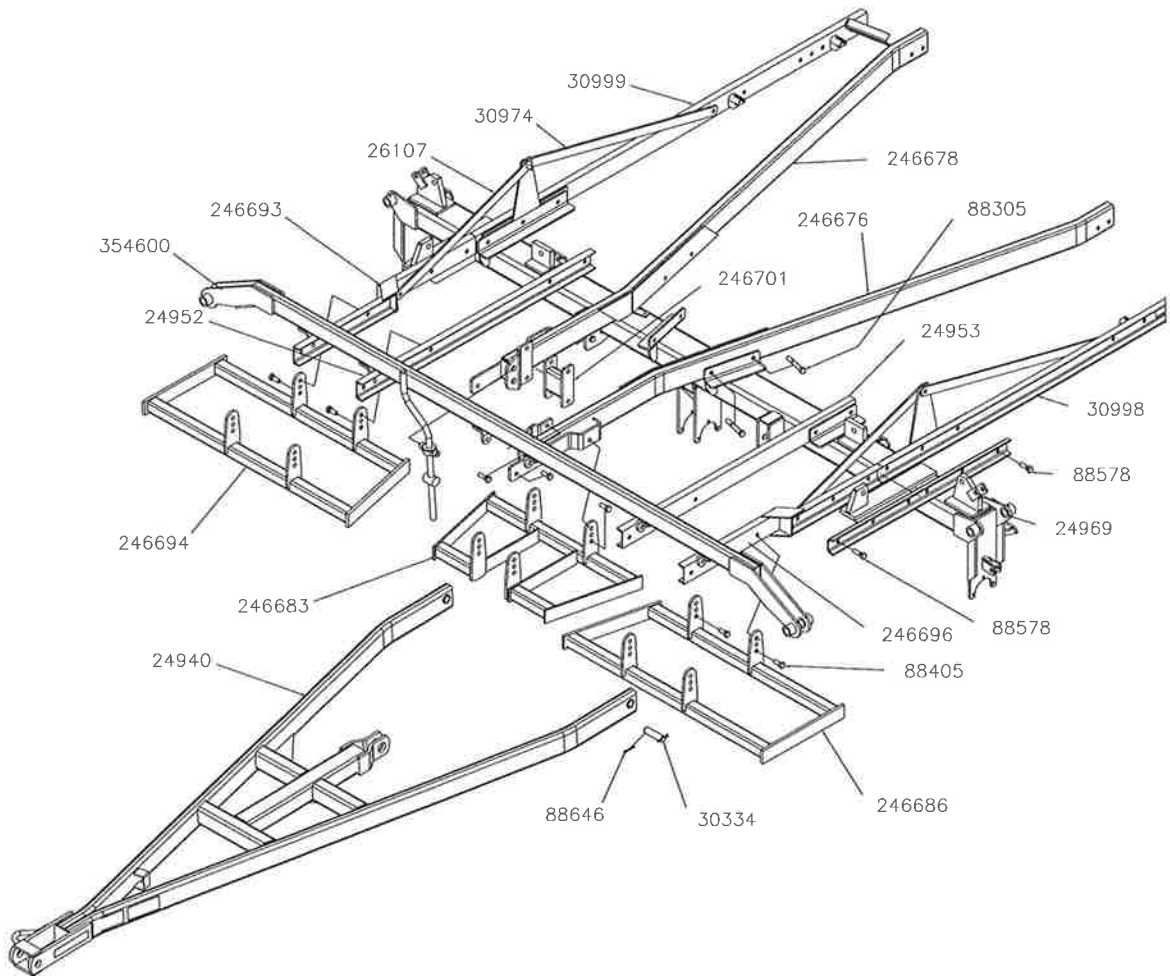

| PART NO. | DESCRIPTION               | PART NO. | DESCRIPTION                   |
|----------|---------------------------|----------|-------------------------------|
| 246701   | MAIN HITCH STUB RED       | 88305    | BLT HEX 3/4-10NCX5 5Z         |
| 246696   | CHANNEL - LEFT INNER      | 30999    | RIGHT SIDE FRAME (RED)        |
| 246694   | RIGHT MAIN SHANK MOUNT    | 30998    | LEFT SIDE FRAME (RED)         |
| 246693   | CHANNEL - RIGHT INNER     | 30974    | REAR BAR BRACE (RED)          |
| 246686   | LEFT MAIN SHANK MOUNT     | 30334    | HEADLESS PIN(2) 1-1/4X3-23/32 |
| 246683   | CENTER SHANK MOUNT        | 26107    | BRACE (RED)                   |
| 246678   | A-FRAME TUBE - RIGHT      | 25788    | MAST (RED)                    |
| 246676   | A-FRAME TUBE - LEFT       | 24969    | CENTER FRAME (25FT10IN) (RED) |
| 88646    | PIN COT 1/4DIAX1-3/4 Z    | 24953    | LEFT CHANNEL (63IN) (RED)     |
| 88578    | BLT HEX 3/4-10NCX2-1/4 5Z | 24952    | RIGHT CHANNEL (63IN) (RED)    |
| 88405    | BLT HEX 3/4-10NCX1-3/4 5Z | 24940    | TONGUE ASSEMBLY (RED)         |
| 354600   | FRAME TUBE                |          |                               |

# WING FRAME SHANK ATTACHMENT

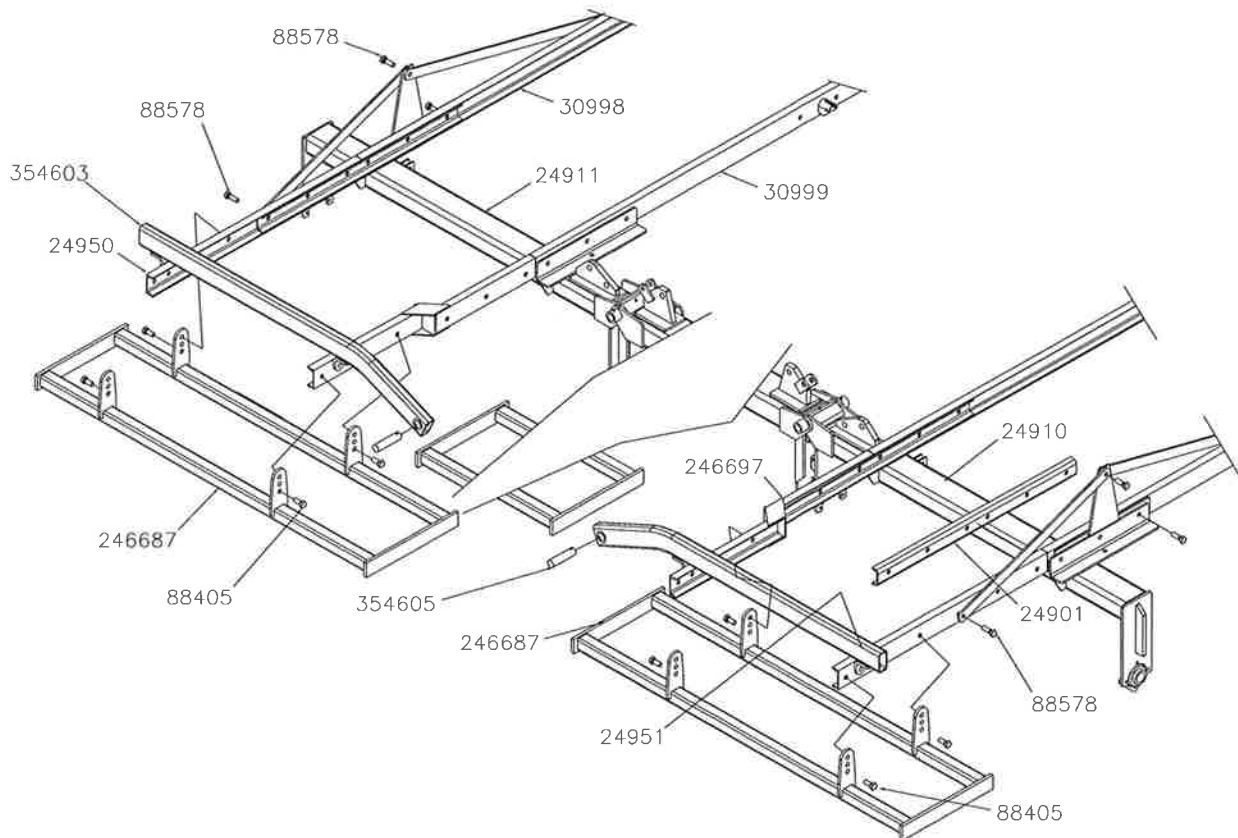

| PART NO. | DESCRIPTION               |
|----------|---------------------------|
| 246687   | OUTER WING SHANK MOUNT    |
| 246697   | CHANNEL - LEFT OUTER      |
| 246698   | CHANNEL - RIGHT OUTER     |
| 24901    | CONNECTOR (RED)           |
| 24910    | LEFT WING ASSEMBLY (RED)  |
| 24911    | RIGHT WING ASSEMBLY (RED) |
| 24950    | LEFT CHANNEL (RED)        |
| 24951    | RIGHT CHANNEL (RED)       |
| 30998    | LEFT SIDE FRAME (RED)     |
| 30999    | RIGHT SIDE FRAME (RED)    |
| 88405    | BLT HEX 3/4-10NC1-3/4 5Z  |
| 88578    | BLT HEX 3/4-10NC2-1/4 5Z  |
| 354603   | WING FRAME TUBE           |
| 354605   | PIN                       |

# SHANK FRAME ATTACHMENT SHANK PLACEMENT

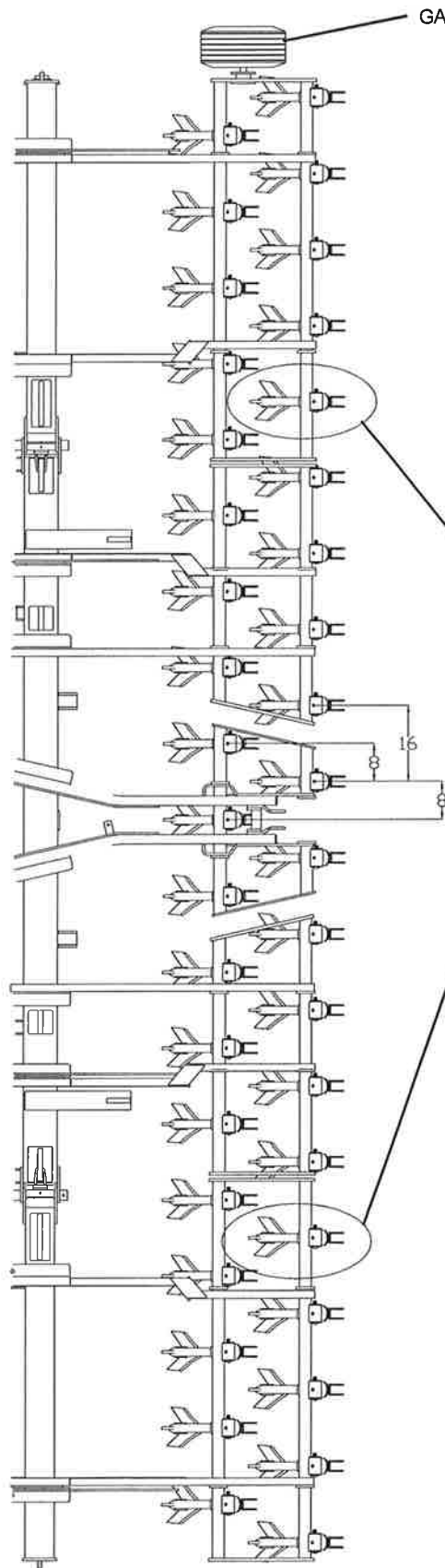

GAGE WHEEL MOUNTING LOCATION

AFTER ASSEMBLY OF FRONT SHANK ATTACHMENTS LOCATE SHANKS ON AN 8" PATTERN AS SHOWN. IF GAGE WHEEL OPTION IS CHOSEN LOCATE WHEEL ON OUTER WING ATTACHMENT FRAMES AS SHOWN.

USE SPACER SHOWN BELOW IN ONLY THESE TWO LOCATIONS

## SINGLE SPRING SHANK

SHANK HOLDER

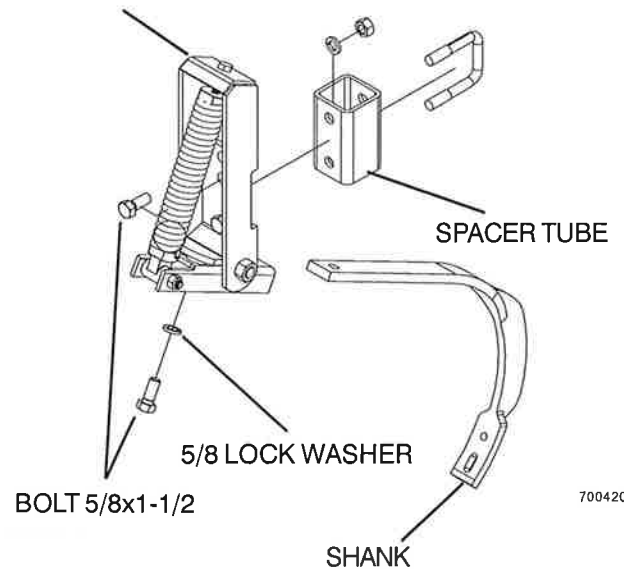

700420