

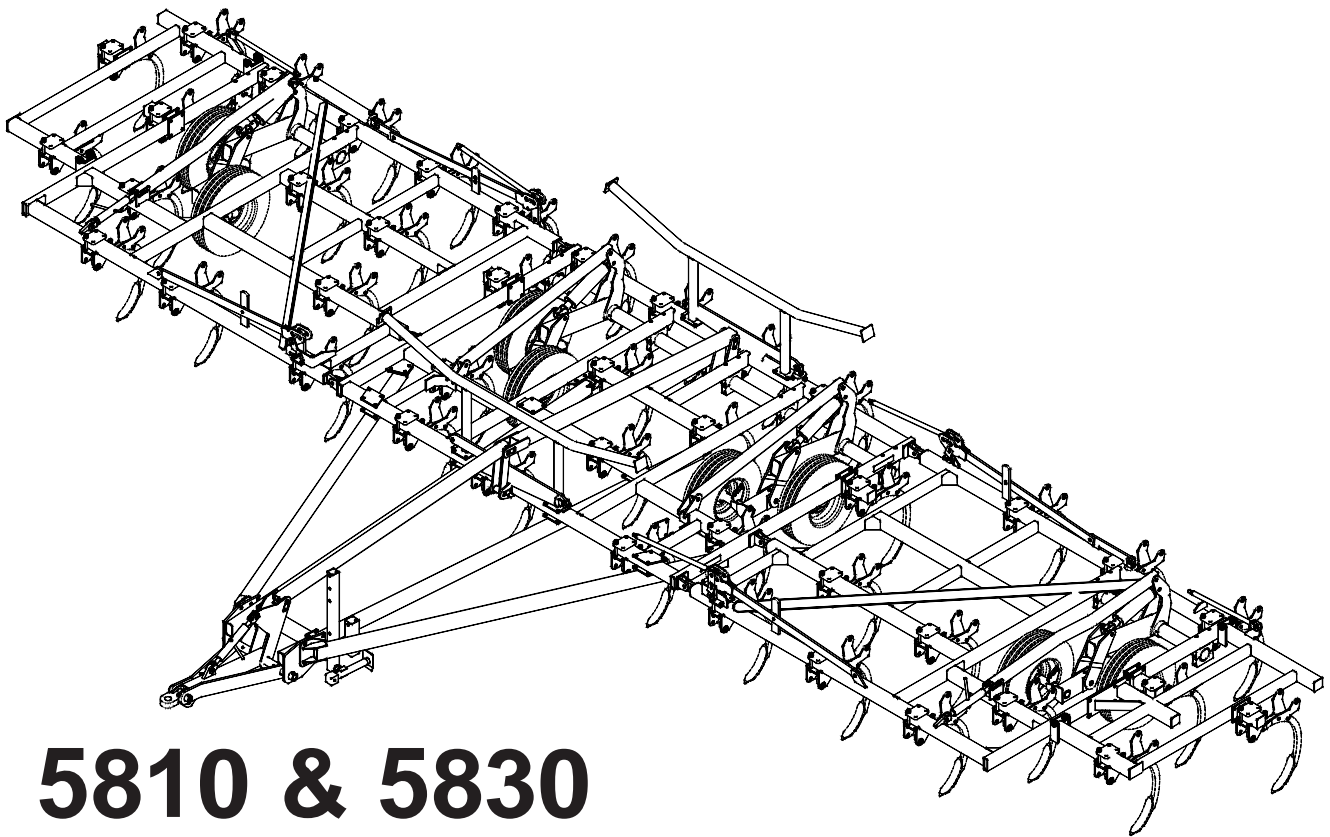

# ASSEMBLY MANUAL



## 5810 & 5830 LEVEL LIFT HITCH CHISEL PLOW

Printed in USA (74244A) 9/09

FOR UNITS BUILT AFTER JAN 1, 2009

 WIL-RICH

PO Box 1030  
Wahpeton, ND 58074  
PH (701) 642-2621  
Fax (701) 642-3372

**PERSONAL SAFETY IS IMPORTANT!**

ALL PERSONNEL INVOLVED WITH THE ASSEMBLY AND/OR OPERATION OF THIS EQUIPMENT MUST BE INFORMED OF PROPER SAFETY PROCEDURES. OPERATOR'S AND ASSEMBLY MANUALS PROVIDE THE NECESSARY INFORMATION. IF THE MANUAL IS LOST FOR A PARTICULAR IMPLEMENT, ORDER A REPLACEMENT AT ONCE. OPERATOR'S AND ASSEMBLY MANUALS ARE AVAILABLE AT NO CHARGE UPON REQUEST.

ADDRESS INQUIRIES TO:

WIL-RICH

PO BOX 1030

WAHPETON, ND 58074

PH (701)642-2621 FAX (701)642-3372

## ASSEMBLY INFORMATION

Remove all wires and arrange the parts conveniently.

NOTE: Always wear safety glasses or goggles and be careful when cutting wires and steel bands as they are under tension and will spring back when cut.

Wherever the terms "left" and "right" are used, it must be understood to mean from a position behind and facing the machine.

Lubricate all bearings and moving parts as you proceed and make sure they work freely.

Loosely install all bolts connecting mating parts before final tightening.

When tightening bolts, they must be torqued to the proper number of foot-pounds as indicated in the table unless specified. It is important that all bolts be kept tight.

On new machines, all nuts and bolts must be re-checked after a few hours of operation.

When replacing a bolt, use only a bolt of the same grade or higher. Except in shear bolt applications, where you must use the same grade bolt.

Bolts with no markings are grade 2

Grade 5 bolts furnished with the machine are identified by three radial lines on the head.

Grade 8 bolts furnished with the machine are identified by six radial lines on the head.

All U-bolts are grade 5.



THIS SYMBOL USED TO CALL YOUR ATTENTION TO INSTRUCTIONS CONCERNING YOUR PERSONAL SAFETY. BE SURE TO OBSERVE AND FOLLOW THESE INSTRUCTIONS

	GRADE 2			GRADE 5			GRADE 8		
TORQUE IN FOOT POUNDS									
BOLT DIA	3/8	1/2	5/8	3/4	7/8	1			
HEX HEAD	9/16	3/4	15/16	1-1/8	1-5/16	1-1/2			
UNC GR2	18	45	89	160	252	320			
UNC GR5	30	68	140	240	360	544			
UNC GR8	40	100	196	340	528	792			
UNF GR2	21	51	102	178	272	368			
UNF GR5	32	70	168	264	392	572			
UNF GR8	48	112	216	368	792	840			

**⚠ CAUTION**

**TO AVOID INJURY AND/OR MACHINE DAMAGE:**

- Refer to Operator's Manual for safety instructions.
- Do not stand or climb on machine when operating.
- Use clean hazard flashers and SMV sign when transporting.
- Observe highway traffic regulations.

23325

**⚠ CAUTION**

**Failure to follow these instructions may result in personal injury and/or equipment damage.**

- **Just before and during operation be sure no one is on or around the implement.**
- **Before activating the hydraulic system, check hoses for proper connections.**
- **Before lowering the wings for the first time, make sure the entire system has been charged with oil.**
- **With wings down always install hydraulic cylinder channel lock(s) for transporting.**

54374

# 10FT MAIN FRAME

Note: Adequately support frame during assembly, (allow sufficient ground clearance for shank installation).

Note: See shank placement pages for correct locations of all add-on stubs.

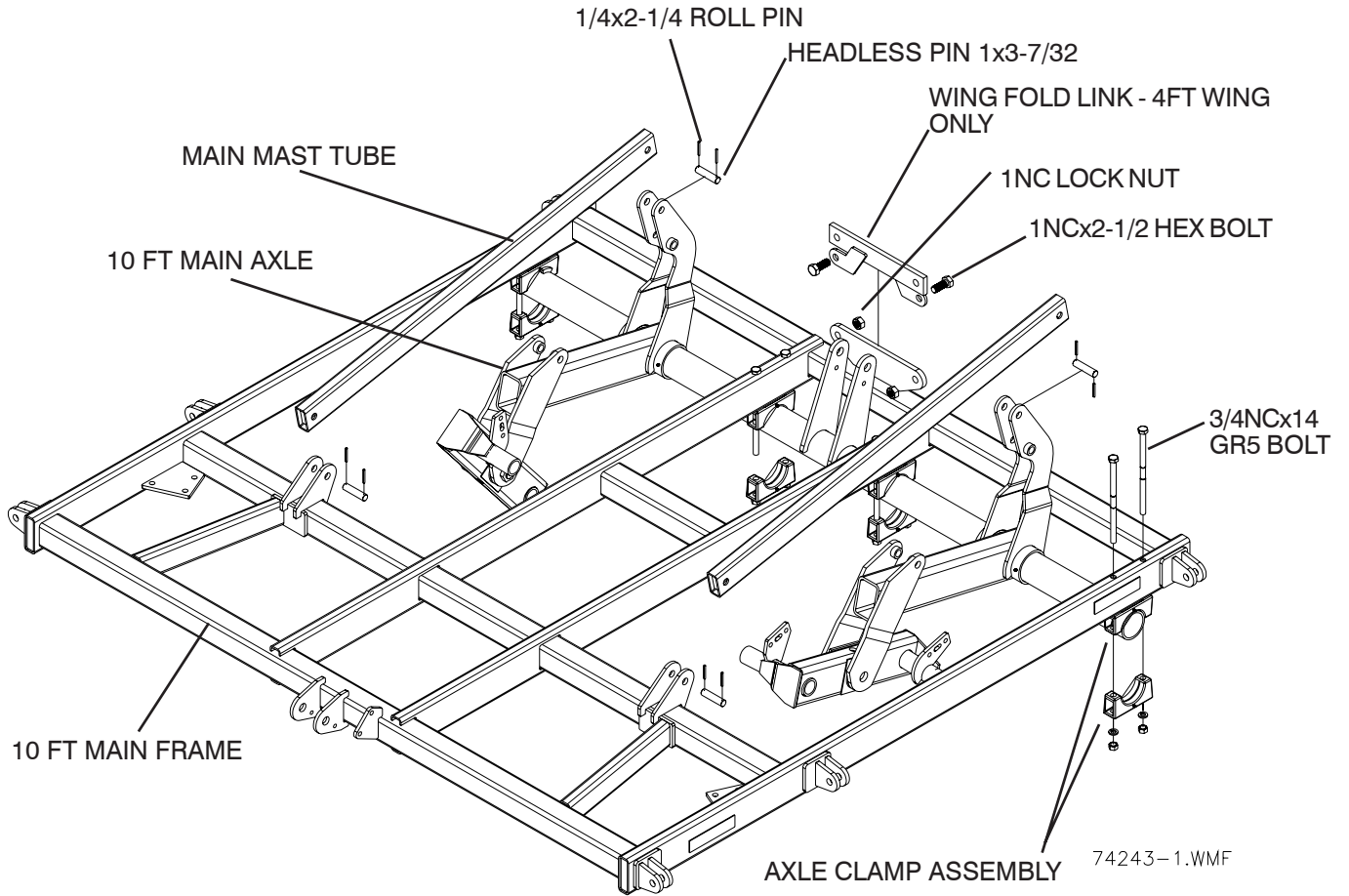

# 13FT MAIN FRAME

Note: See shank placement pages for correct locations of all add-on stubs.

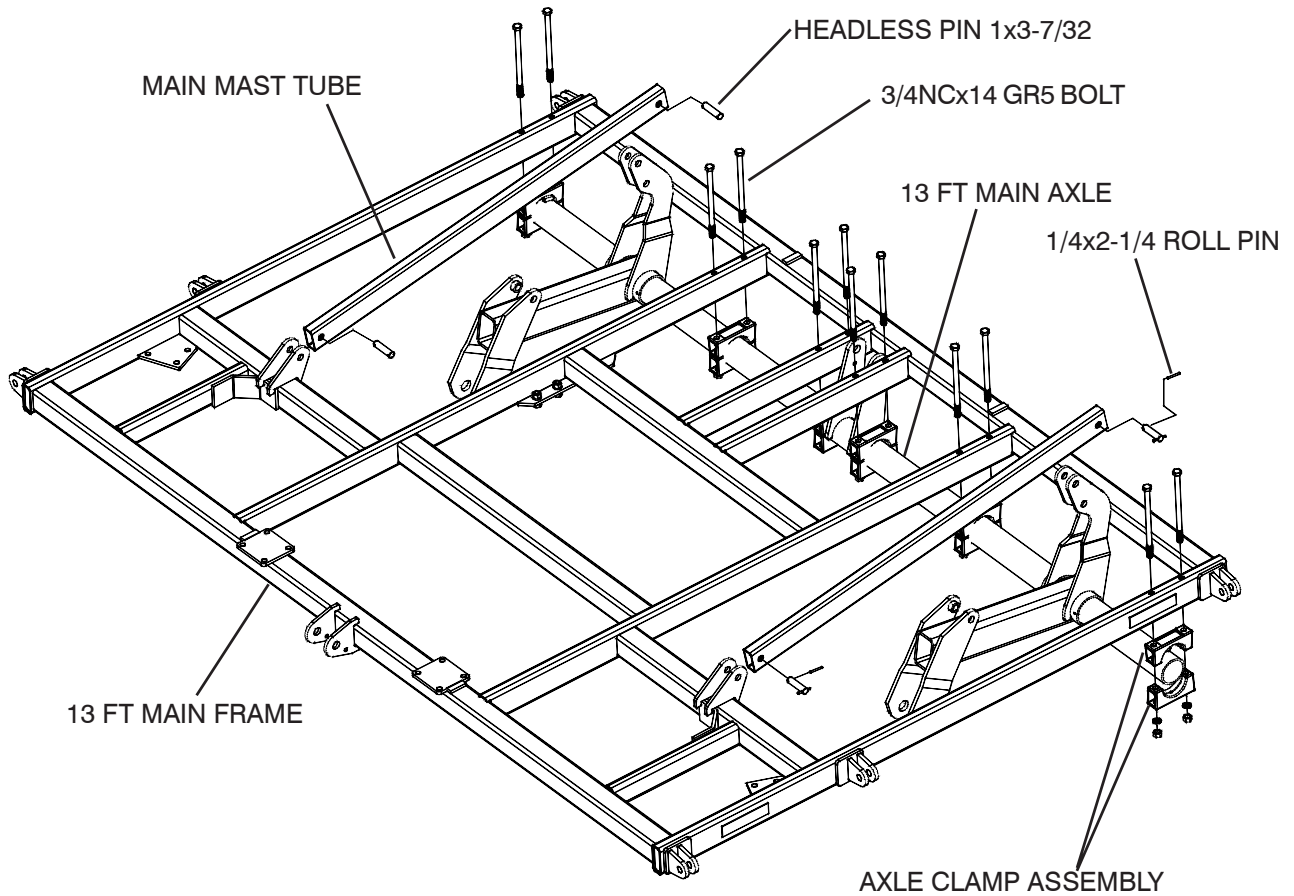

**⚠ CAUTION**

**TO AVOID INJURY AND/OR MACHINE DAMAGE:**

- Refer to Operator's Manual for safety instructions.
- Do not stand or climb on machine when operating.
- Use clean hazard flashers and SMV sign when transporting.
- Observe highway traffic regulations.

23325

# 5810 WING REST

**NOTE: WING REST ON FRONT OF MAIN FRAME MOUNTS ON TOP OF MAIN FRAME TUBING AND BOLTS INTO HITCH POLE PLATES.**

**NOTE: 4 ft WING REQUIRES NO WING REST. THE REST IS BUILT INTO THE WING SIDE OF THE HINGE.**

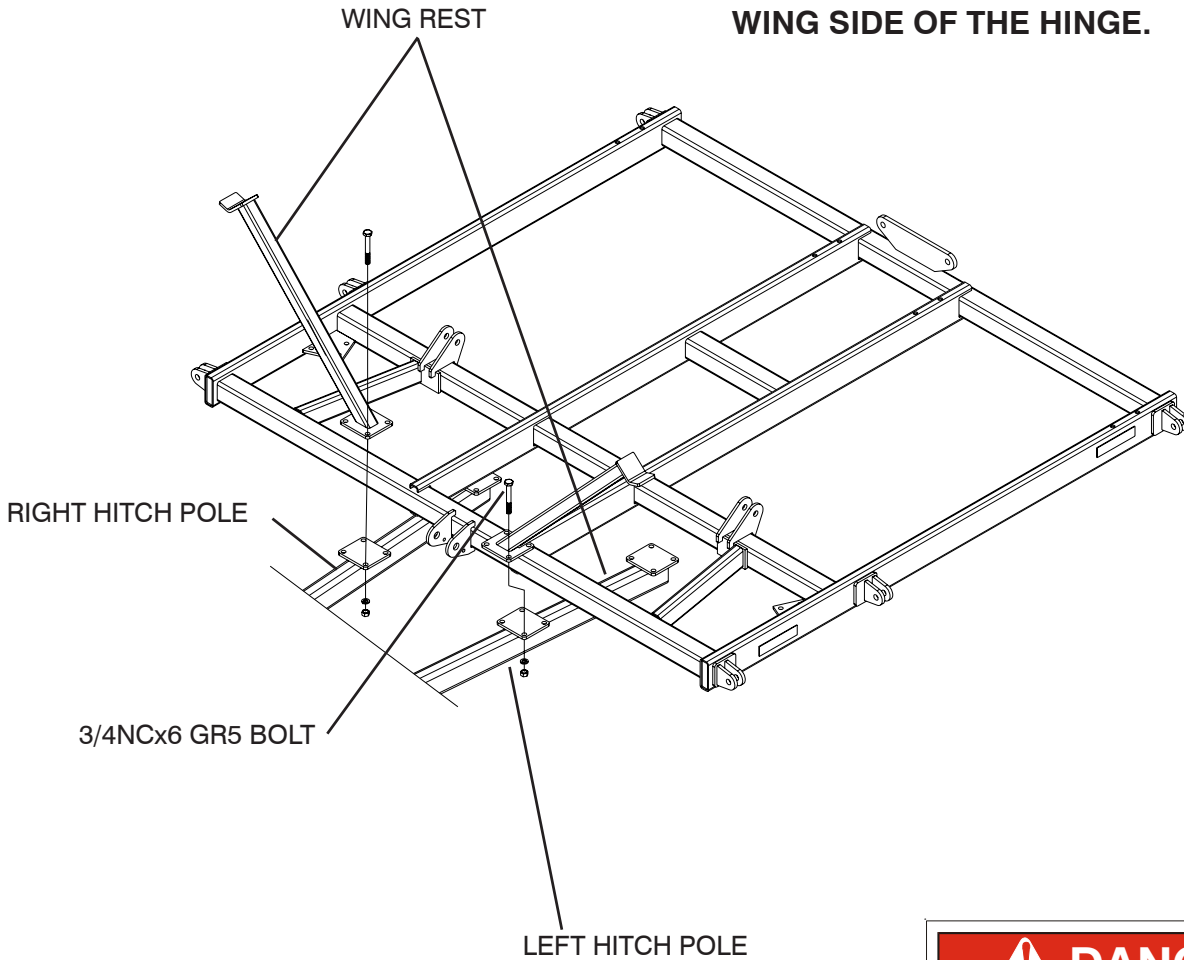

**⚠ DANGER**

A silhouette of a person is shown falling backwards, with a curved arrow indicating the path of a long, dark rectangular wing component falling from above towards the person's head.

**STAND CLEAR AT ALL TIMES:**

- Never walk or stand in the path of the wings.
- Completely lower wings before performing service or adjustments.
- Failure to do so will result in serious injury or death.

22128

# 5830 WING REST

**NOTE: WING REST ON FRONT OF MAIN FRAME MOUNTS ON TOP OF MAIN FRAME TUBING AND BOLTS INTO HITCH POLE PLATES.**

**NOTE: 6' WING USES 1 WING REST ON BACK OF IMPLEMENT.**

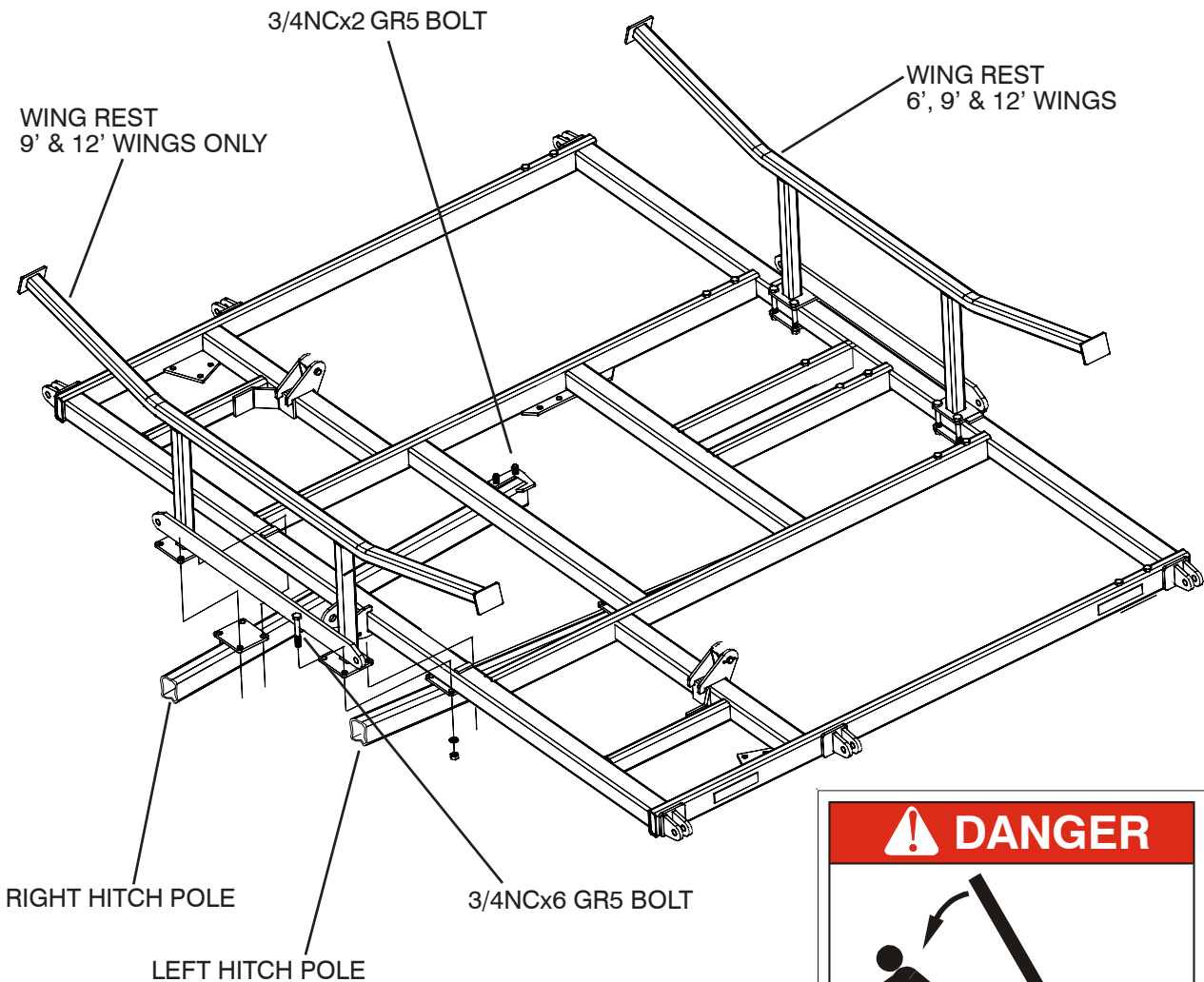

 **DANGER**



**STAND CLEAR AT ALL TIMES:**

- Never walk or stand in the path of the wings.
- Completely lower wings before performing service or adjustments.
- Failure to do so will result in serious injury or death.

22128

# 10FT & 13FT PIVOT HITCH

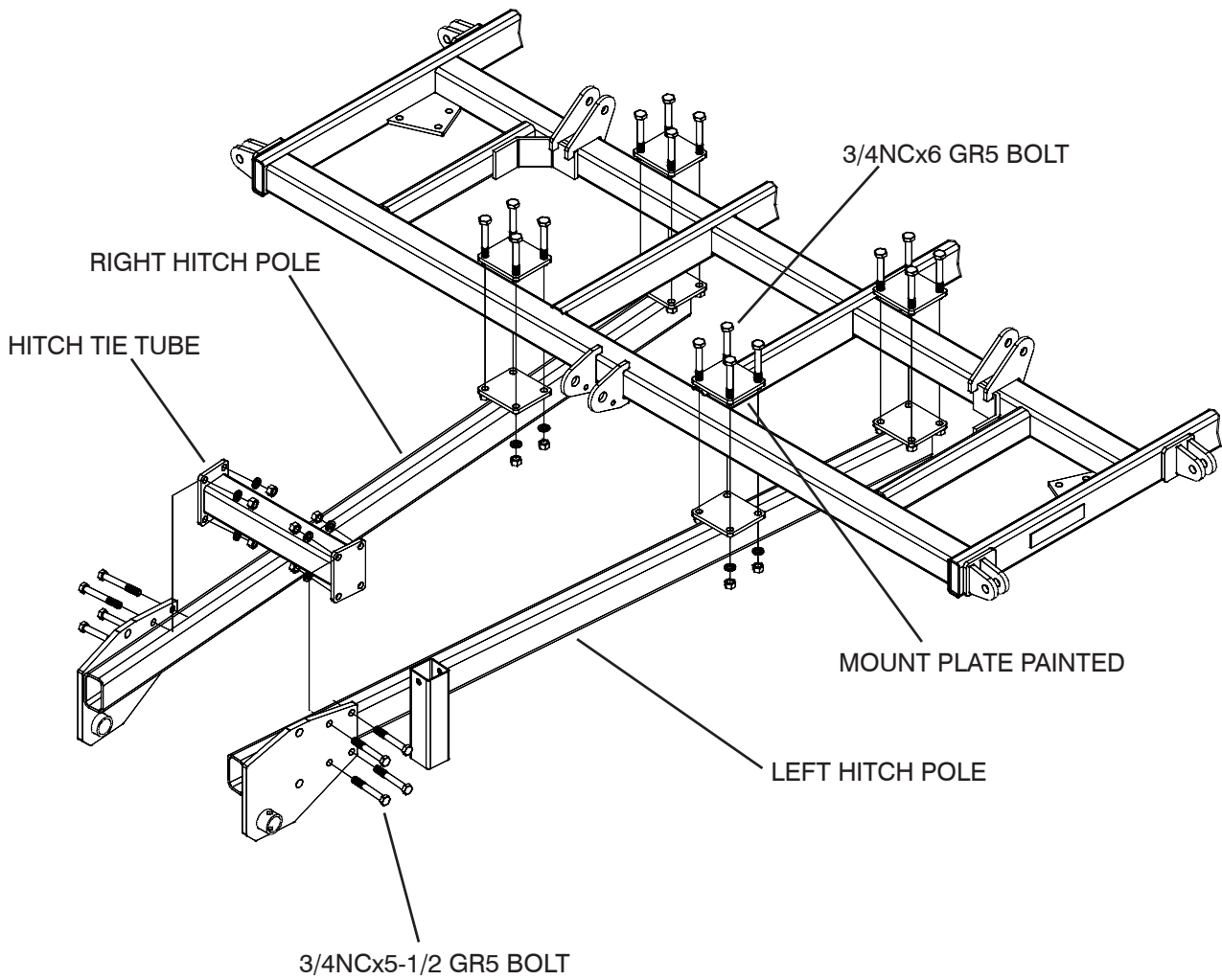

**NOTE: SEE PAGE 9 FOR CONTINUED  
PIVOT HITCH ASSEMBLY**



# 10FT & 13FT PIVOT HITCH (CONTINUED)

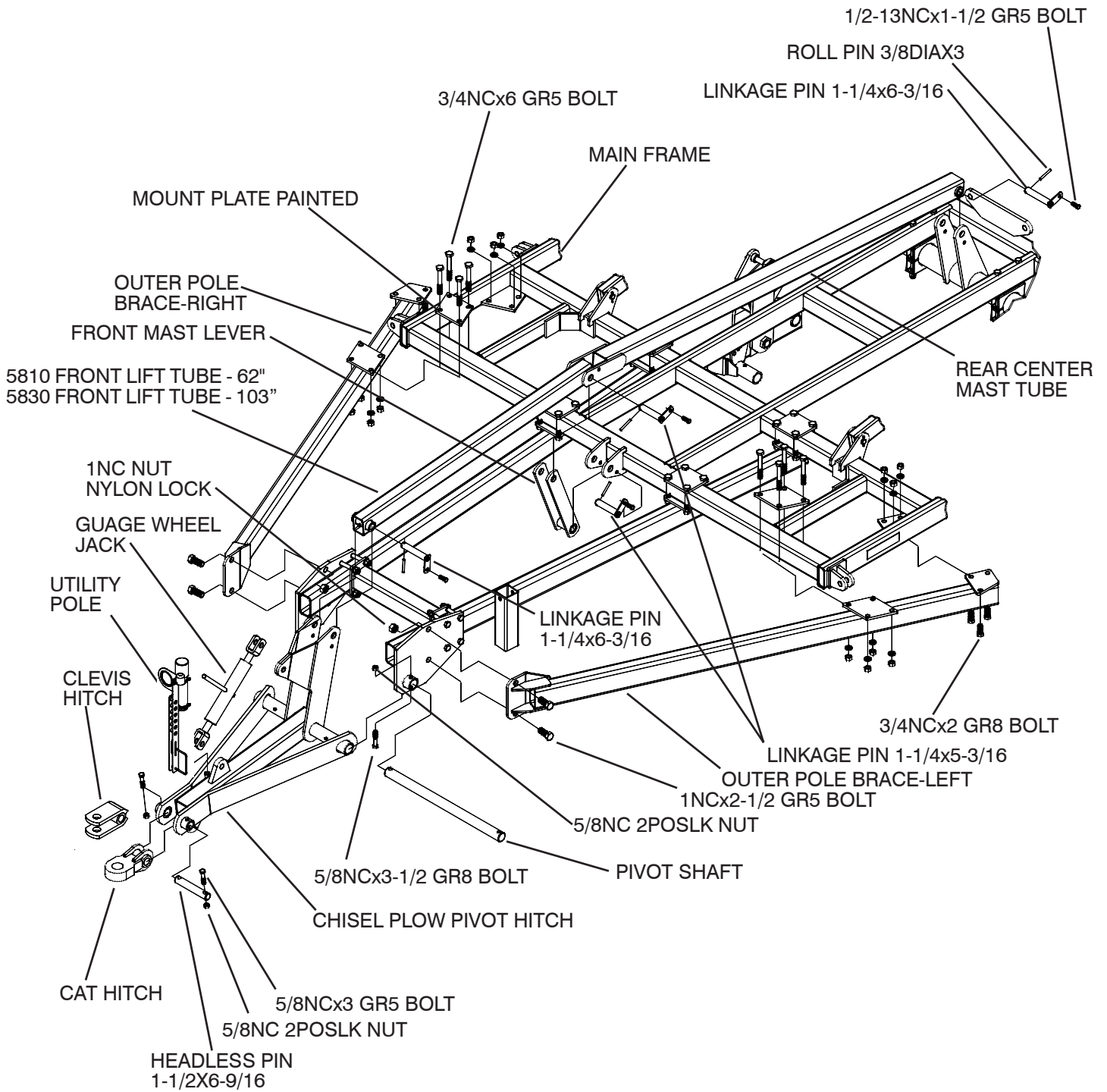

	<b>⚠ DANGER</b>
	<p><b>CRUSHING HAZARD</b></p> <p>To prevent serious injury or death:</p> <ul style="list-style-type: none"> <li>• Do not stand between implement and moving tractor.</li> <li>• Stop tractor engine and set park brake before installing pins.</li> </ul>

# FRONT HINGE TUBE ASSEMBLY - 13 FT MAIN FRAME

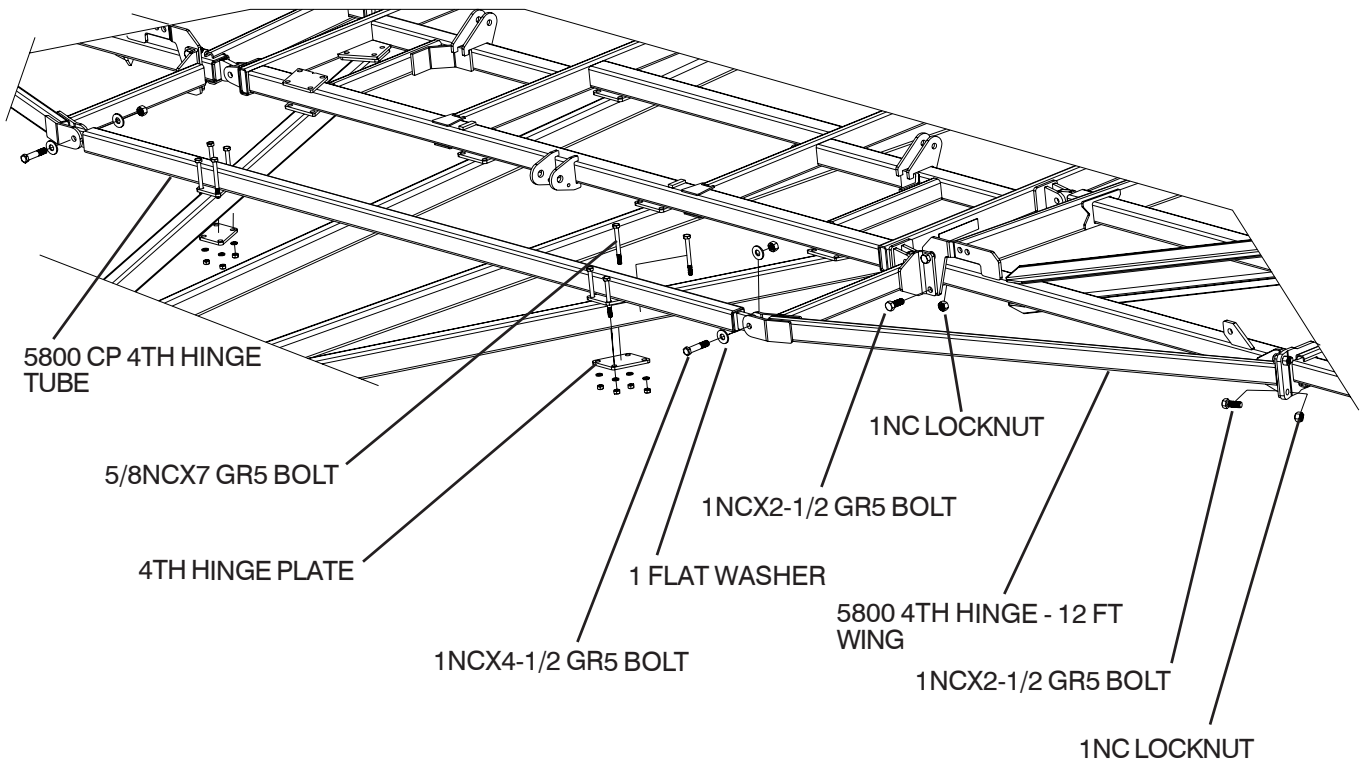

**THIS PAGE INTENTIONALLY LEFT BLANK**

# JACK STAND

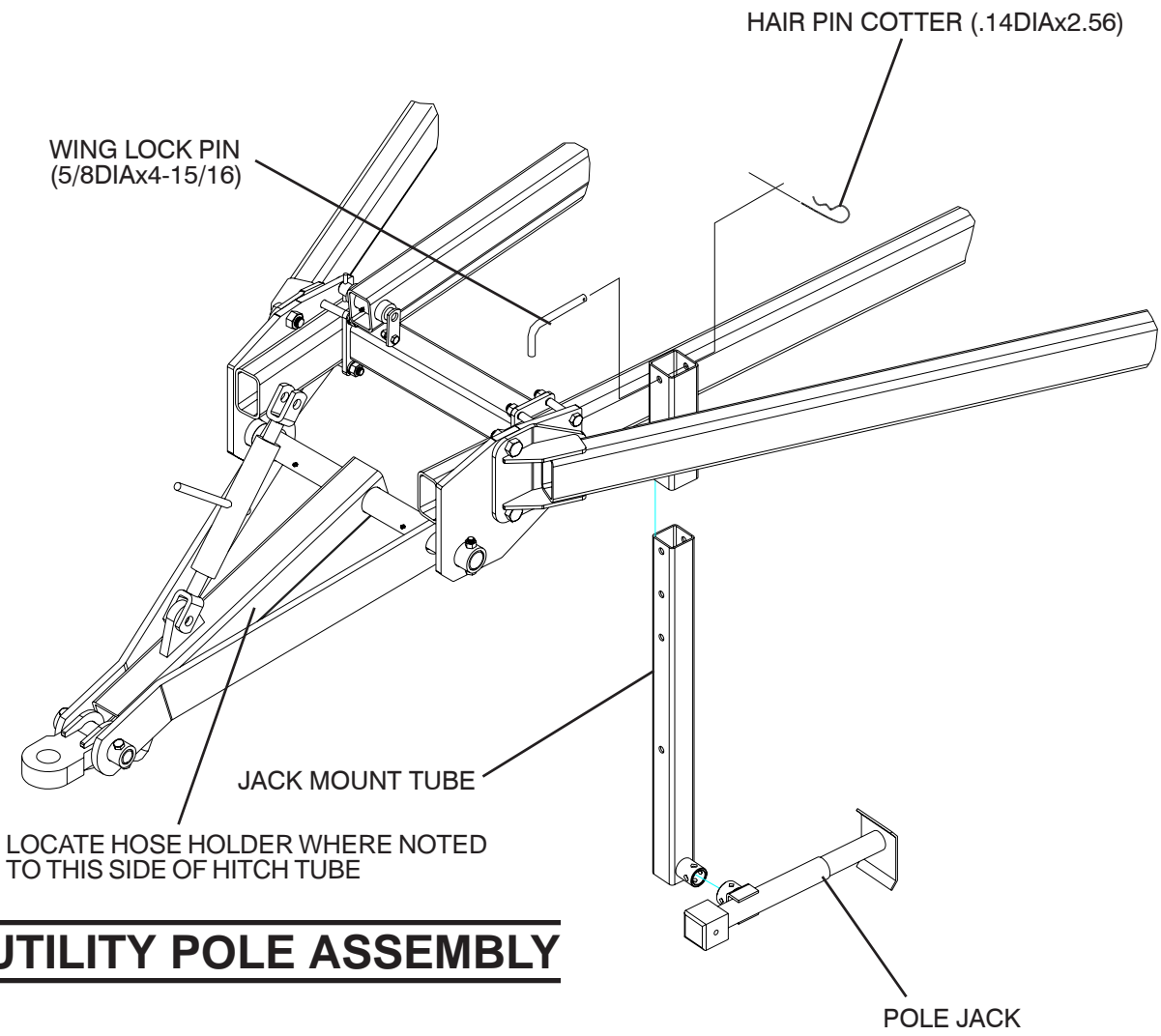

# UTILITY POLE ASSEMBLY

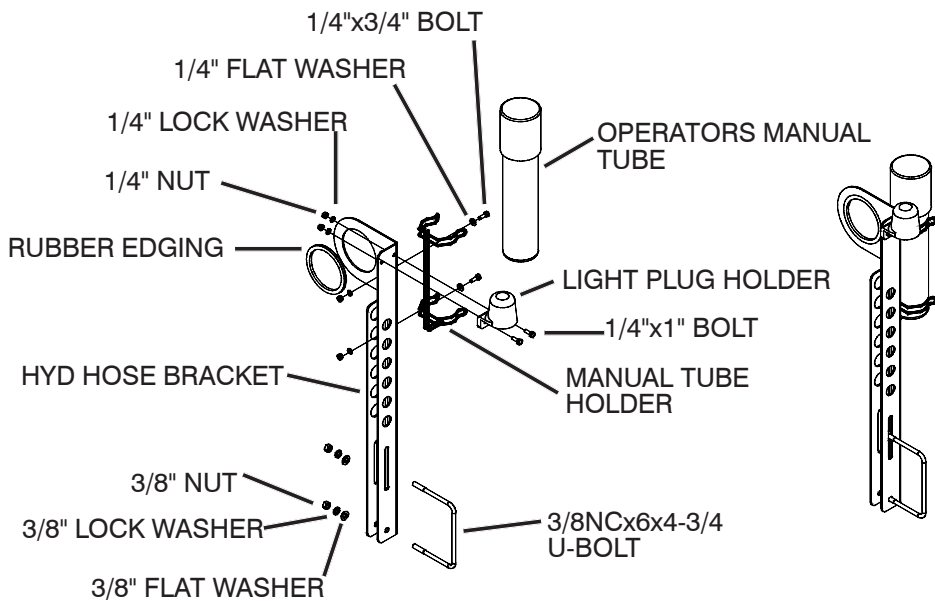

# RIGID GAUGE WHEEL

**NOTE: LOCATE GAUGE WHEELS AT FRONT OUTSIDE CORNER OF MAIN INNER WING APPROX. AS SHOWN.**

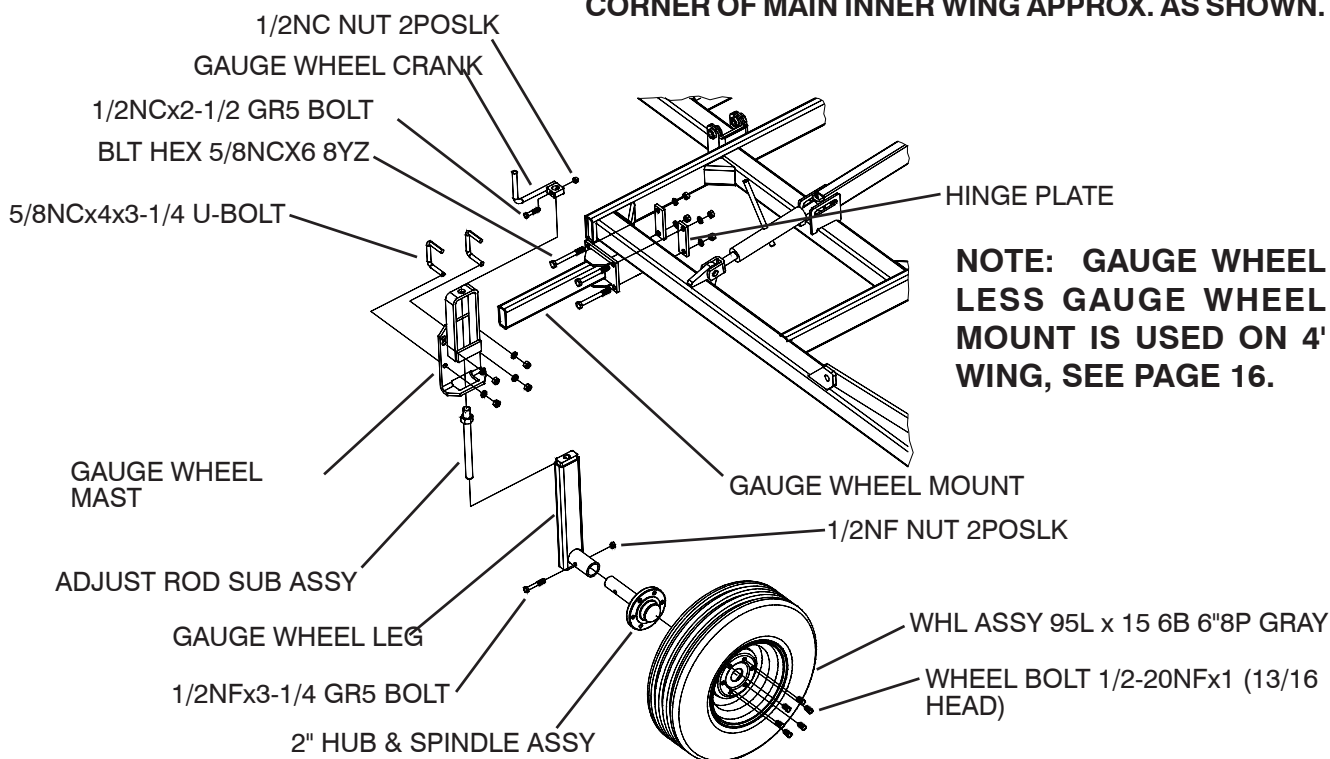

**NOTE: GAUGE WHEEL LESS GAUGE WHEEL MOUNT IS USED ON 4' WING, SEE PAGE 16.**

# CASTERING GAUGE WHEEL

**NOTE: LOCATE GAUGE WHEELS AT FRONT OUTSIDE CORNER OF MAIN INNER WING APPROX. AS SHOWN.**

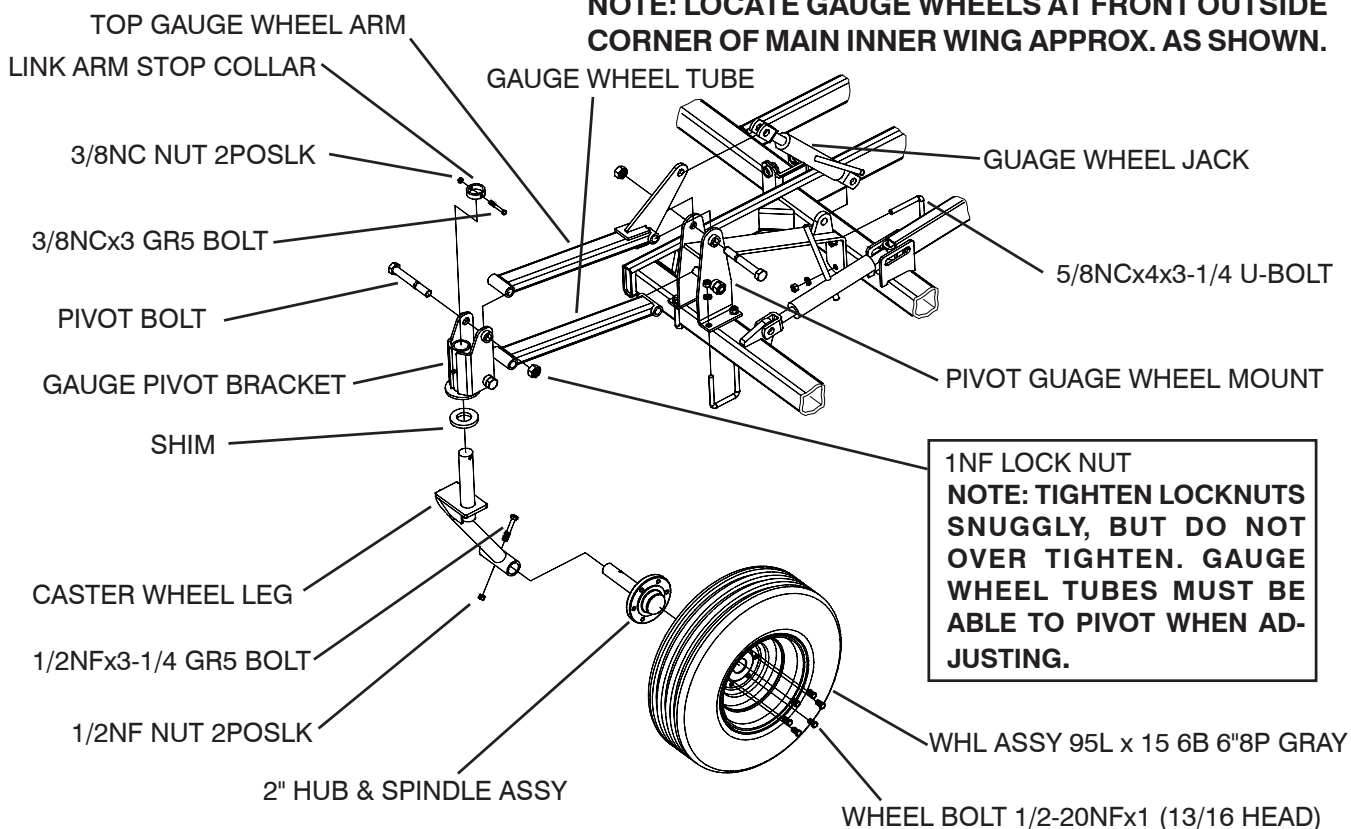

**1NF LOCK NUT  
NOTE: TIGHTEN LOCKNUTS SNUGGLY, BUT DO NOT OVER TIGHTEN. GAUGE WHEEL TUBES MUST BE ABLE TO PIVOT WHEN ADJUSTING.**

# 4FT WING

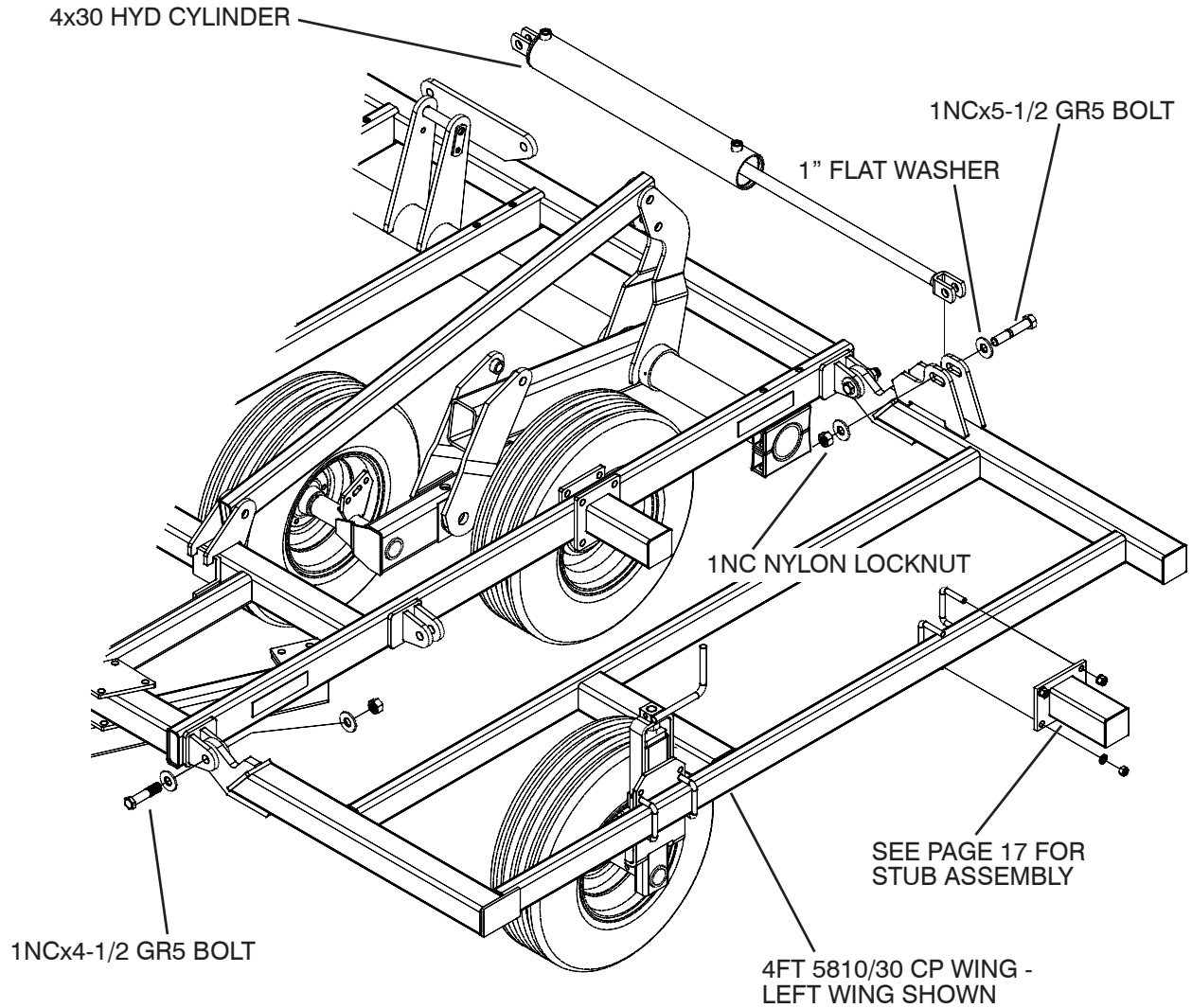

**⚠ DANGER**

**STAND CLEAR AT ALL TIMES:**

- Never walk or stand in the path of the wings.
- Completely lower wings before performing service or adjustments.
- Failure to do so will result in serious injury or death.

22128

**Note: See shank placement pages for correct locations of all add-on stubs.**

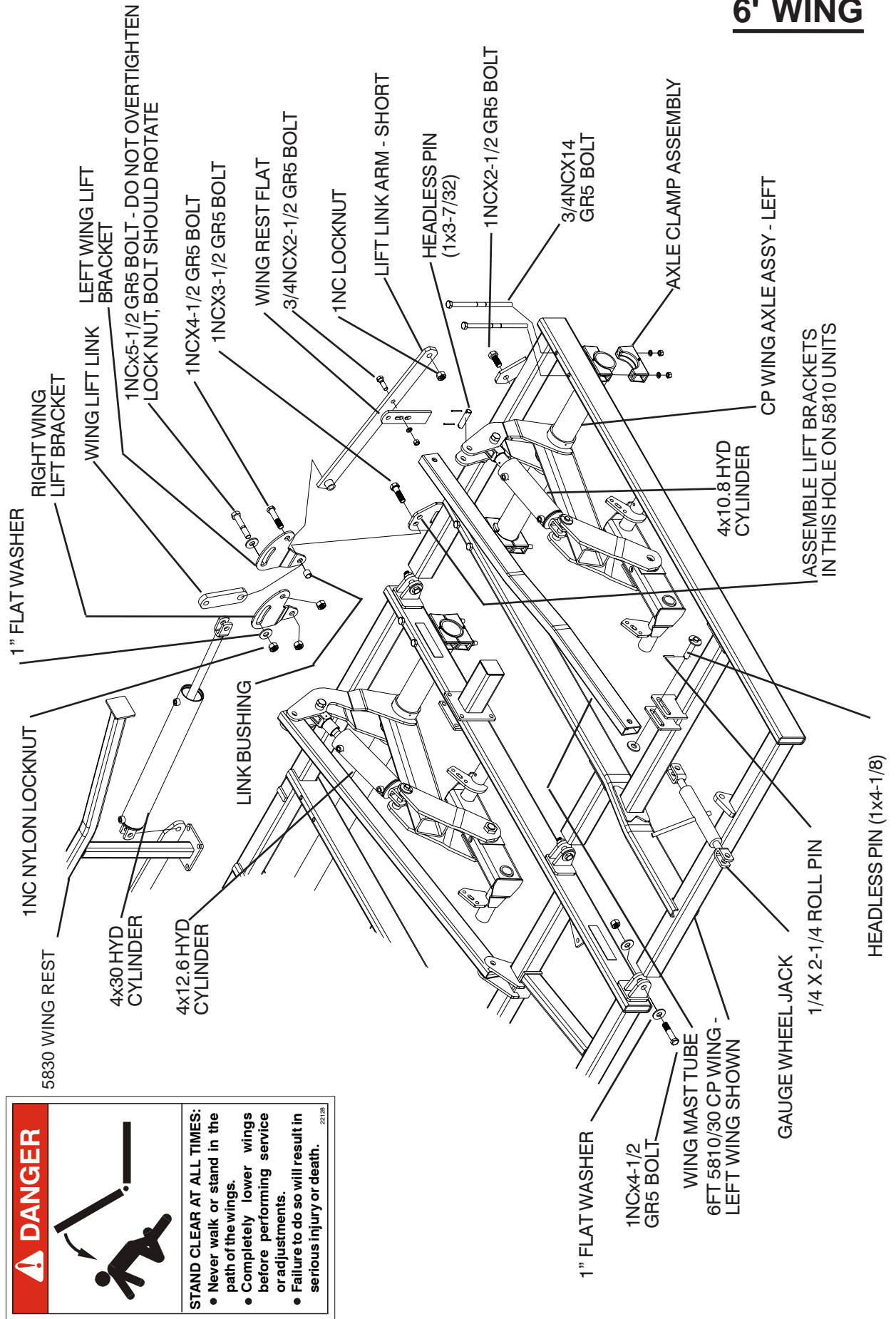

DANGER

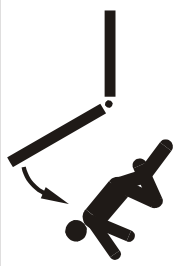

**STAND CLEAR AT ALL TIMES:**

- Never walk or stand in the path of the wings.
- Completely lower wings before performing service or adjustments.
- Failure to do so will result in serious injury or death.

22108

# 9FT WING

## 9' WING

**Note: See shank placement pages for correct locations of all add-on stubs.**

1NCX5-1/2 GR5 BOLT - DO NOT OVERTIGHTEN LOCKNUT, BOLT SHOULD

SEE PAGE 18 & 19

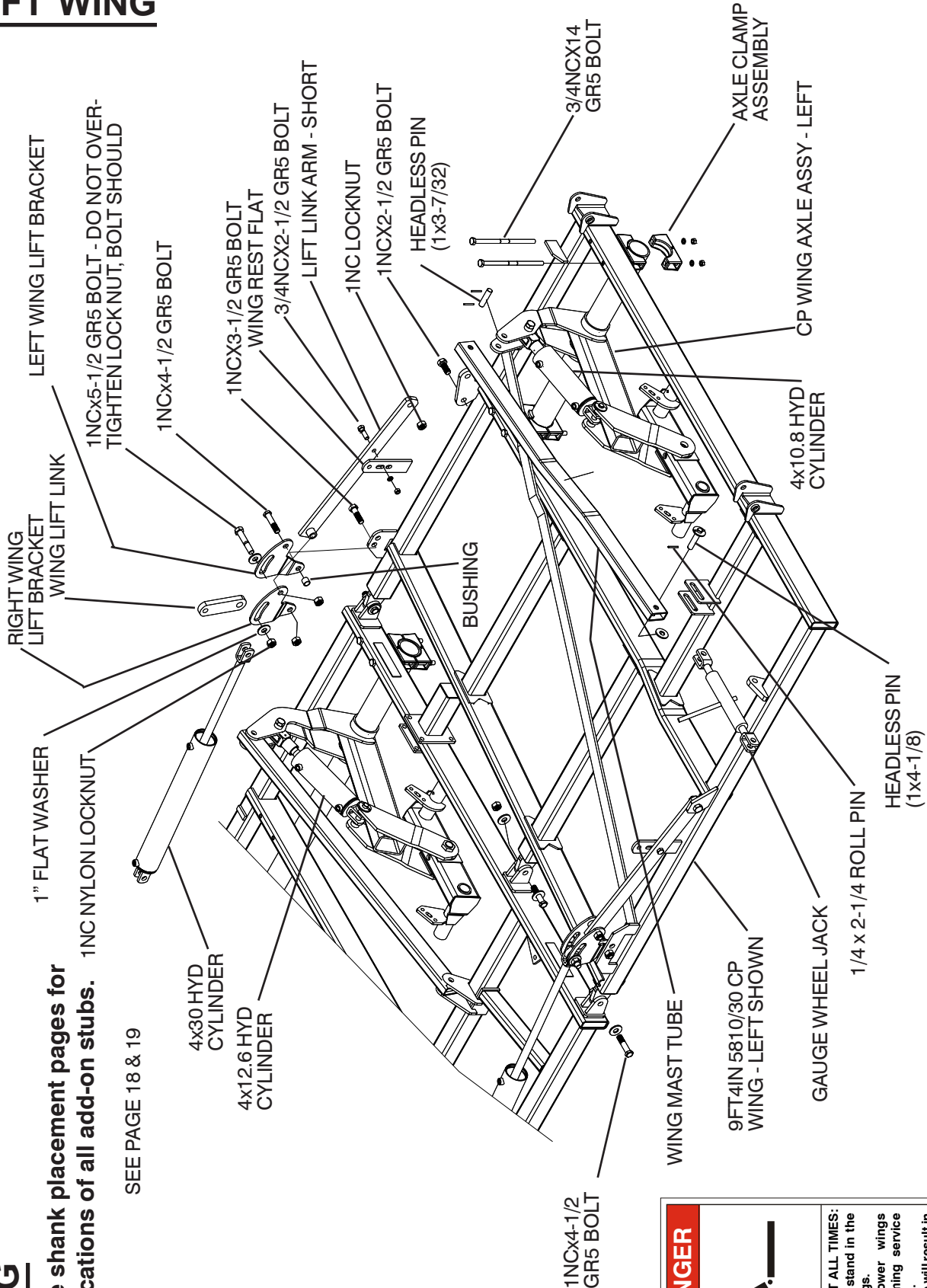

**⚠ DANGER**

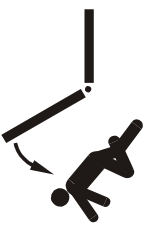

**STAND CLEAR AT ALL TIMES:**

- Never walk or stand in the path of the wings.
- Completely lower wings before performing service or adjustments.
- Failure to do so will result in serious injury or death.



# 12 FT INNER WING ASSEMBLY

**Note: See shank placement pages for correct locations of all add-on stubs.**

DANGER

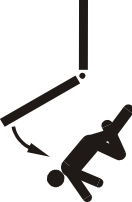

**STAND CLEAR AT ALL TIMES:**

- Never walk or stand in the path of the wings.
- Completely lower wings before performing service or adjustments.
- Failure to do so will result in serious injury or death.

2008

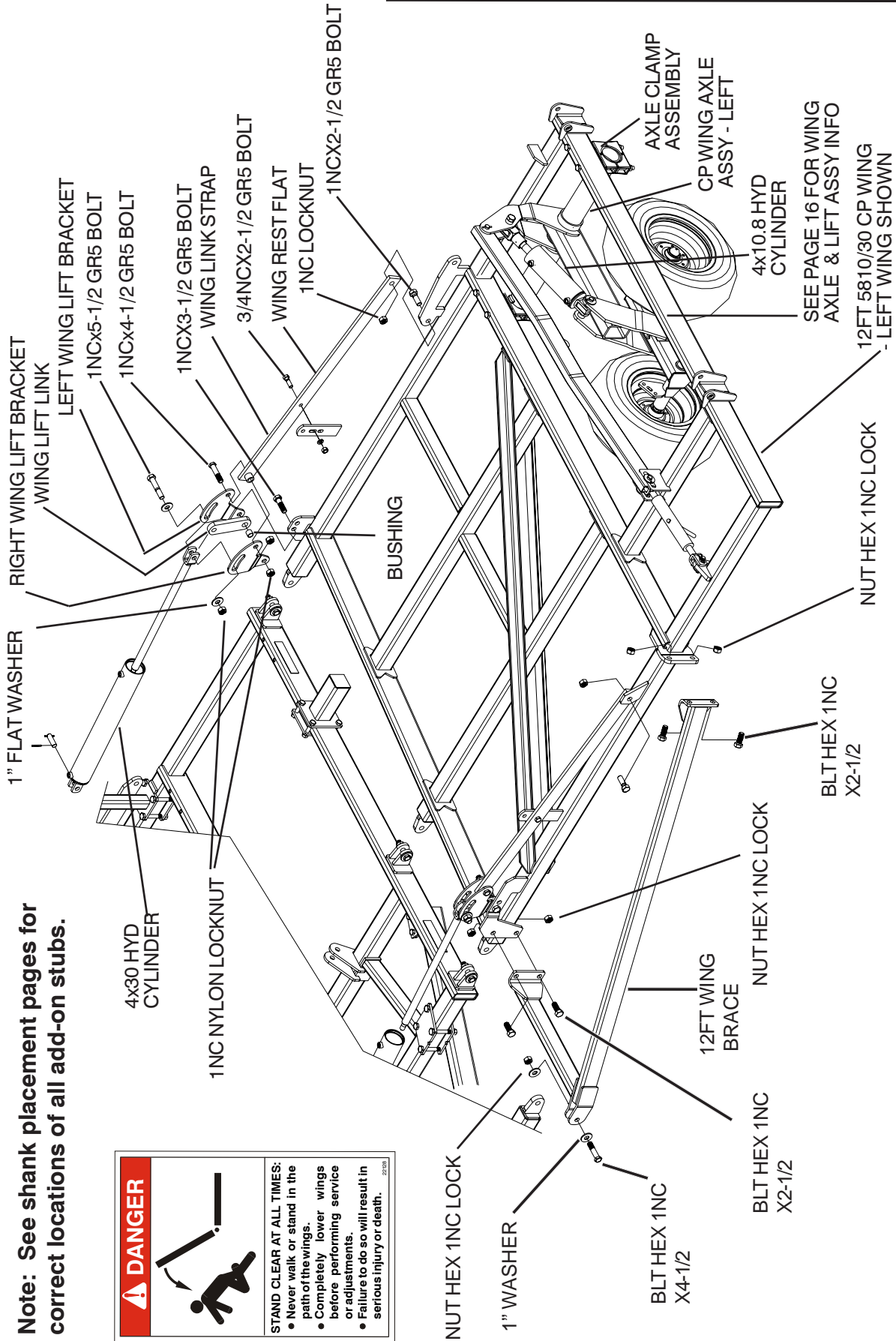

# 12 FT INNER WING ASSEMBLY

# WING AXLE ASSEMBLY

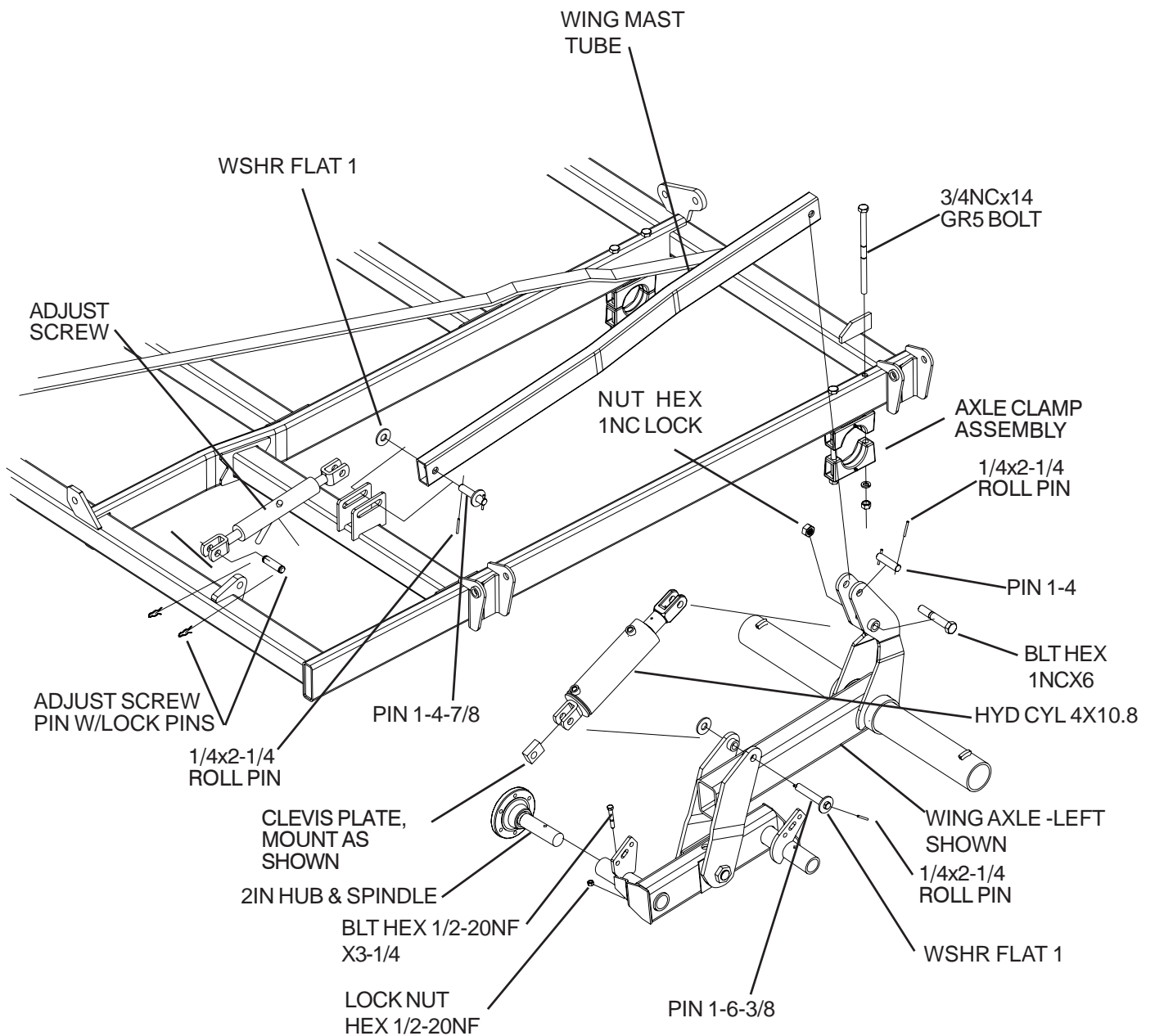

**Note: Hardware is secured with matching hex nuts and lock washers unless specified.**

# 3' OUTER WING

Note: See shank placement pages for correct locations of all add-on stubs.

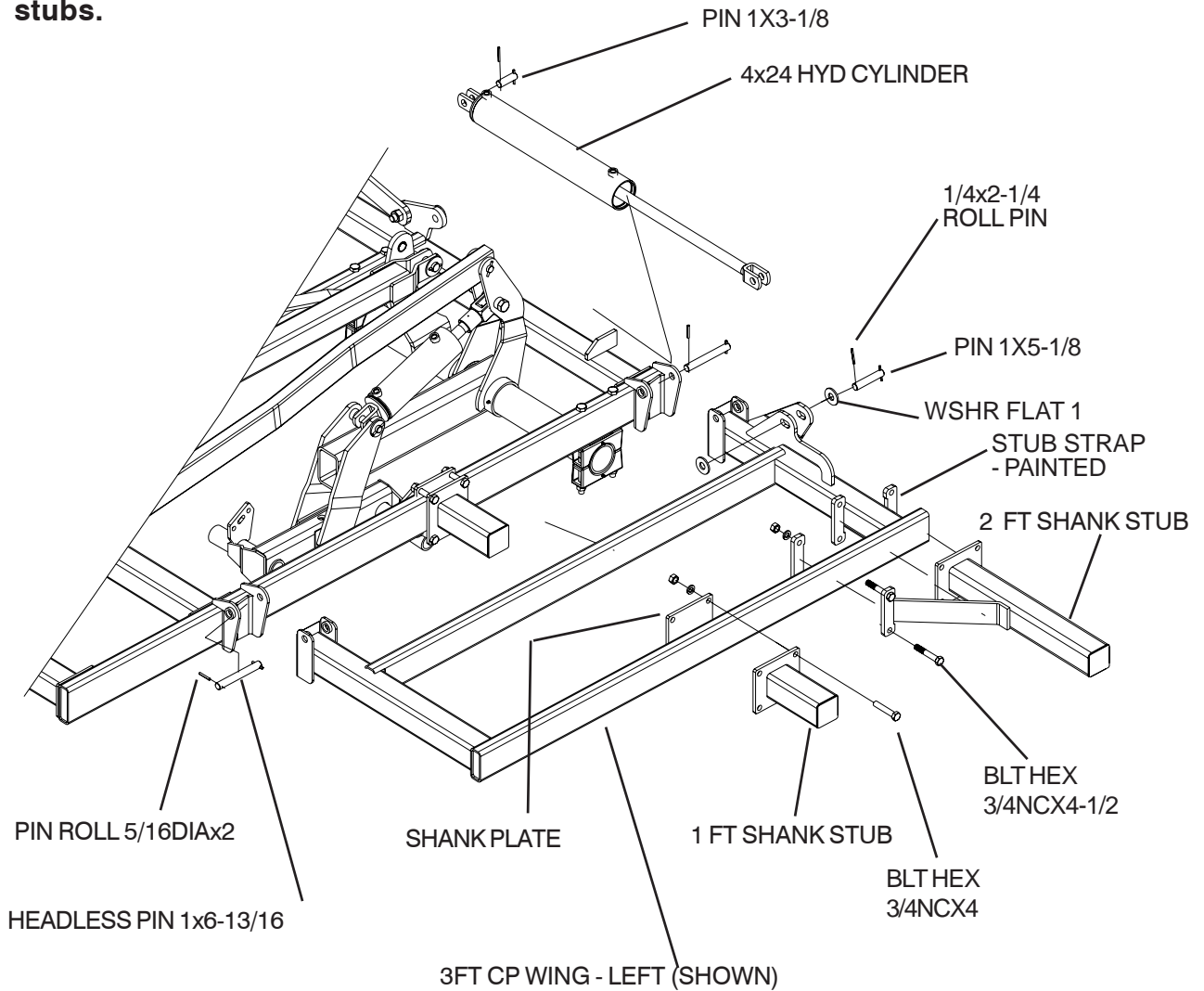

Note: Hardware is secured with matching hex nuts and lock washers unless specified.

Note: On unit with 12 ft inner wings and 3 ft outer wings unique wing fold links, brackets and rest stops are required.

**⚠ DANGER**

**STAND CLEAR AT ALL TIMES:**

- Never walk or stand in the path of the wings.
- Completely lower wings before performing service or adjustments.
- Failure to do so will result in serious injury or death.

22128

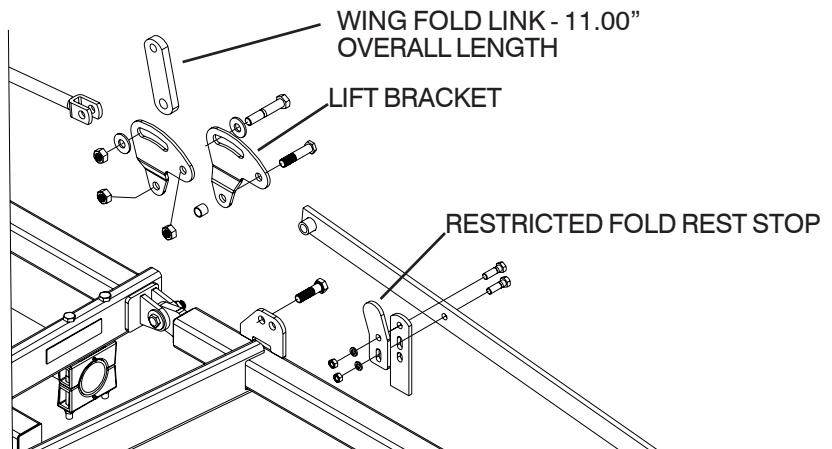

# STUB EXTENSIONS

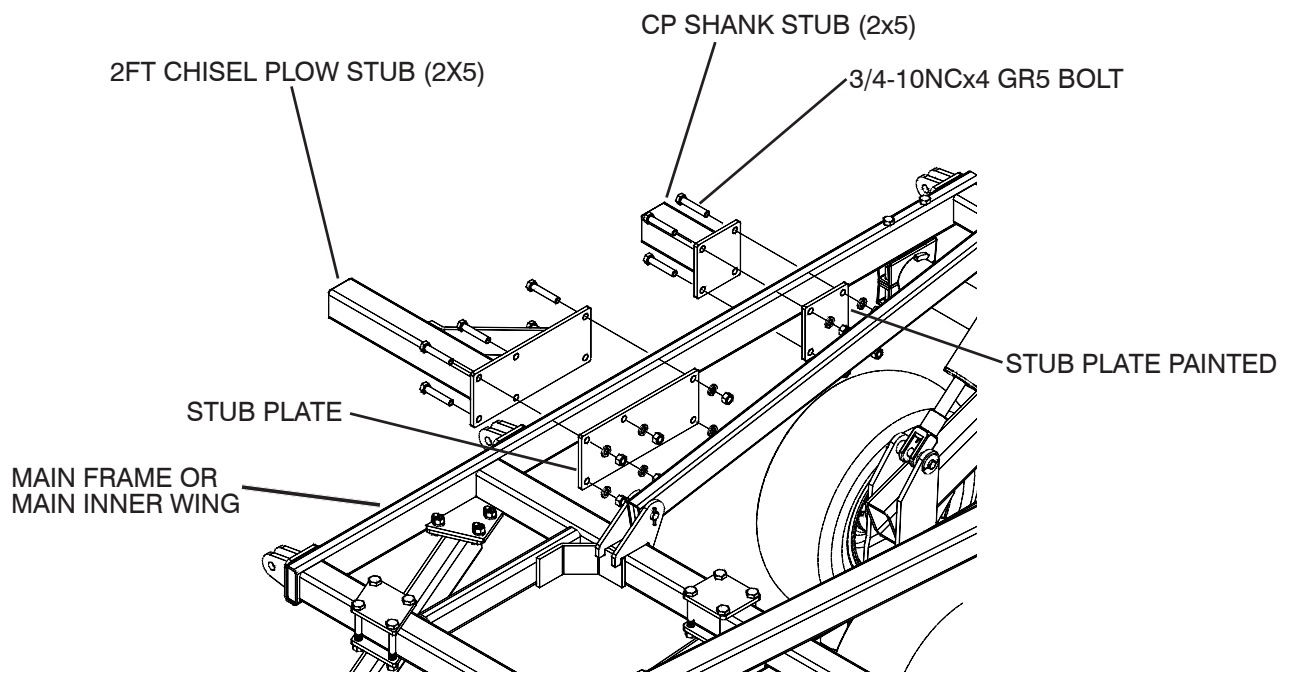

**Note: See shank placements for locations of stubs.**

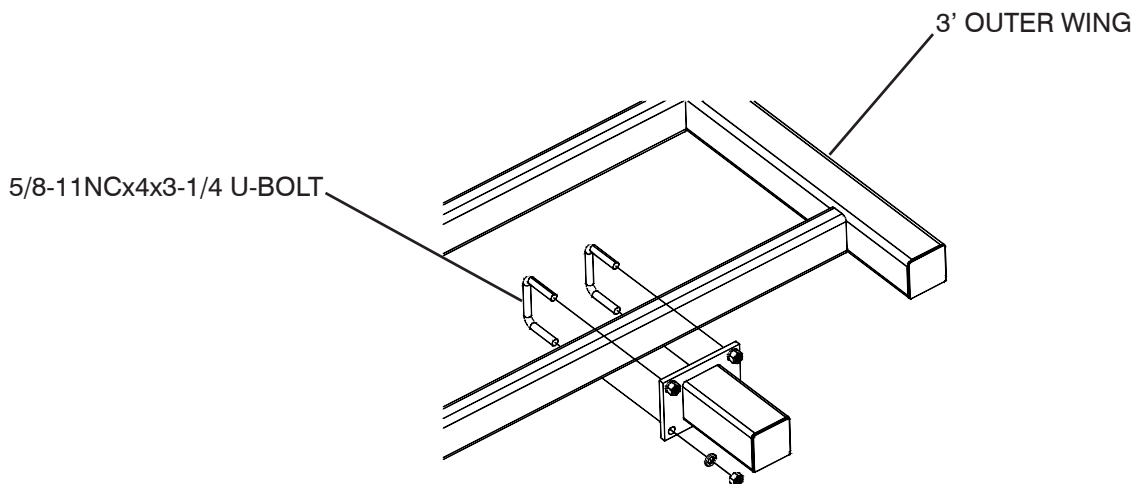

# 5800 REAR AXLE AND WALKING TANDEM

MAIN FRAME AXLE (13 FT) SHOWN, MOUNT  
CYLINDERS ON WING AXLE IN SIMILAR MANNER

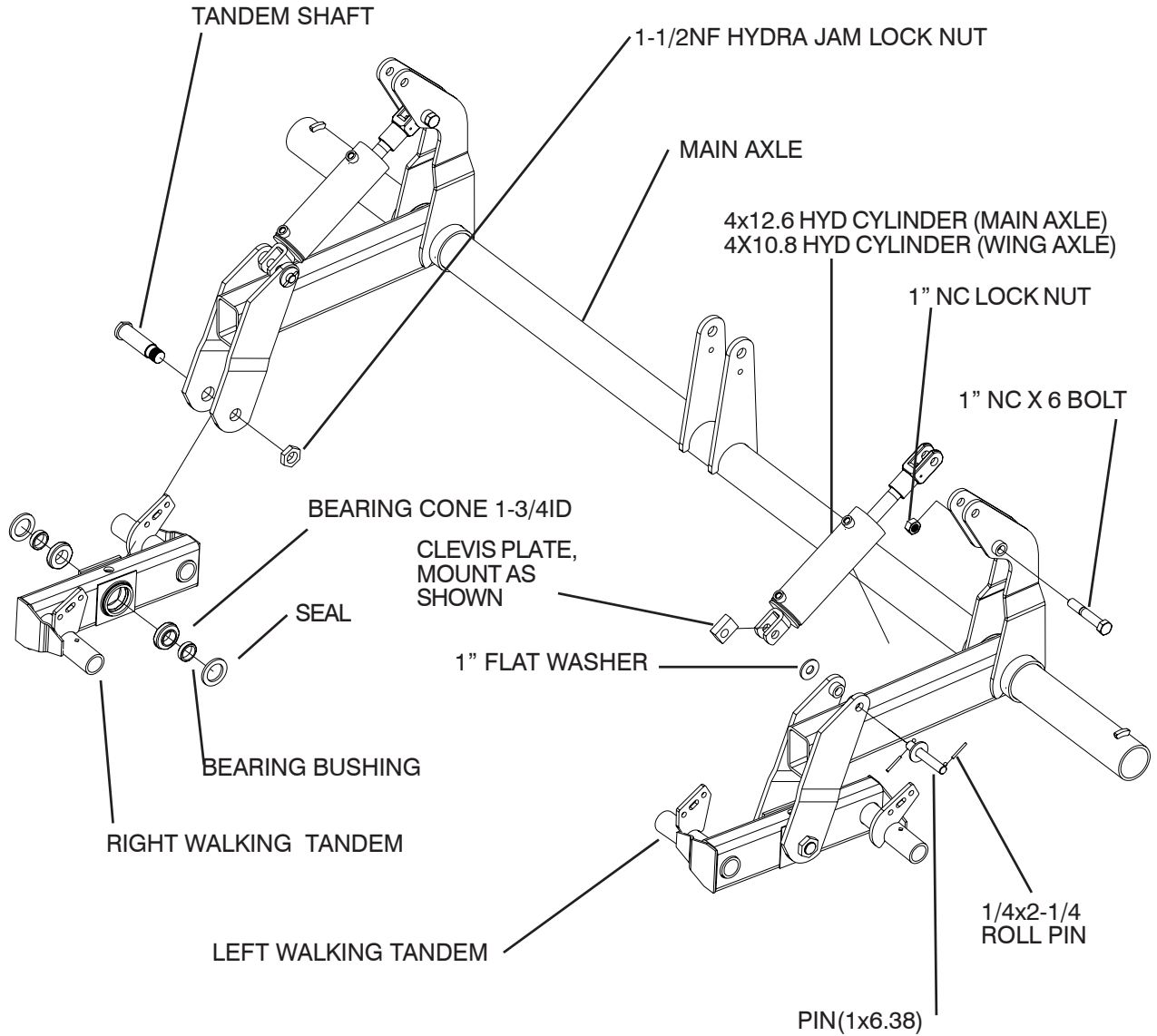

# MUD SCRAPERS

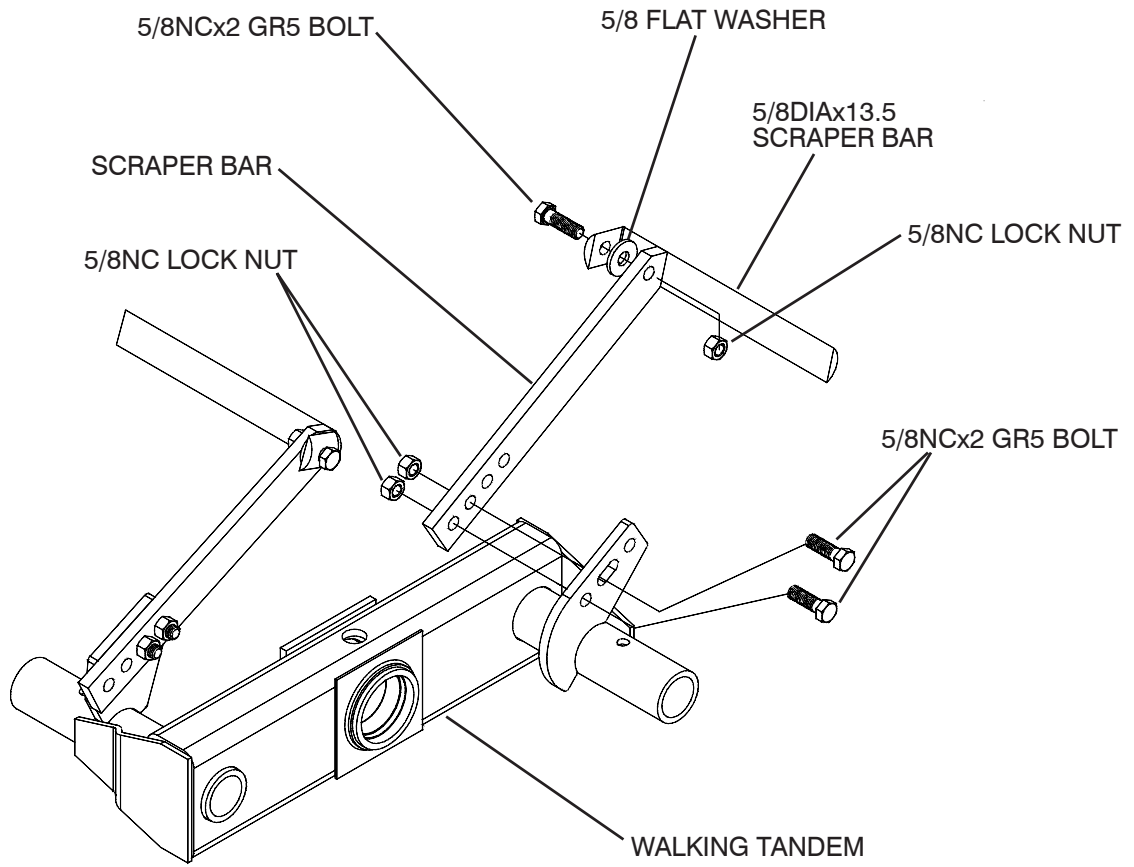

# 1000 LB CP SHANK ASSEMBLY

## FLAT PLATE MOUNTING

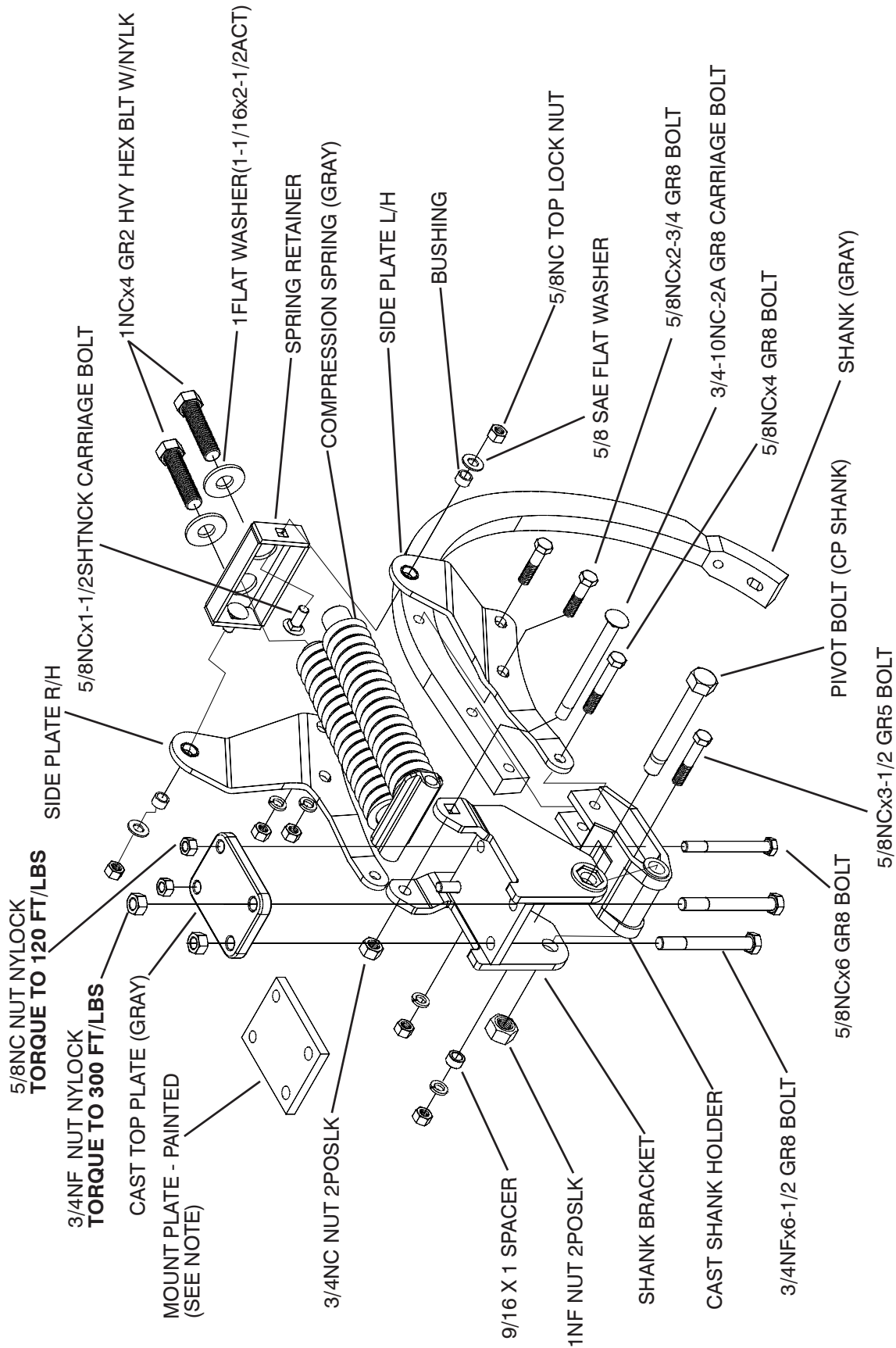

TORQUE ALL HARDWARE TO FT/LB NOTED ON PAGE 3

**NOTE: OPTIONAL MOUNT PLATE IS MAY BE REQUIRED IN LOCATIONS UNDER THE WING LIFTS ON FRONT HINGE AREA.**

# 1000 LB CP SHANK ASSEMBLY

## CORNER PLATE MOUNTING

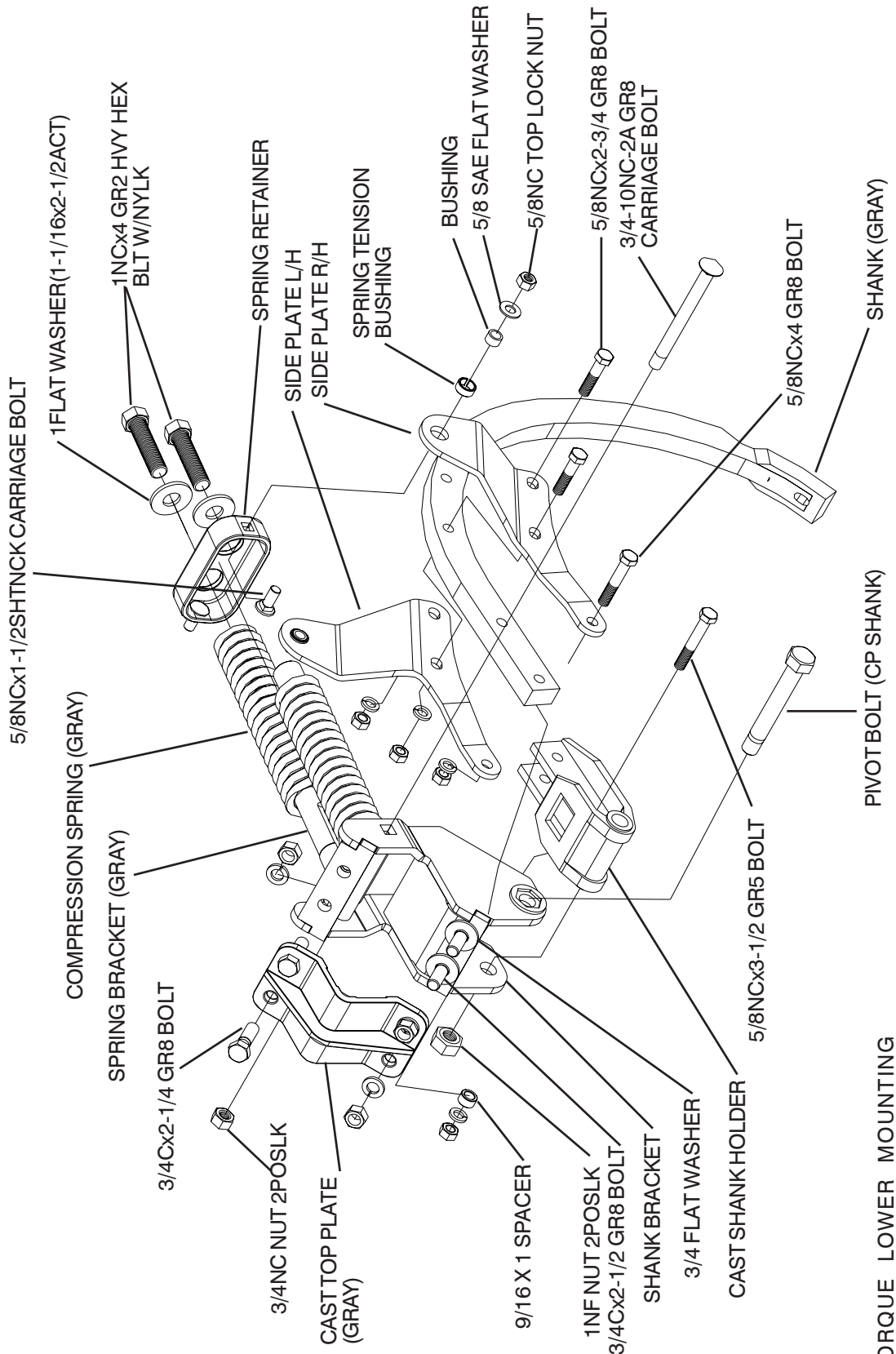

TORQUE ALL HARDWARE TO FT/LB NOTED ON PAGE 3

TORQUE LOWER MOUNTING BOLTS FIRST, TORQUE BOLTS TO 340 FT.LB.



# 32IN 54 DEGREE 650 LB CP SHANK ASSEMBLY

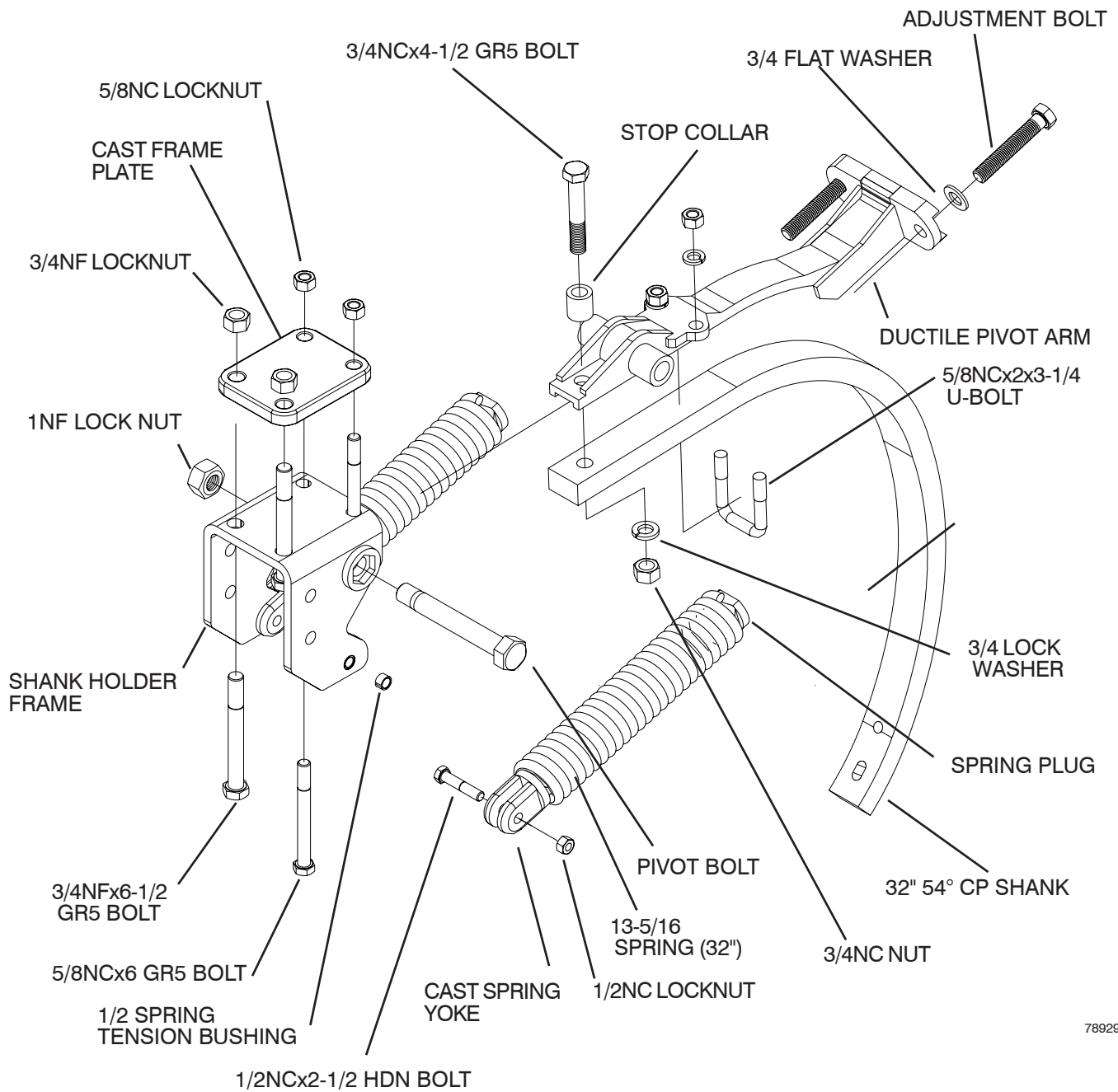

78929

**TORQUE ALL HARDWARE TO  
FT/LB NOTED ON PAGE 3**

# UNIVERSAL AUXILIARY HITCH

FITS 13FT 5830 MAIN FRAME ONLY

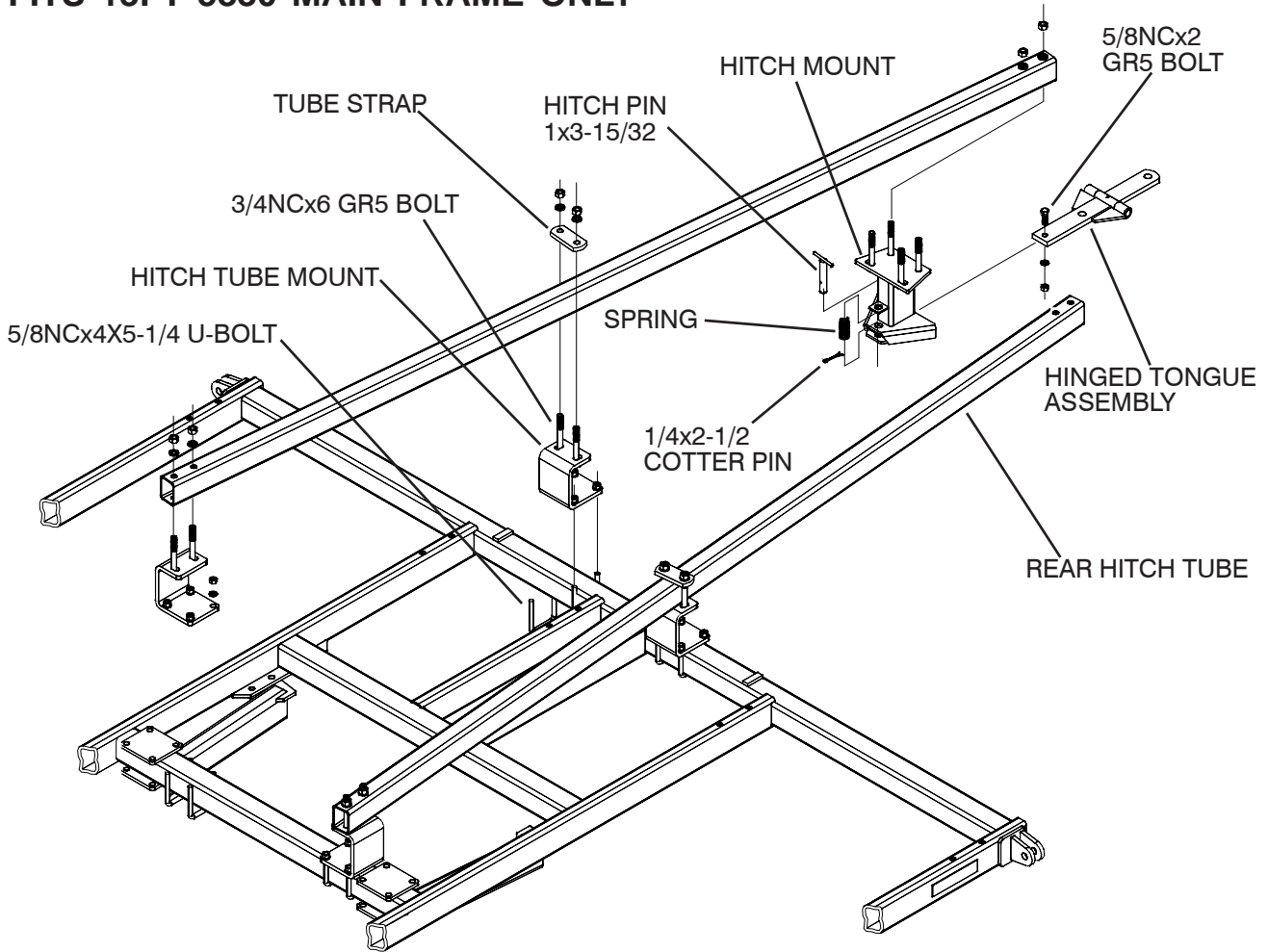

USE OF THIS HITCH MAT PREVENT USE OF THE SINGLE POINT DEPTH CONTROL OF MOUNTING OF LIQUID TANKS.

## MAIN LIFT BYPASS SYSTEM INFO

ALL MAIN LIFT HYDRAULIC SYSTEMS CONSIST OF A 4X12.6 CYLINDER ON THE MAIN FRAME CONNECTED AS SHOWN TO A 4X10.8 WING LIFT CYLINDER.

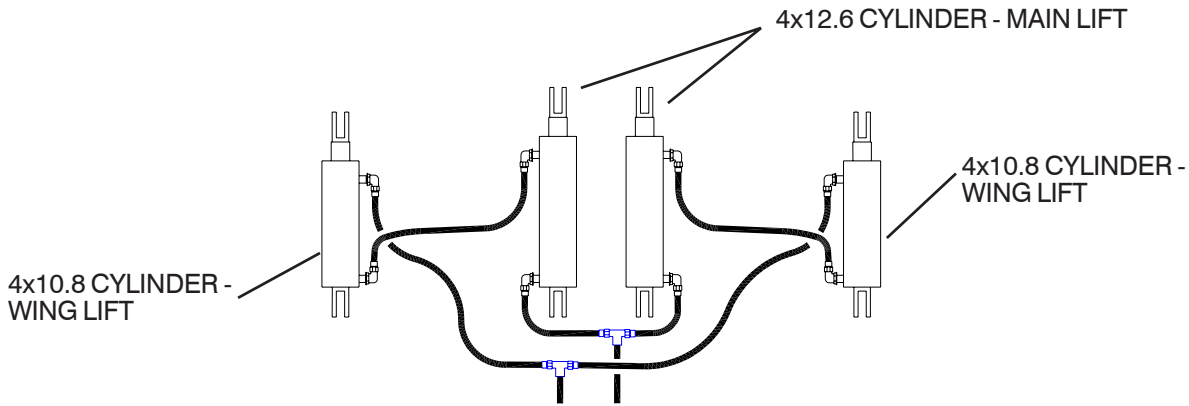

CYLINDERS ARE MOUNTED AT THE LIFT LOCATIONS WITH THE ROD END UP, THE BASE END ATTACHED TO THE MAIN OR WING AXLE.

# 5810 WING FOLD HYDRAULICS

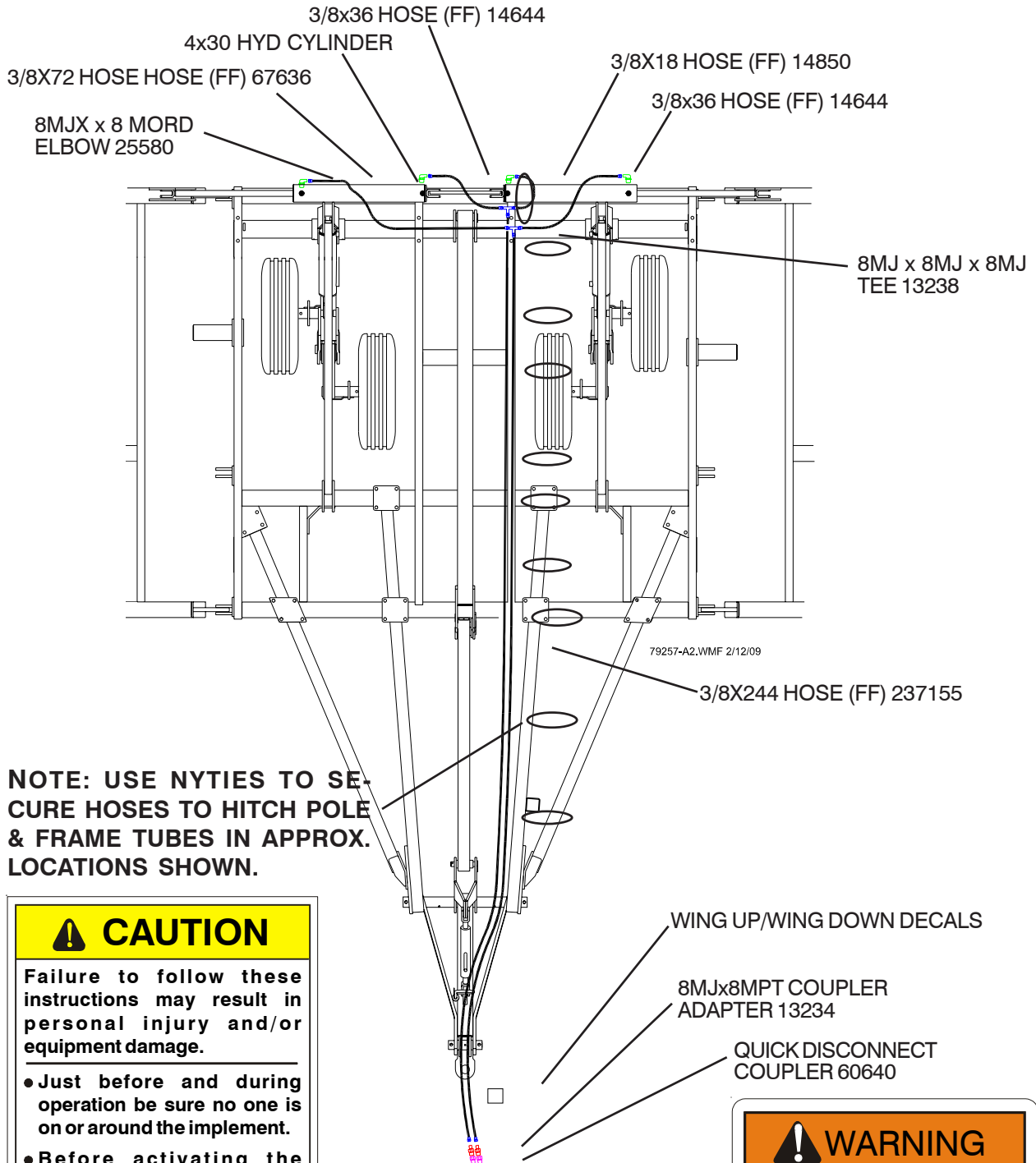

**NOTE: USE NYTIES TO SECURE HOSES TO HITCH POLE & FRAME TUBES IN APPROX. LOCATIONS SHOWN.**



**⚠ CAUTION**

Failure to follow these instructions may result in personal injury and/or equipment damage.

- Just before and during operation be sure no one is on or around the implement.
- Before activating the hydraulic system, check hoses for proper connections.
- Before lowering the wings for the first time, make sure the entire system has been charged with oil.
- With wings down always install hydraulic cylinder channel lock(s) for transporting.

54374

**⚠ WARNING**

**HIGH PRESSURE FLUID HAZARD**

To prevent serious injury or death:

- Relieve pressure on system before repairing or adjusting or disconnecting.
- Wear proper hand and eye protection when searching for leaks. Use wood or cardboard instead of hands.
- Keep all components in good repair.

60711

# 5830 WING FOLD HYDRAULICS

## 6FT WINGS

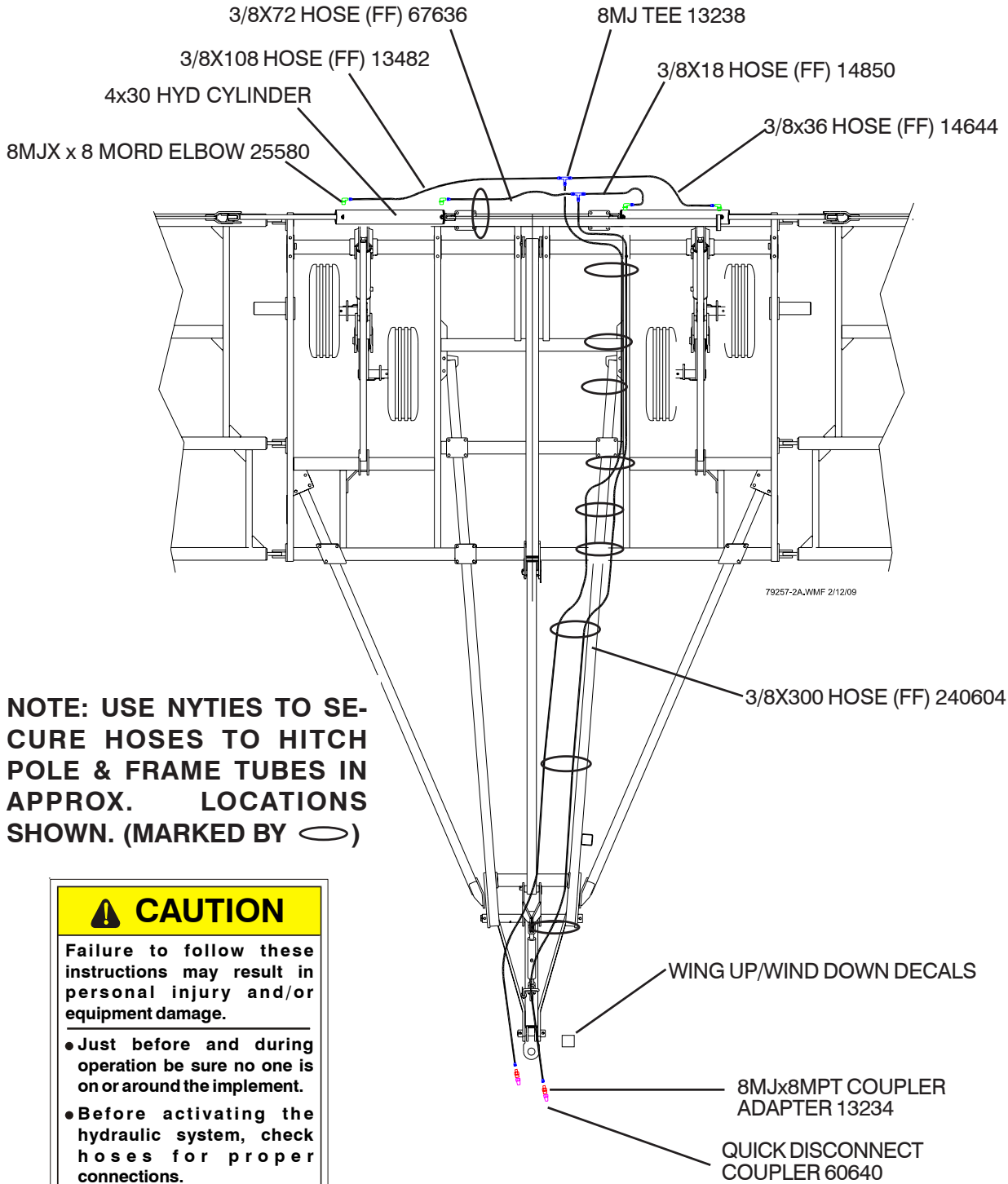

**NOTE: USE NYTIES TO SECURE HOSES TO HITCH POLE & FRAME TUBES IN APPROX. LOCATIONS SHOWN. (MARKED BY ○)**

**⚠ CAUTION**

Failure to follow these instructions may result in personal injury and/or equipment damage.

- Just before and during operation be sure no one is on or around the implement.
- Before activating the hydraulic system, check hoses for proper connections.
- Before lowering the wings for the first time, make sure the entire system has been charged with oil.
- With wings down always install hydraulic cylinder channel lock(s) for transporting.



54324

# 5830 WING FOLD HYDRAULICS

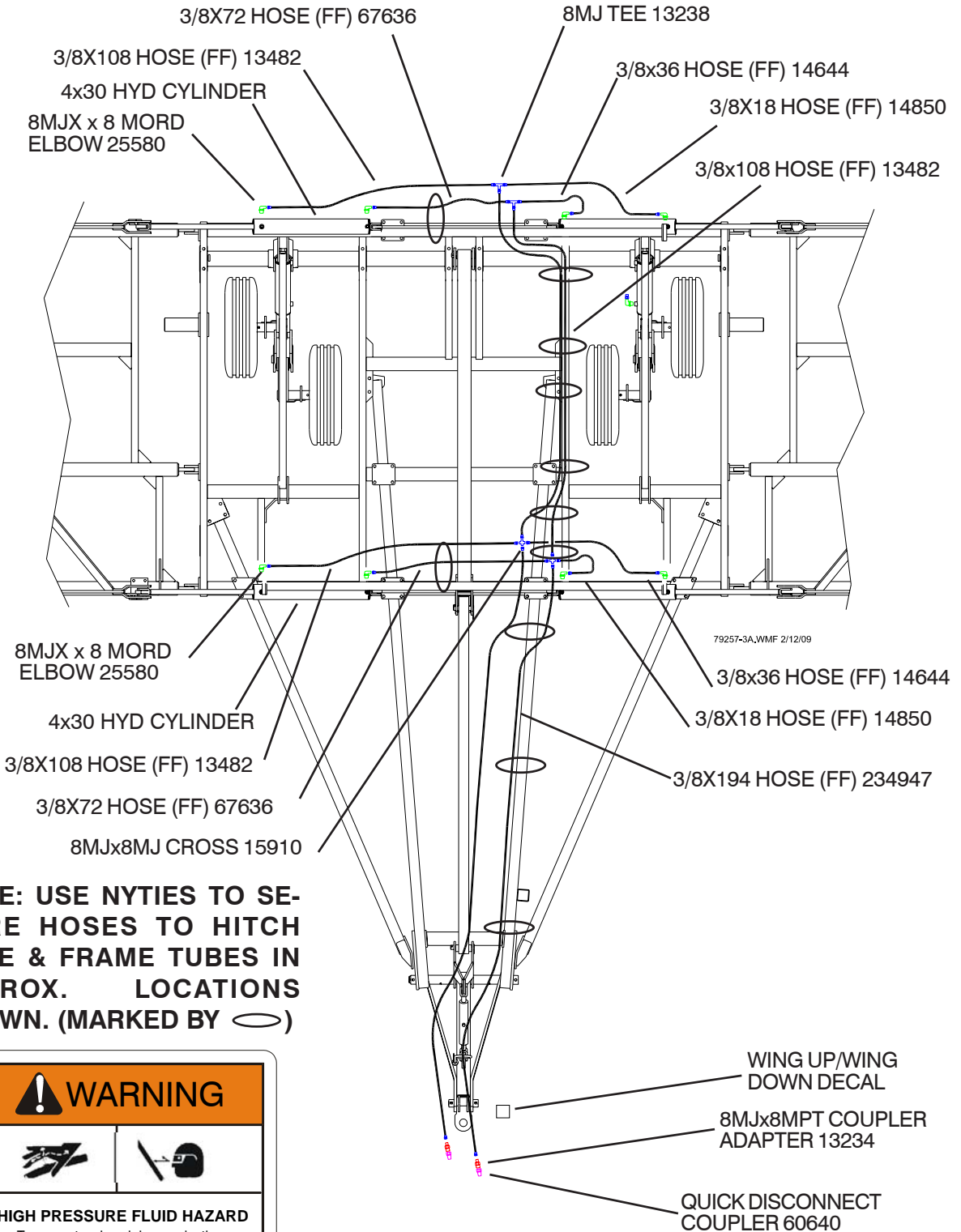
## 9FT & 12FT WINGS



**NOTE: USE NYTIES TO SECURE HOSES TO HITCH POLE & FRAME TUBES IN APPROX. LOCATIONS SHOWN. (MARKED BY ○)**

 <b>WARNING</b>	
	
<b>HIGH PRESSURE FLUID HAZARD</b> To prevent serious injury or death:	
<ul style="list-style-type: none"> <li>● Relieve pressure on system before repairing or adjusting or disconnecting.</li> <li>● Wear proper hand and eye protection when searching for leaks. Use wood or cardboard instead of hands.</li> <li>● Keep all components in good repair.</li> </ul>	
60711	

5830\_CPW31-35\_CPW37-41\_HYD\_FOLD.PLT

# 5830 WING FOLD HYDRAULICS

## 5830 WING FOLD HYDRAULICS 9FT WINGS W/OUTER WING

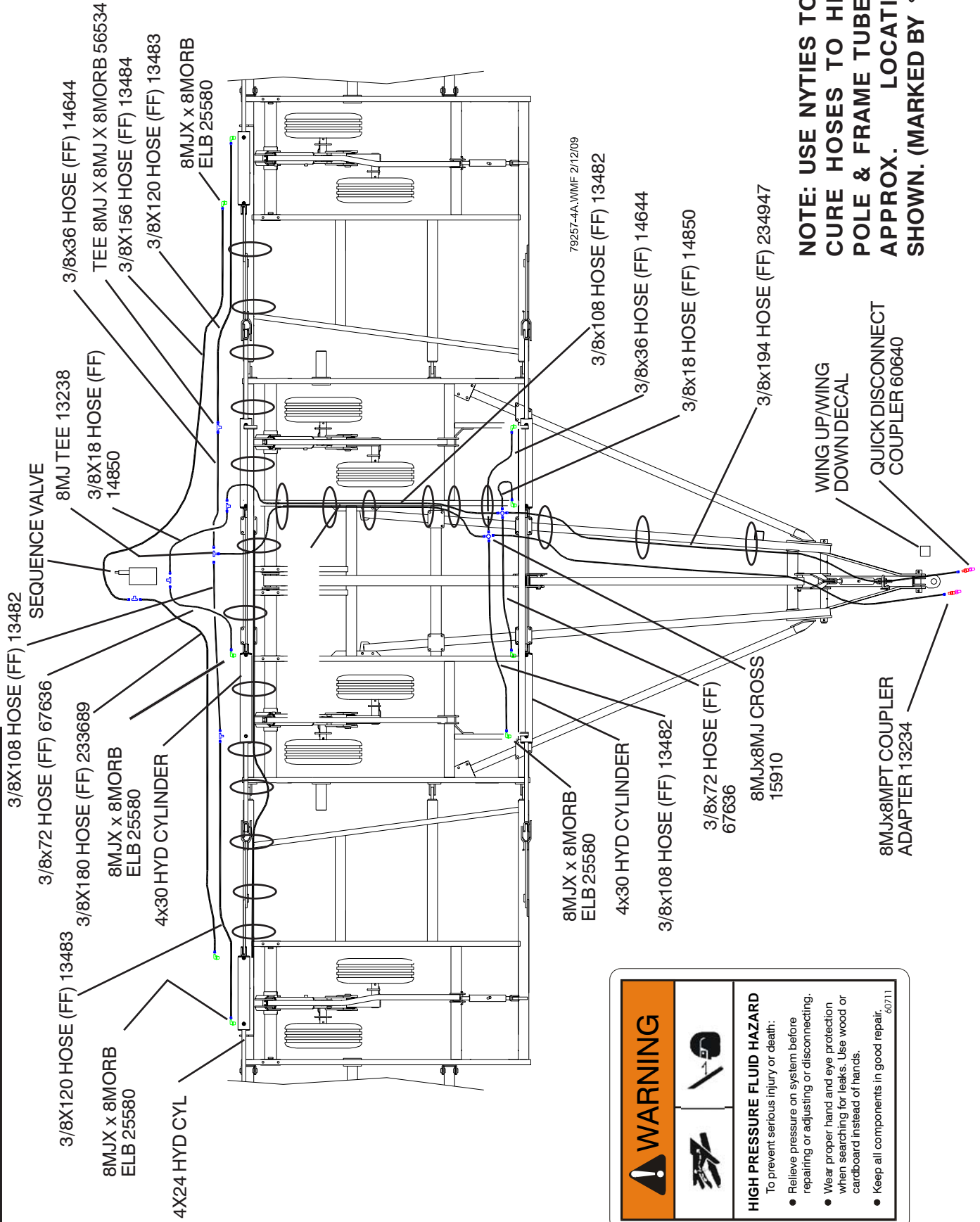

**NOTE: USE NYTIES TO SECURE HOSES TO HITCH POLE & FRAME TUBES IN APPROX. LOCATIONS SHOWN. (MARKED BY ○)**

 <b>WARNING</b>	
<p><b>HIGH PRESSURE FLUID HAZARD</b> To prevent serious injury or death:</p> <ul style="list-style-type: none"> <li>• Relieve pressure on system before repairing or adjusting or disconnecting.</li> <li>• Wear proper hand and eye protection when searching for leaks. Use wood or cardboard instead of hands.</li> <li>• Keep all components in good repair. <small>60711</small></li> </ul>	

# 5830 WING FOLD HYDRAULICS

## 12FT WINGS W/OUTER WING

### 5830 WING FOLD HYDRAULICS

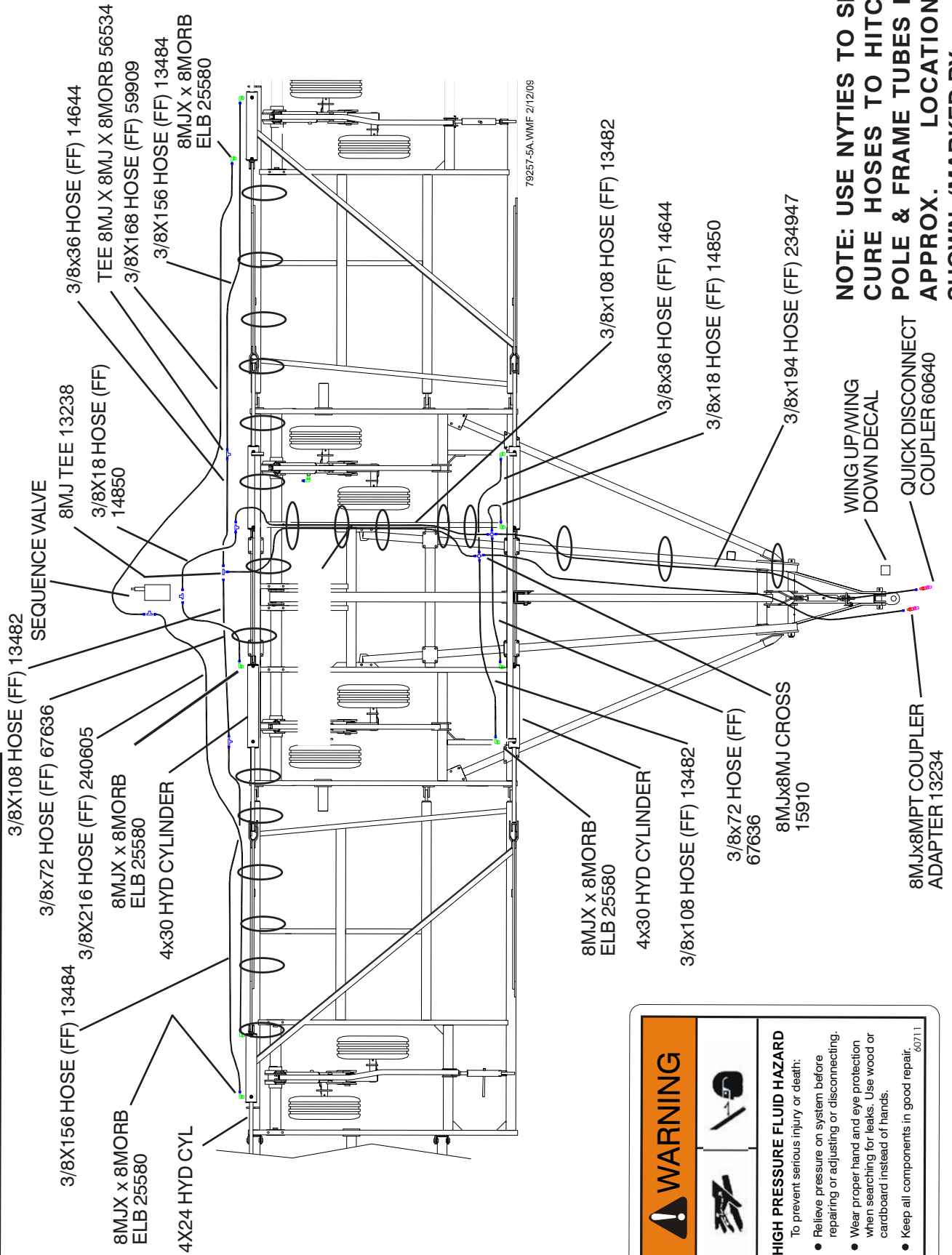

**NOTE: USE NYTIES TO SECURE HOSES TO HITCH POLE & FRAME TUBES IN APPROX. LOCATIONS SHOWN. (MARKED BY ○)**

<b>WARNING</b>  	
	<p><b>HIGH PRESSURE FLUID HAZARD</b>          To prevent serious injury or death:</p> <ul style="list-style-type: none"> <li>• Relieve pressure on system before repairing or adjusting or disconnecting.</li> <li>• Wear proper hand and eye protection when searching for leaks. Use wood or cardboard instead of hands.</li> <li>• Keep all components in good repair. 60711</li> </ul>



# 5810 MAIN LIFT HYDRAULICS

## 4FT WINGS

**CAUTION**  
**TO AVOID INJURY AND/OR EQUIPMENT DAMAGE:**  
 • This cylinder has an integral restricting orifice and must be replaced with an identical cylinder.  
 20121

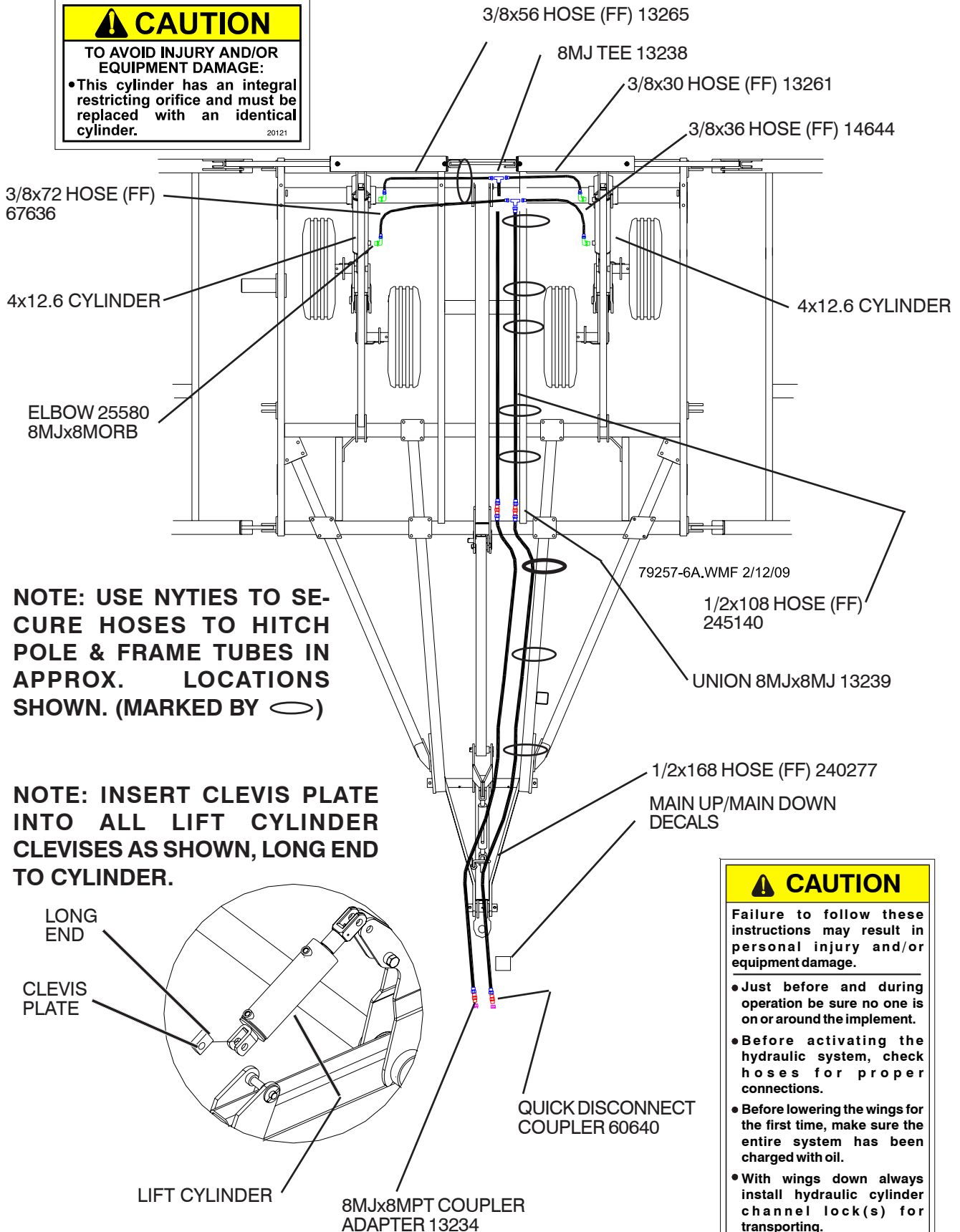

**NOTE: USE NYTIES TO SECURE HOSES TO HITCH POLE & FRAME TUBES IN APPROX. LOCATIONS SHOWN. (MARKED BY ○)**

**NOTE: INSERT CLEVIS PLATE INTO ALL LIFT CYLINDER CLEVISES AS SHOWN, LONG END TO CYLINDER.**

**CAUTION**

Failure to follow these instructions may result in personal injury and/or equipment damage.

- Just before and during operation be sure no one is on or around the implement.
- Before activating the hydraulic system, check hoses for proper connections.
- Before lowering the wings for the first time, make sure the entire system has been charged with oil.
- With wings down always install hydraulic cylinder channel lock(s) for transporting.

54374



# 5810 MAIN LIFT HYDRAULICS

6FT WINGS

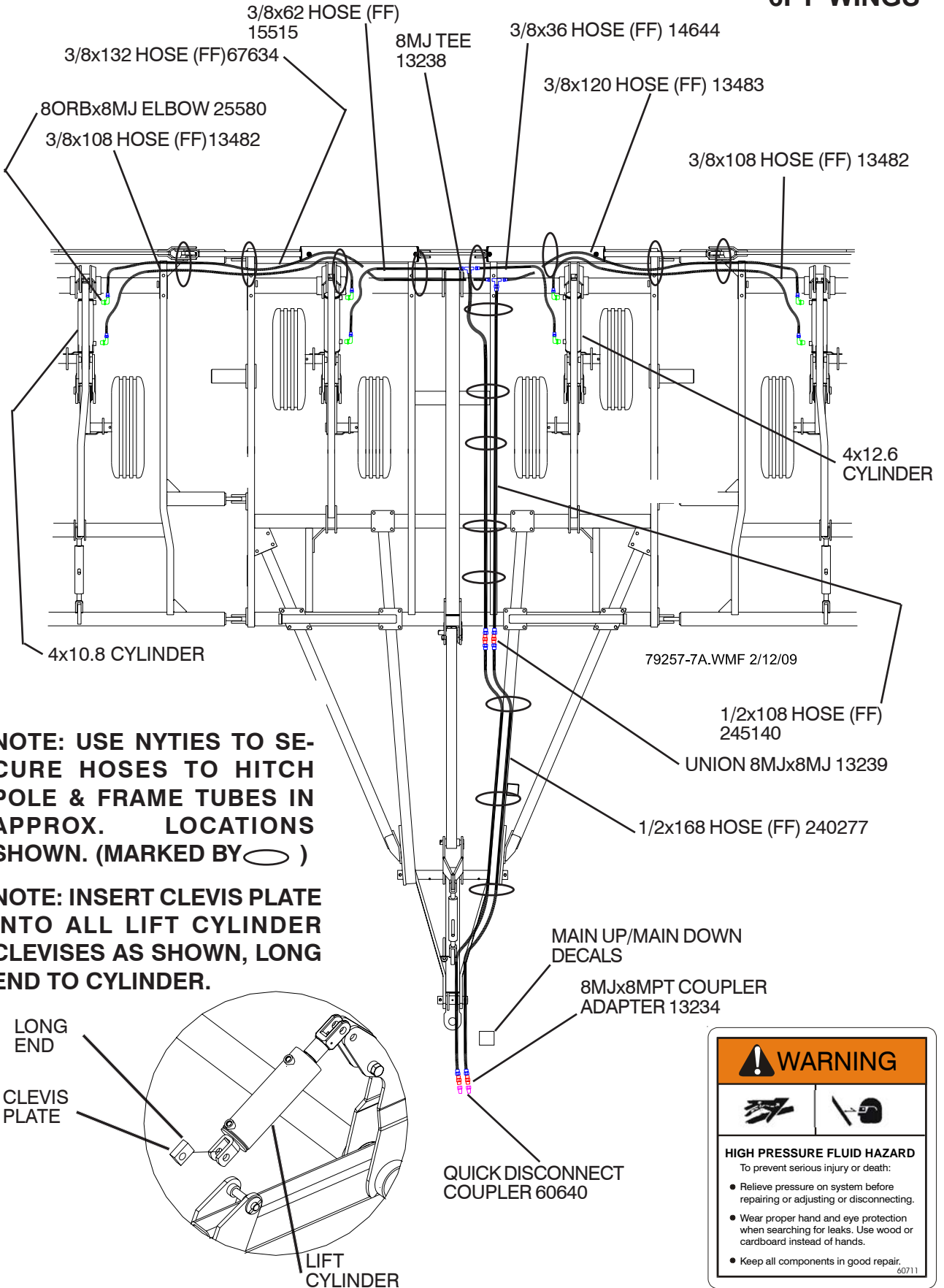

# 5830 MAIN LIFT HYDRAULICS

6FT, 9FT & 12FT WING

**CAUTION**  
 TO AVOID INJURY AND/OR EQUIPMENT DAMAGE:  
 • This cylinder has an integral restricting orifice and must be replaced with an identical cylinder.

6FT-3/8x180 HOSE (FF) 233689  
 9FT-3/8x216 HOSE (MF) 240605  
 12FT-3/8x252 HOSE (FF) 233688

6FT-3/8x108 HOSE (FF) 13482  
 9FT-3/8x156 HOSE (FF) 13484  
 12FT-3/8x180 HOSE (FF) 233689

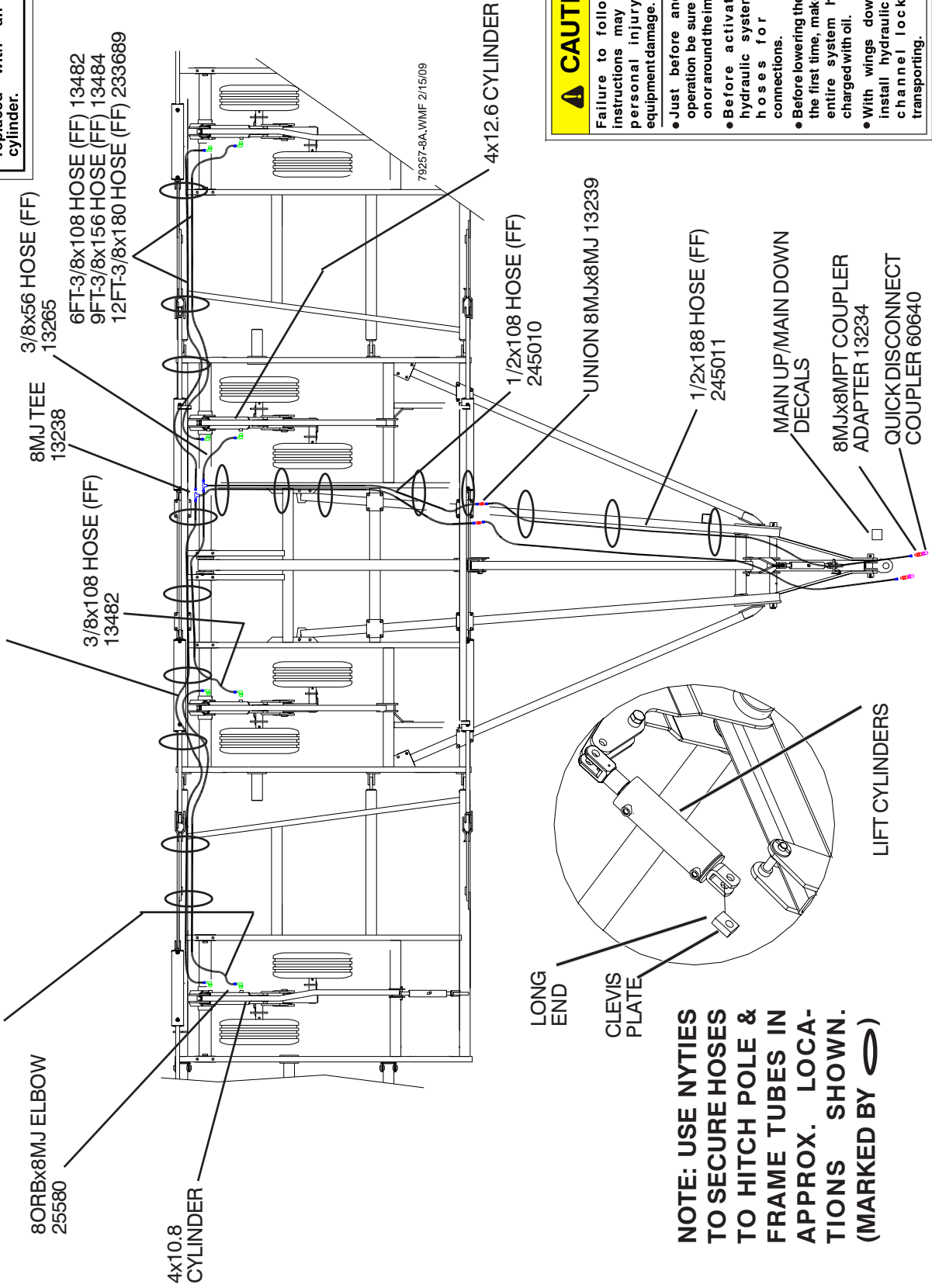

- 8ORBx8MJ ELBOW 25580
- 4x10.8 CYLINDER
- 3/8x56 HOSE (FF) 13265
- 8MJ TEE 13238
- 3/8x108 HOSE (FF) 13482
- 6FT-3/8x108 HOSE (FF) 13482
- 9FT-3/8x156 HOSE (FF) 13484
- 12FT-3/8x180 HOSE (FF) 233689
- 79257-8A.WMF 2/15/09
- 4x12.6 CYLINDER
- 1/2x108 HOSE (FF) 245010
- UNION 8MJx8MJ 13239
- 1/2x188 HOSE (FF) 245011
- MAIN UP/MAIN DOWN DECALS
- 8MJx8MPT COUPLER ADAPTER 13234
- QUICK DISCONNECT COUPLER 60640
- LONG END
- CLEVIS PLATE
- LIFT CYLINDERS

**CAUTION**  
 Failure to follow these instructions may result in personal injury and/or equipment damage.  
 • Just before and during operation be sure no one is on or around the implement.  
 • Before activating the hydraulic system, check hoses for proper connections.  
 • Before lowering the wings for the first time, make sure the entire system has been charged with oil.  
 • With wings down always install hydraulic cylinder channel lock(s) for transporting.

**NOTE: USE NYTIES TO SECURE HOSES TO HITCH POLE & FRAME TUBES IN APPROX. LOCATIONS SHOWN. (MARKED BY ○)**

## Shank Mounting

1. Position the shanks under a properly supported frame in the locations noted in the shank placement diagrams.
2. Proper mounting specifies that the bolts be assembled through the bottom of the shank bracket as shown on pages 23 and 25.
3. The front bolts on the 1000# shank (page 23) will require that the bolts be positioned in the bracket holes and tapped up into position.
4. Support the shank in position under the frame tube and place top shank plate over the bolts, loosely secure with nuts provided as shown.
5. To allow for proper tripping, the shanks must clear any frame members. Adjust the shank's lateral position as required.
6. Once all shanks have been properly placed, tighten all mounting hardware to the torque settings noted on page 3

## SHANK ASSEMBLY

### SHANK PLACEMENTS 12" SPACING

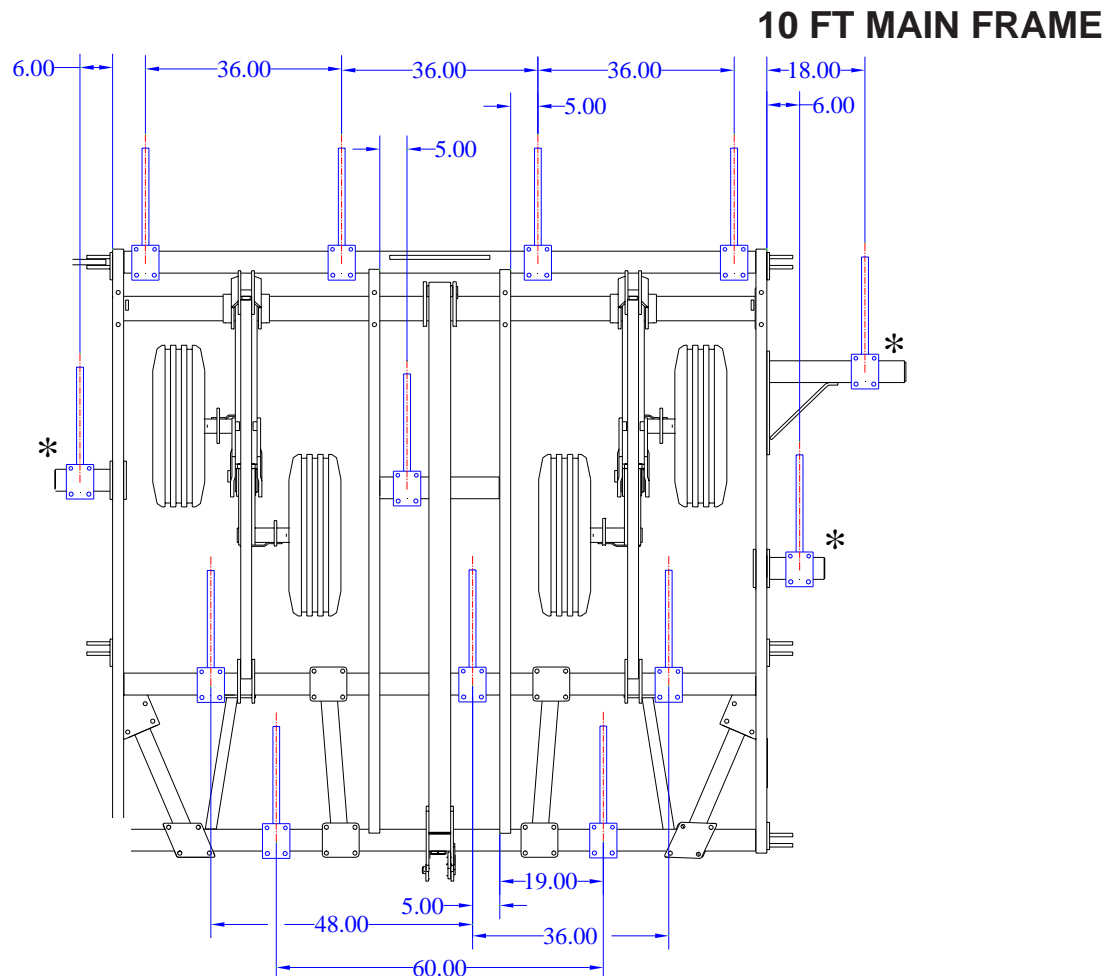

**\*-Stubs indicated are additions to main frame.**

# SHANK PLACEMENT 12IN SPACING

## 13 FT MAIN FRAME

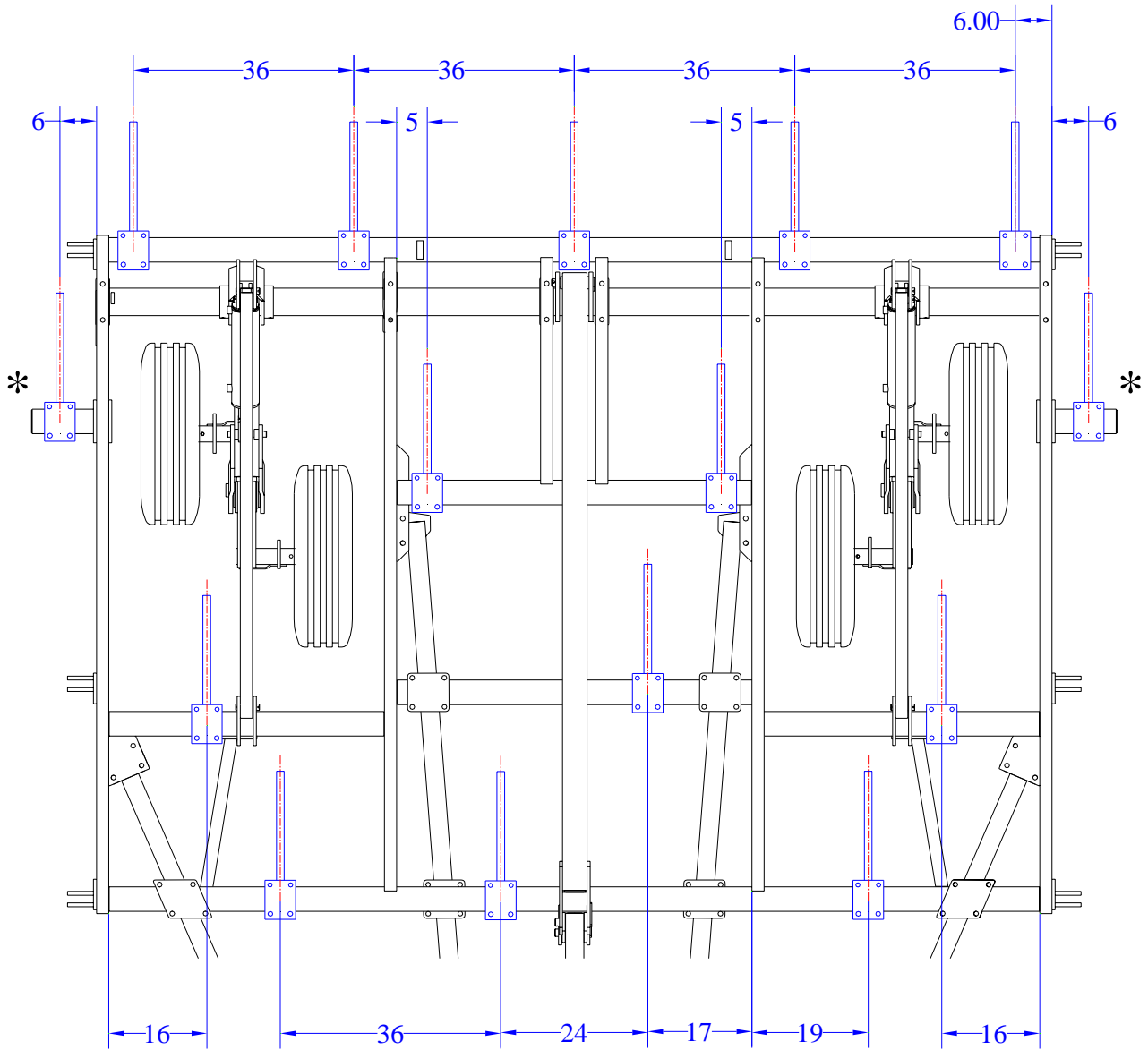

**\*-Stubs indicated are additions to main frame.**

**LOCATIONS INDICATE CORRECT SHANK MOUNTING POSITIONS ONLY. ACTUAL CLAMPING CONFIGURATION IS DEPENDENT ON TYPE OF SHANK.**

# SHANK PLACEMENT 12IN SPACING

**4FT WING  
(USED ON 10FT  
MAIN FRAME ONLY)**

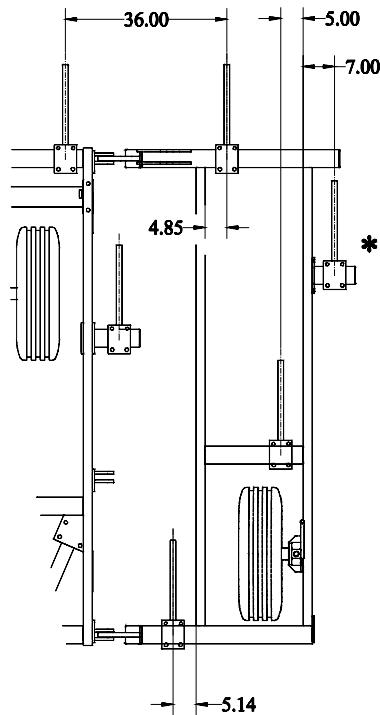

**6FT WING**

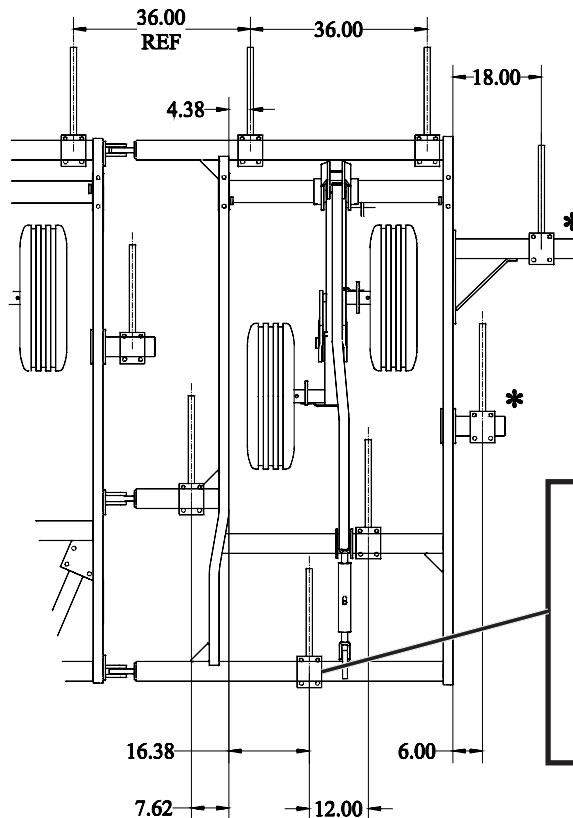

**LOCATIONS INDICATE CORRECT SHANK MOUNTING POSITIONS ONLY. ACTUAL CLAMPING CONFIGURATION IS DEPENDENT ON TYPE OF SHANK.**

**Position Note:**  
Initially position shank where noted. Check to ensure the shank will clear the adjustment screw when tripping. Move shank laterally as required.

\* -Stubs indicated are additions to main frame or wings.

# SHANK PLACEMENT 12IN SPACING

## 9FT WING

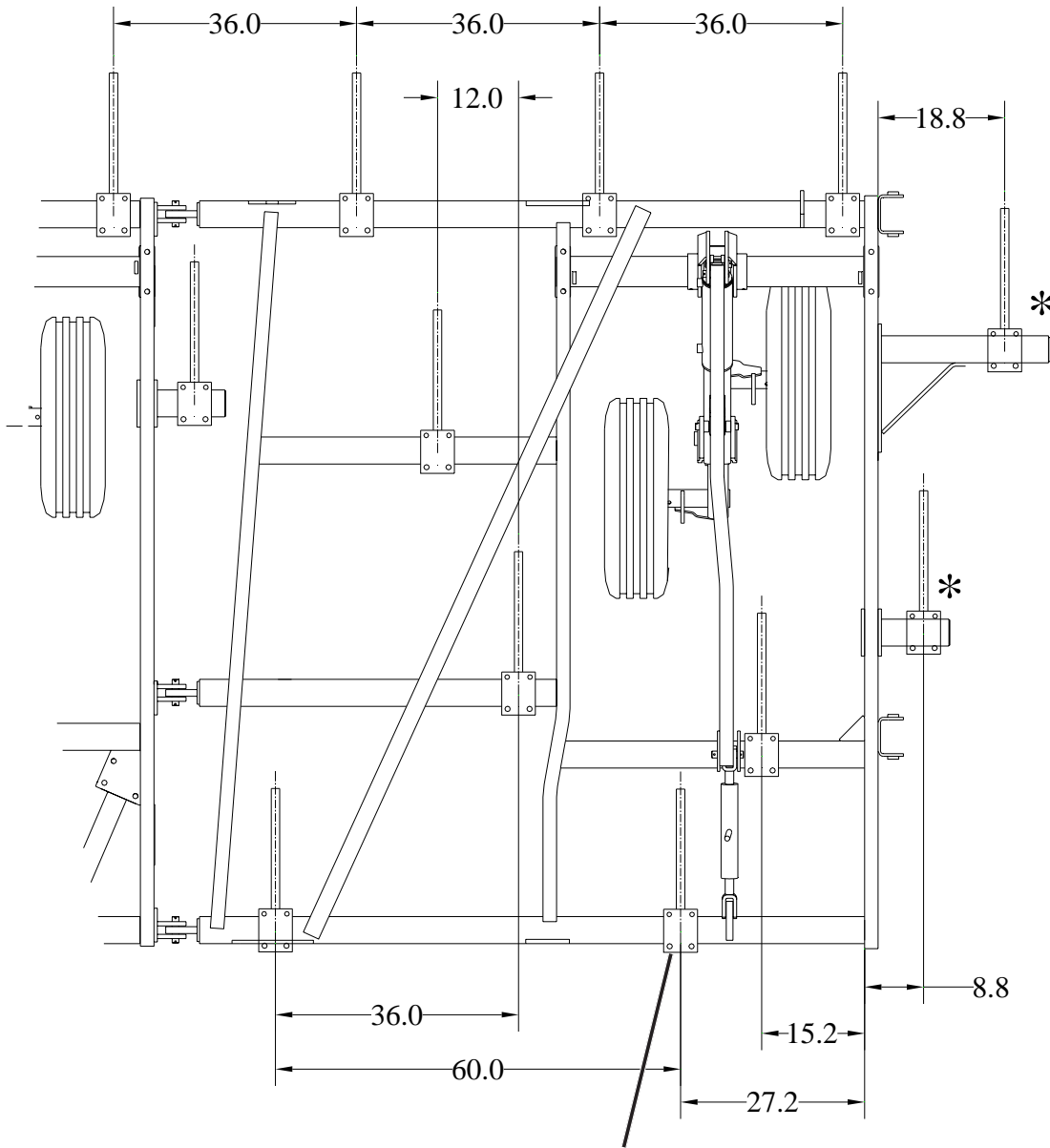

\* - Stubs indicated are additions to main frame or wings.

### Position Note:

Initially position shank where noted. Check to ensure the shank will clear the adjustment screw when tripping. Move shank laterally as required.

LOCATIONS INDICATE CORRECT SHANK MOUNTING POSITIONS ONLY. ACTUAL CLAMPING CONFIGURATION IS DEPENDENT ON TYPE OF SHANK.

# SHANK PLACEMENT 12IN SPACING

12FT WING

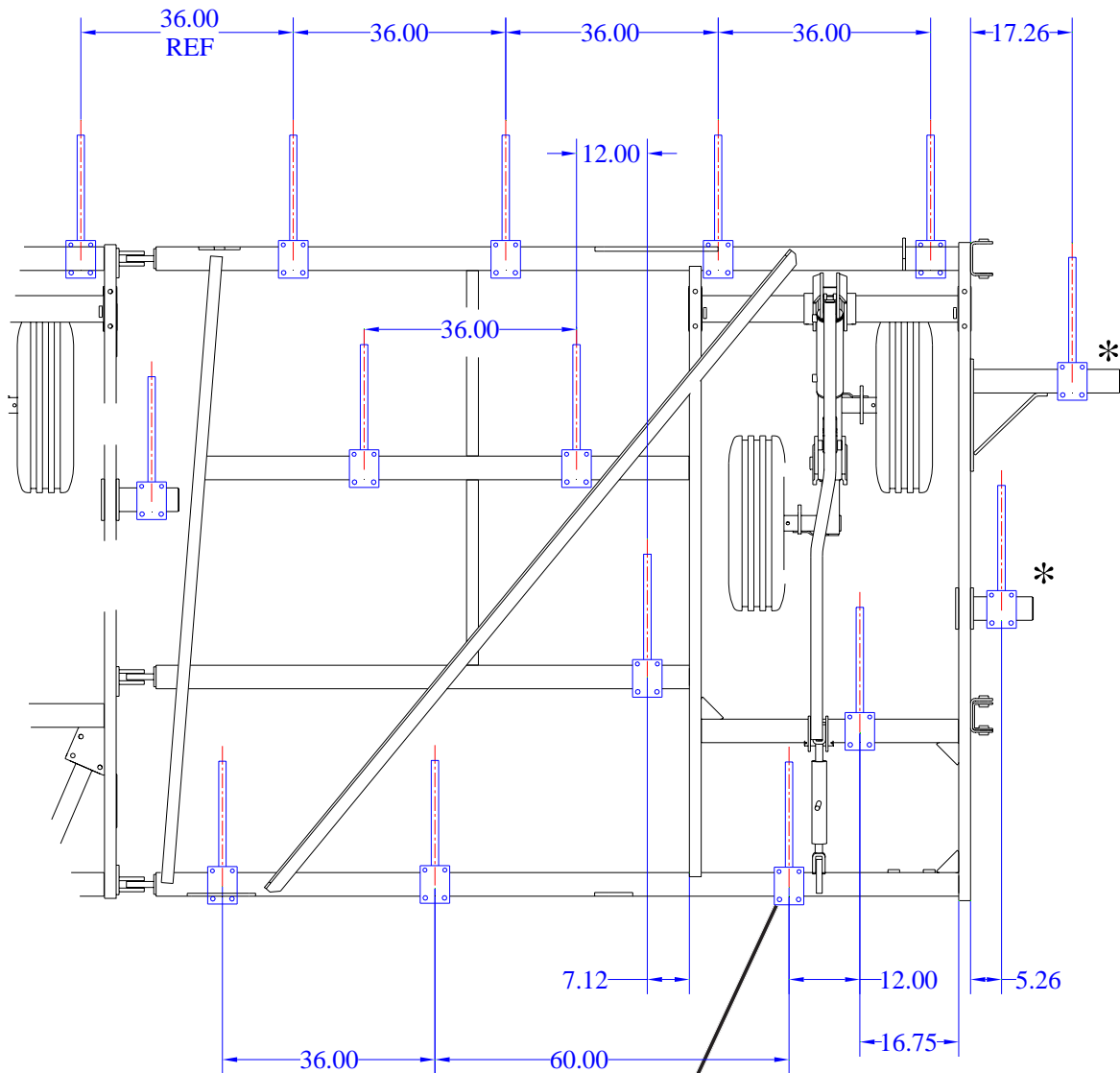

\* - Stubs indicated are additions to main frame or wings.

### Position Note:

Initially position shank where noted. Check to ensure the shank will clear the adjustment screw when tripping. Move shank laterally as required.

LOCATIONS INDICATE CORRECT SHANK MOUNTING POSITIONS ONLY. ACTUAL CLAMPING CONFIGURATION IS DEPENDENT ON TYPE OF SHANK.

# SHANK PLACEMENT 12IN SPACING

## 3FT OUTER WING

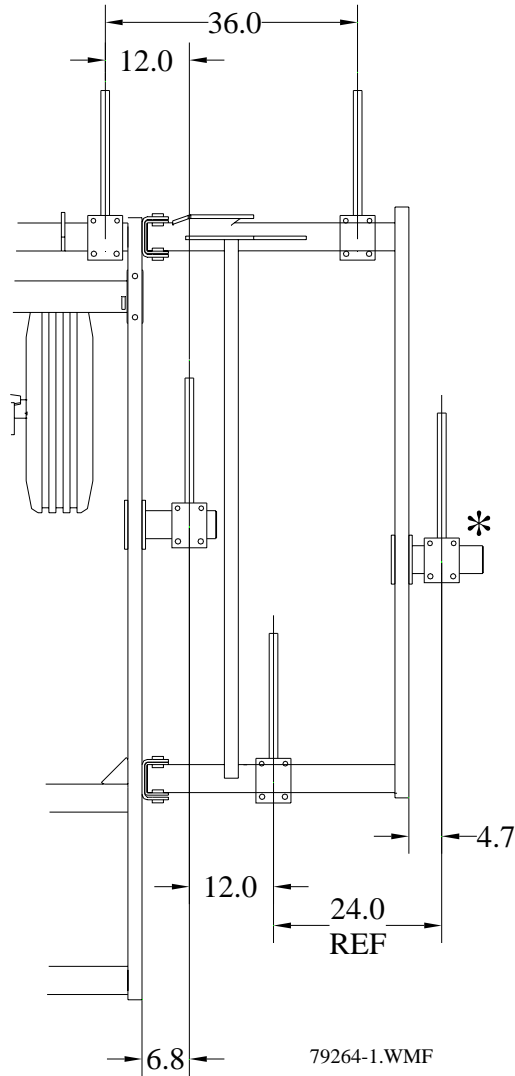

\* - Stubs indicated are additions to main frame.

LOCATIONS INDICATE CORRECT SHANK MOUNTING POSITIONS ONLY. ACTUAL CLAMPING CONFIGURATION IS DEPENDENT ON TYPE OF SHANK.



# SHANK PLACEMENT 15IN SPACING

13 FT MAIN FRAME

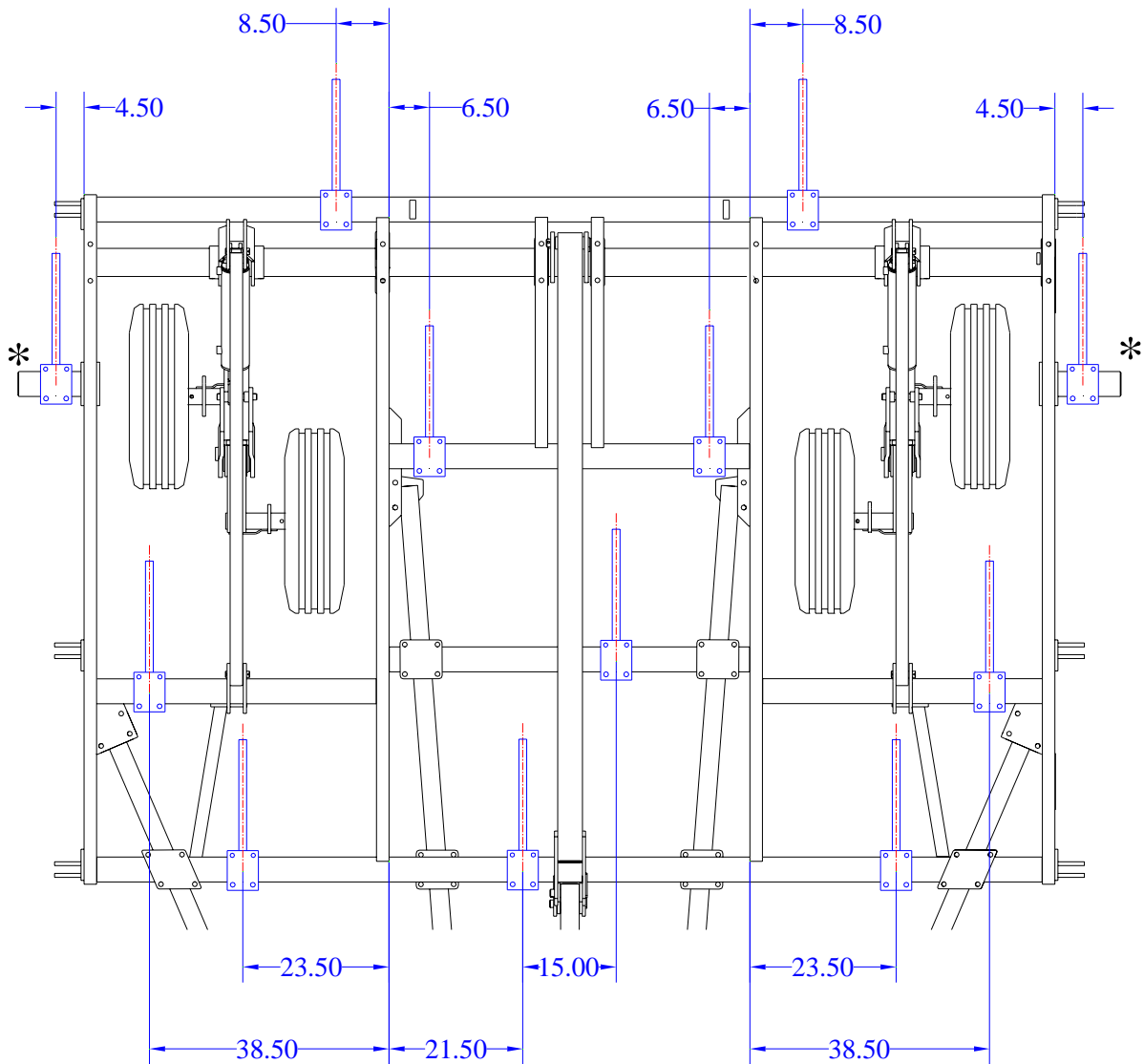

\* - Stubs indicated are additions to main frame.

LOCATIONS INDICATE CORRECT SHANK MOUNTING POSITIONS ONLY. ACTUAL CLAMPING CONFIGURATION IS DEPENDENT ON TYPE OF SHANK.

# SHANK PLACEMENT 15IN SPACING

6FT WING

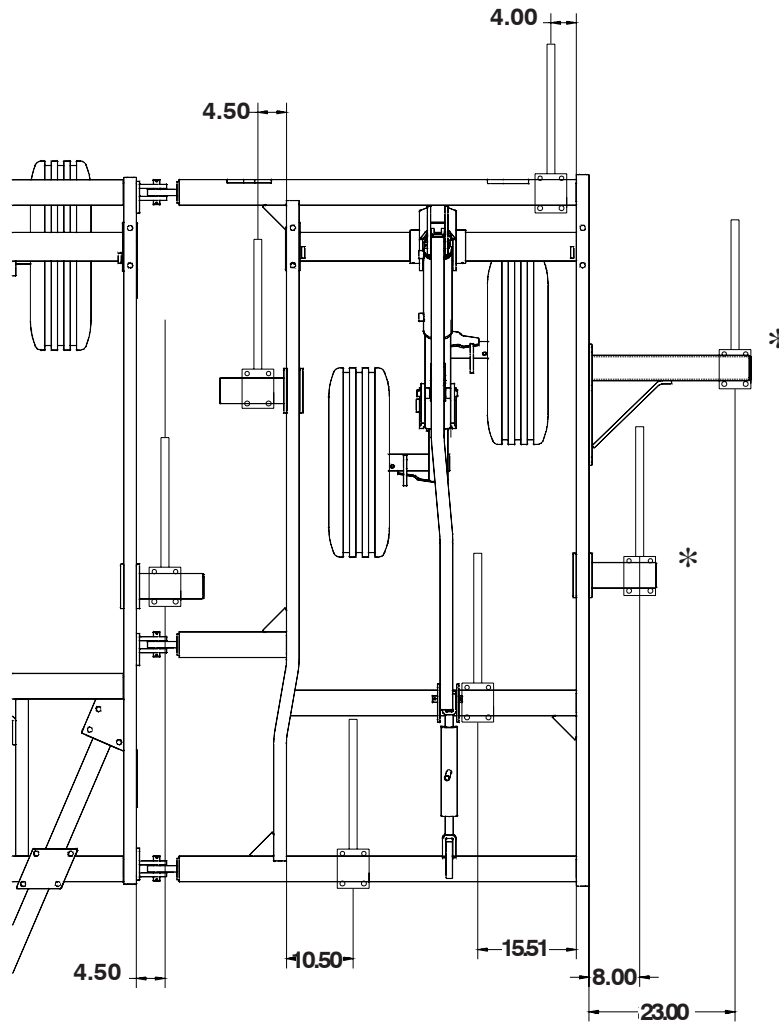

\* - Stubs indicated are additions to main frame or wings.

LOCATIONS INDICATE CORRECT SHANK MOUNTING POSITIONS ONLY. ACTUAL CLAMPING CONFIGURATION IS DEPENDENT ON TYPE OF SHANK.

# SHANK PLACEMENT 15IN SPACING

9FT WING

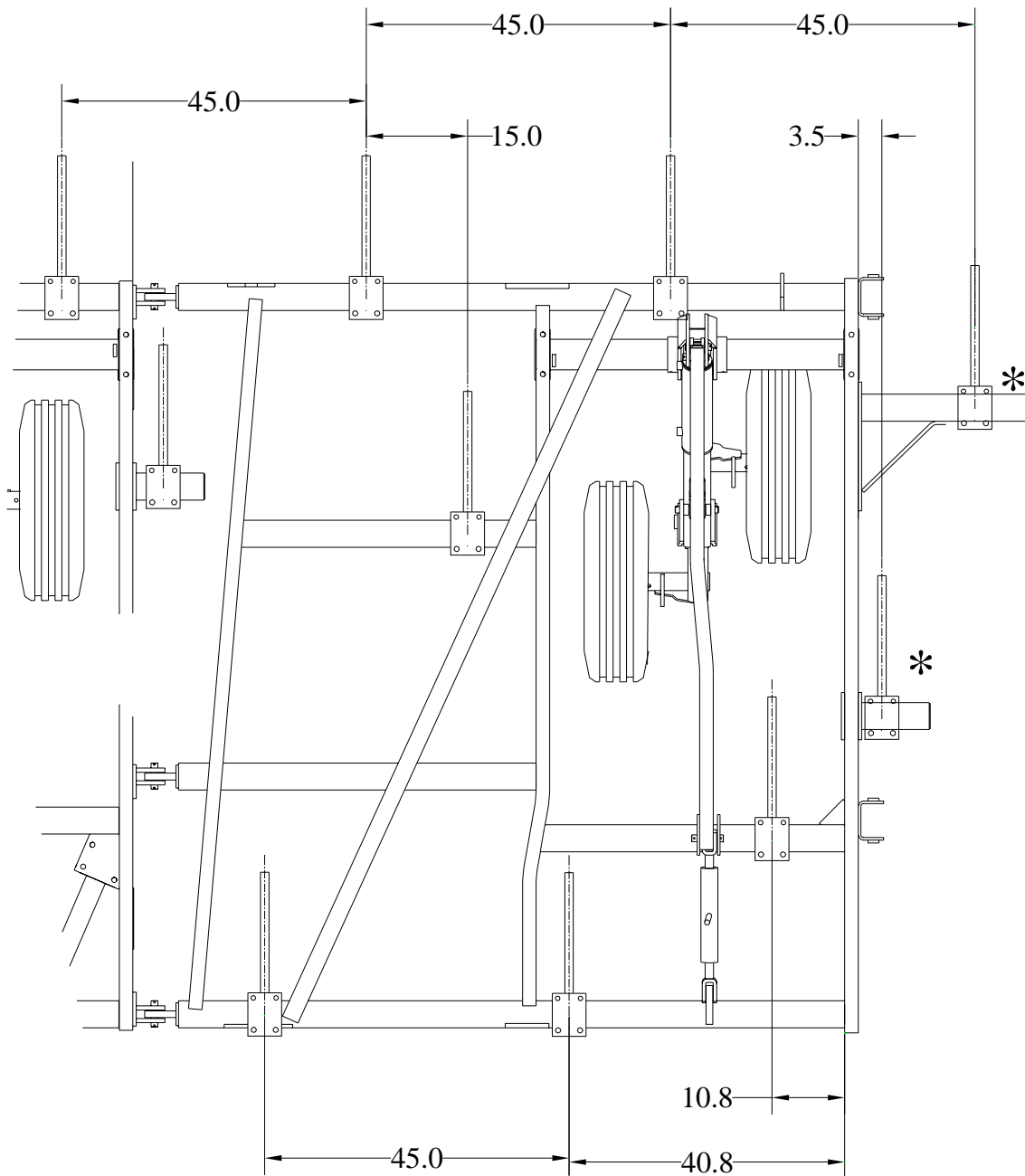

\* - Stubs indicated are additions to main frame or wings.

LOCATIONS INDICATE CORRECT SHANK MOUNTING POSITIONS ONLY. ACTUAL CLAMPING CONFIGURATION IS DEPENDENT ON TYPE OF SHANK.

# SHANK PLACEMENT 15IN SPACING

## 12FT WING

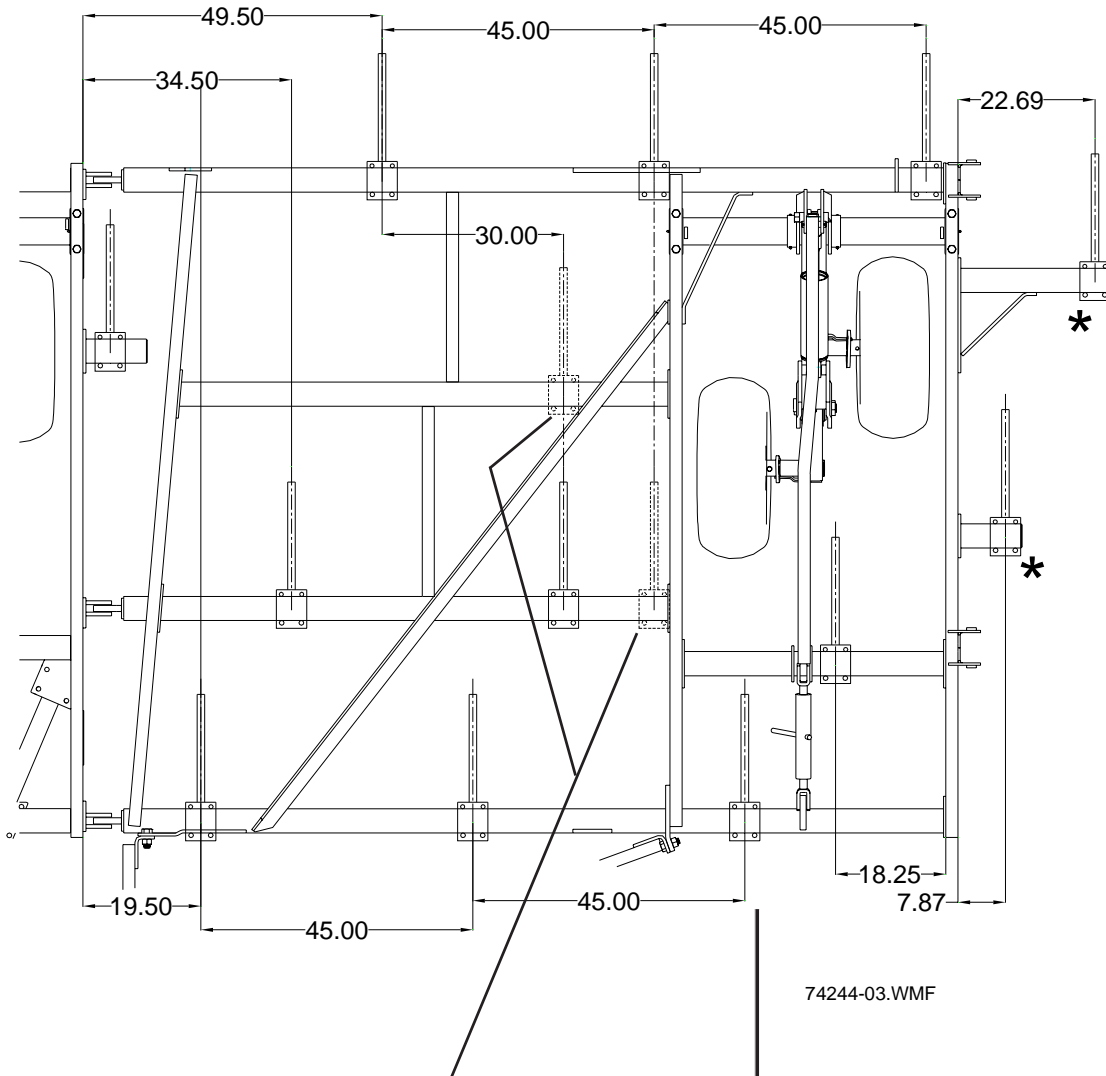

ALTERNATE SHANK LOCATION

**\* - Stubs indicated are additions to main frame or wings.**

### Position Note:

Initially position shank where noted. Check to ensure the shank will clear the adjustment screw when tripping. Move shank laterally as required.

**LOCATIONS INDICATE CORRECT SHANK MOUNTING POSITIONS ONLY. ACTUAL CLAMPING CONFIGURATION IS DEPENDENT ON TYPE OF SHANK.**

# SHANK PLACEMENT 15IN SPACING

## 3FT OUTER WING on 9FT INNER WING

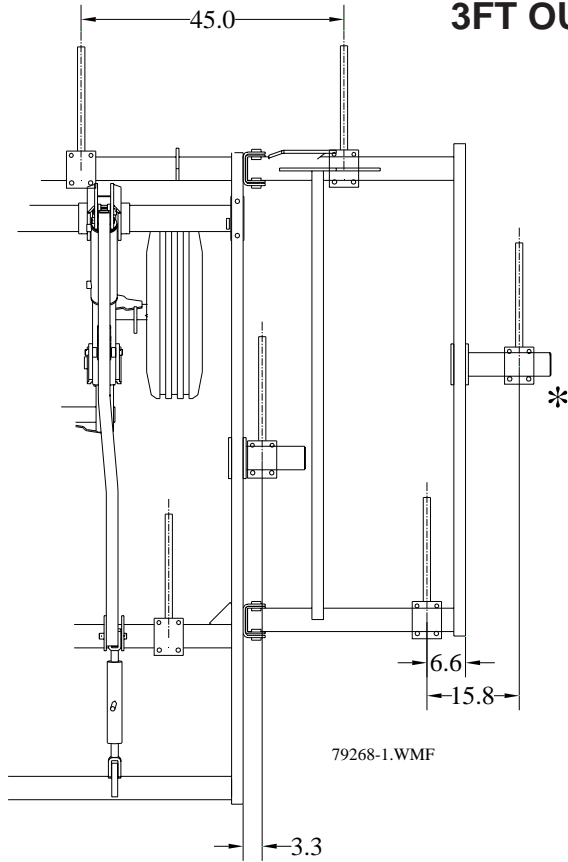

## 3FT OUTER WING on 12FT INNER WING

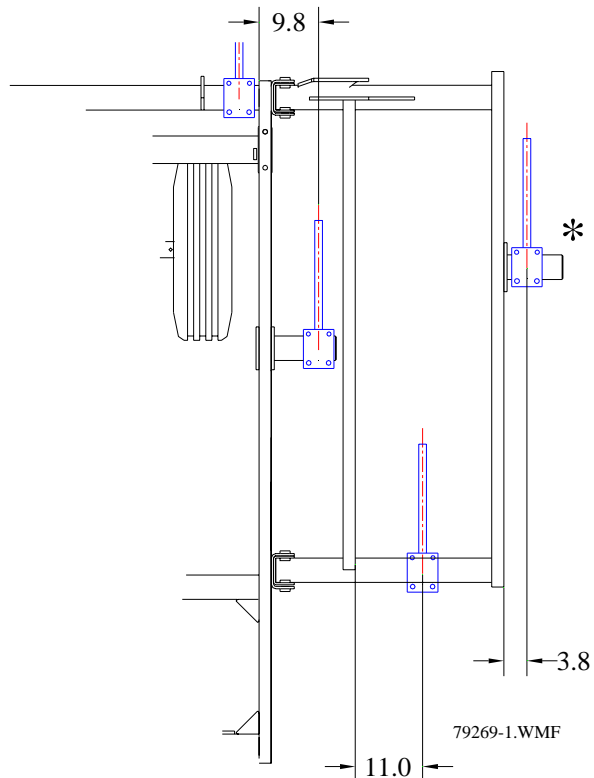

**\* - Stubs indicated are additions to main frame or wings.**

# SAFETY

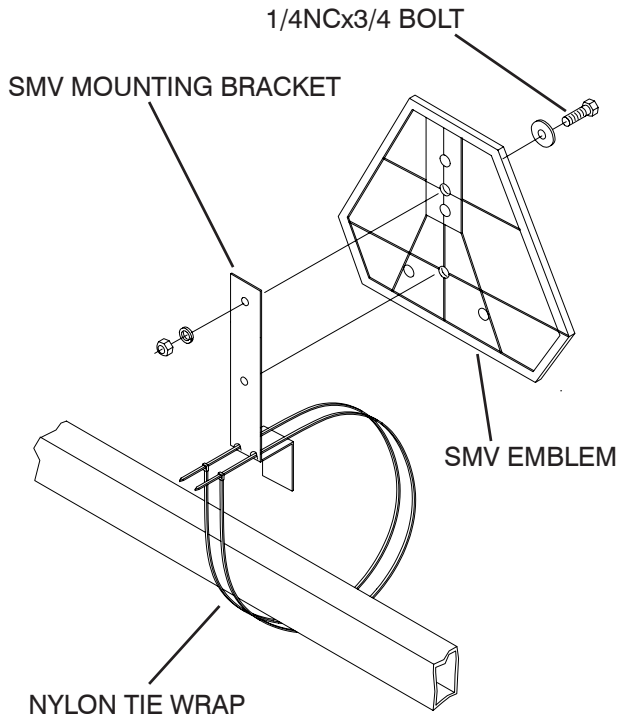

CI-77643

The bracket provided is designed to mount to numerous frame sizes and can be orientated in different positions to avoid interference with implement components.

The SMV emblem is to be secured as near to the rear and centered, or as near to the left of center of implement as practical.

Emblem is to be 2 to 6 feet above the ground measured from the lower edge of the emblem.

## SAFETY LIGHTS

See mounting instructions provided with light package for placement of safety lights.

Keep safety decals clean. Replace any safety decals that are damaged, destroyed, missing, painted over or can no longer be read. Replacement safety decals are available through your dealer.

The purpose of the safety chain is to provide an auxiliary attaching system to retain the connection between towing and towed machine in the event of separation of the primary attaching system.

The safety chain should be hooked long enough to permit full turns. Unnecessary slack should be taken up.

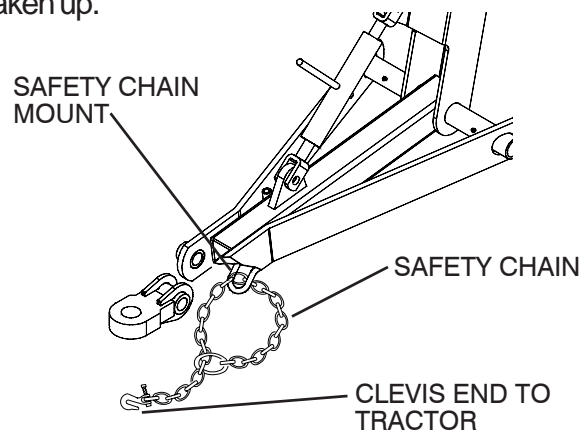

Intermediate support is to be used if there is more than 6" of unsupported chain on either side of the primary attaching point.

The intermediate support should not be mounted more than 6" from the primary attaching point. (See figure below)

The intermediate support is available from your Wil-Rich dealer.

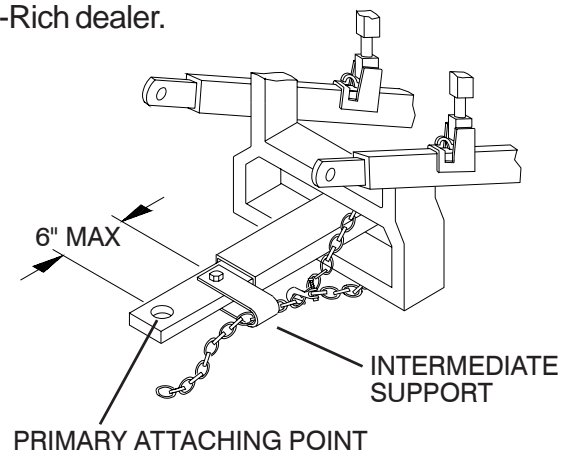

CI-77825